

রাজ্য নগর উন্নয়ন সংস্থা

STATE URBAN DEVELOPMENT AGENCY

“ইলগাস ভবন”, এইচ-সি ব্লক, সেক্টর-৩, বিধাননগর, কলকাতা-৭০০ ১০৬, পশ্চিমবঙ্গ
 “ILGUS BHAVAN”, H-C Block, Sector - III, Bidhannagar, Kolkata - 700 106, West Bengal

ক্রমিক নং SUDA - ২২/২০১৫/৩৬১৫

তারিখ ২৪.০৫.২০১৭

From: Finance Officer, SUDA

To: District Magistrate, Purulia

MEMORANDUM

Sub: Release of fund to to District Magistrate, Purulia for construction of Individual Household Latrine (IHHL) for Jhalda Municipality under Mission Nirmal Bangla (U)/ Swachh Bharat Mission (U)

Sir,

In response of Jhalda Municipality Vide letter no. 762/JM Dated 07.02.2019 an amount of Rs. 8789000 has been released in favour of District Magistrate, Purulia for construction of 1100 nos of Individual Household Latrine (IHHL) of jhalda Municipality under Mission Nirmal Bangla (U)/ Swachh Bharat Mission (U).

The detail of fund released is placed below:

Sl No.	ULB Name	Targeted no of IHHL Units	Central Share (@ Rs.4000/-)	Matching State share(@ Rs.1333/-)	Additional State share(@ Rs.2657/-)	Total fund released
1	Jhalda Municipality	1100	4400000	1466300	2922700	8789000
Total			4400000	1466300	2922700	8789000

The amount has been released to the A/C no: - 11377306960 of State Bank of India of Purulia Branch in the name of Purulia Zilla Parishad on the date 15.03.2019.

 Finance Officer, SUDA.

The release of fund is also subject to the following conditions:

- 1) The fund should be utilized only for the purpose for which it is released and for no other purpose.
- 2) Works for the released amount should be executed strictly as per scheme Guidelines.
- 3) Monthly report of Physical and Financial progress should be sent to SUDA and MED by the 7th of the following month.
- 4) The amount released herein should be kept in the dedicated Bank Account for SBM maintained by the ULBs.
- 5) A subsidiary Cash Book should be maintained for keeping accounts (deposits and withdrawals) of funds.
- 6) Money receipt in Form 42 may be sent immediately after receipt of the online transfer.
- 7) Appropriate amounts should be sub allotted to the concerned ULBs.



Finance Officer, SUDA.

SUDA-22/2015/3645/1(3)

24.05.2019

Copy Forwarded for kind information of:

1. PA to Principal Secretary, UD & MA Dept, Govt. of West Bengal.
2. Chief Engineer, M.E. Directorate.
3. Cashier, SUDA.



Finance Officer, SUDA.



রাজ্য নগর উন্নয়ন সংস্থা



STATE URBAN DEVELOPMENT AGENCY

“ইলগাস ভবন”, এইচ-সি ব্লক, সেক্টর-৩, বিধাননগর, কলকাতা-৭০০ ১০৬, পশ্চিমবঙ্গ
“ILGUS BHAVAN”, H-C Block, Sector - III, Bidhannagar, Kolkata - 700 106, West Bengal

ক্রমিক নং SUDA-22/2015/3052

তারিখ 15.03.2019

From : Finance Officer, SUDA

To : The Branch Manager,
Axis Bank Ltd.,
Salt Lake, Sector-II Branch,
BJ-110, Sector-II,
Salt Lake City, Kolkata - 700 091.

**Sub : Electronic Transfer of Fund debiting this office
Current Account No.916010072244925.**

Swachh Bharat Mission (SBM)

Sir,

You are requested to kindly arrange for electronic transfer of funds as per details given below debiting the amount from this office Savings Account No.916010072244925 lying with your branch in respect of Swachh Bharat Mission (SBM).

Sl.	Name of Payee	Amount in Rs.	Bank Details
01.	Purulia Zilla Parishad	87,89,000.00	State Bank of India, Purulia Branch, A/C No.11377306960 IFS Code.SBIN0000160
(Rupees Eighty Seven Lakh Eighty Nine Thousand only)			

(Md Asif Sardar)
Finance Officer
SUDA

(Petrus Anuranjan Soreng)
Finance Officer
SUDA



দূরভাষ : ২৩৫৮ ৬৪০৩ / ৫৭৬৭, ফ্যাক্স : ২৩৫৮ ৫৮০০

Tel : 2358 6403/5767, Fax : 2358 5800, E-mail : wbsudadir@gmail.com
Account Section : 2358 6408

OFFICE OF THE COUNCILLORS, JHALDA MUNICIPALITY

● ঝালদা পৌরসভার কাউন্সিলারগণের কার্যালয়

P.O. – Jhalda, Dist – Purulia

☎ 03254 - 255219

Memo No 752 /J.M.

Date: 07 / 02 / 2019

State Urban Development Agency
ILGUS BHABAN,
Salt Lake City,
H.C. Block, Sector-III
Bidhannagar
Kolkata - 700106

Sub-: Request for released fund of Sanitary & insanitary Latrine under Swachha Bharat Mission.

Sir,

I would like to caption your kind notice above noted subject that, this Municipality is not yet able to start the Sanitary & insanitary Latrine Project under S.B.M due to not allotted fund. I would like to request your kind good self for releasing the fund of the said Mission to start the work smoothly.

It is also mentioned that, the numbers of Beneficiaries are as follows.

S.L. No	Nos of Beneficiaries (From survey 2015)	Nos of Beneficiaries deducted for already benefited.(HFA,HUF,IHSDP)	Balance nos of Beneficiaries. (Required)
1	1899	799 (Approx)	1100

The 1899 nos of Beneficiaries found for the Project during the survey of 2015 & 799 (approx) nos of Beneficiaries already benefited from H.F.A, HUF & IHSDP Scheme. So, balance 1100 nos of Beneficiaries have required the said facility from the project.

Therefore, please release the fund for the 1100 nos of beneficiaries to start the project smoothly.

Thanking you

Yours faithfully

Vice Chairman
Jhalda Municipality
Vice Chairman
Jhalda Municipality

COMPREHENSIVE HOUSE TO HOUSE SURVEY FOR IDENTIFICATION OF INSANITARY LATRINE/NO LATRINE FACILITY

REPORT- II [ENUMERATION PHASE]

(To be submitted by the Nodal Officer through email-id to SUDA ie. cp.suda@yahoo.co.in by 06/02/2015)

Name of the Urban Local Body : Jhalda Municipality

1. The enumerator(s) has / have received required number of three types of Survey Forms ie, Form A, Form B & Form C: <write Yes or No>. Yes
2. The enumerator(s) has / have visited each and every Households to collect desired information as per their Area/Para assigned for survey : <write Yes or No>. Yes
3. The ULB has received any information/list from local NGO(s) about details of Insanitary latrines(s)/No Latrine Facility : <write Yes or No> No
4. Enumerator(s) has/have visited the house(s) of such list of Insanitary Latrines(s) /No Latrine Facility as in 3 above: <write Yes or No> Yes
5. Supervisor(s) has/have been given the enumerated survey form, as per the prescribed norm, for sample check of at least 10% of enumerated Households through field visit : <write Yes or No> Yes
6. Supervisor(s) has/have visited all the sample house(s) of the filled-in survey forms, for data verification: Yes
<write Yes or No>
7. The Nodal Officer ensures that data from all filled up and checked survey forms have been found without error:
Yes
<write Yes or No>

8a) Survey Information Sheet for all Enumerators :

Sl	Ward No.	Name of the Enumerator	Total Number of Households Visited	Total Number of Households having Insanitary Latrine identified	Total Number of Households with No Latrine Facility have been identified
1	1	Dhananjoy Roy & Lilabati Goswami	199	7	19
2	2	Gopal Das & Badal Kumari	414	8	163
3	3	Sunita Lahiri & Jhuma Chatterjee	466	8	222
4	4	Bapi Dutta & Mithu Lahiri	318	16	49
5	5	Santosh Sharma & Bina Mondal Choudhury	310	7	130
6	6	Rajesh Jha & Maya Goswami	377	01	221

455

7	Robin Chatterjee & Sunita Sonar	574	17	434
8	Bablu Chakraborty & Rita Dutta	414	10	192
9	Chitta Ranjan Chandra & Suchitra Chatterjee	266	07	59
10	Raja Sen & Moni Baisnab	287	06	175
11	Madhusudan Das & Bina Kuiry	317	07	204
12	Biswajit Gupta & Anjali Das	300	00	120
	TOTAL	4242	94	1988

(Add more lines if, required)

8b) Survey Information Sheet for all Supervisors :

Sl	Name of the Supervisor	Total Number of Households visited by Enumerators	Total Number of Households checked by Supervisor	Total Number of Households having Insanitary Latrine identified after checking by Supervisor	Total Number of Households with No Latrine Facility have been identified after checking by Supervisor
1	Pradip Goswami	1079	122	7	12
2	Tapan Mahato	1675	183	6	22
3	Abhijit Ghosh	1488	157	5	70
	TOTAL	4242	462	18	104

(Add more lines if, required)

8c) Survey Information Sheet for pasting on Ward Packet as a Label

WARD WISE SUMMARY SHEET

- a) ULB Name : Jhalda Municipality
- b) No. of Total Household Survey Forms : 2512
- c) No. of Total Household Survey Forms having Insanitary Latrine: 94
- d) No. of Total Survey Forms with No Latrine Facility : 1988

Sl	Ward No.	No. of Household Survey Forms	No. of Household Survey Forms having Insanitary Latrine	No. of Household Survey Forms with No Latrine Facility
1	1	20	07	19
2	2	42	08	163
3	3	47	08	222
4	4	33	16	49

454

5	31	07	130
6	39	01	221
7	58	17	434
8	42	10	192
9	27	07	59
10	29	06	175
11	32	07	204
12	30	00	120
Total	430	94	1988

(Add more lines if, required)

Seelam Jorand
23/2/15

Signatures of Nodal Officer

With Seal and Date

S. A. Wood

Signature of the Mayor/Chairman

With Seal and Date *J. K. ...*

The Nodal Officer shall send completely filled in Report for "Enumeration Phase" of entire survey process to SUDA without fail, on 06/02/2015 by Fax -(033-2358-5800) or through email (scanned copy) ie. cp.suda@yahoo.co.in



453

12

Government of West Bengal
Office of the District Magistrate, Purulia
Municipal Affairs (DUDA)

Memo No 81 /MA

Dated 14/11 /2018

To
The Director,
SUDA,
ILGUS Bhawan, Sector-III,
Kolkata-700106

CM BM
ADP

Sir,

I am forwarding here with a Proposal submitted by the Chairman, Jhalda Municipality under his memo no.197/JM dated 31/10/2018 which is speak for itself.

I, therefore, request you to kindly sanction necessary fund in for construction of 1988 nos. of Individual Household Latrine in favour of Jhalda Municipality under Mission Nirmal Bangla.

Encl: As stated above.

Yours faithfully,

14.11.18
Addl. District Magistrate (G)
Purulia

Memo No 81/01 /MA

Dated 14/11 /2018

Copy forwarded for information to the Chairman, Jhalda Municipality for information.

14.11.18
Addl. District Magistrate (G)
Purulia

OFFICE OF THE COUNCILLORS, JHALDA MUNICIPALITY

ঝালদা পৌরসভার কাউন্সিলারগণের কার্যালয়

P.O. - Jhalda, Dist - Purulia

03254 - 255219

Memo No: 1065 / J.M.

7323
31/10/18

Date: 31/10/2018

To
The District Magistrate
Purulia

RECEIVED
31 OCT 2018

A.D.M. (DEV.) C.A. Section
DOCKET NO. - 7269
DATE - 1.11.18.

Sub: Requisition of fund for the construction of 1988 nos of Latrine required for the Rate Payers of Jhalda Municipality.

District Magistrate
Purulia

Respected Sir,

This Municipality is in the need of construction 1988 nos of Latrine for the Rate Payers of Jhalda Municipality. The cost details are as follows.

S.L No	Total no of Latrine	Cost per Latrine	Total Cost	U.L.B Share per Latrine	Total ULB Share	Beneficiary Share per Latrine	Total Beneficiary Share	Total Govt. Share
1.	1988	10990.00	2,18,48,120.00	2000.00	39,76,000.00	1000.00	19,88,000.00	1,58,84,120.00

This may be noted here that, one Public Latrine under construction by the Municipality and other Public Latrine completed and maintained by the P.W.D Department both have been uploaded in S.B.M Portal.

Therefore you are requested to take needful action to ensure release of fund at the earliest.

Thanking you

*ADM (C), may kindly like to see.
Indrani
01/11/18.*

Yours faithfully

Chairman
Jhalda Municipality

Date: 1 / 11 / 2018

V. Panigrahi 31/10/18
Vice Chairman
Jhalda Municipality

Memo No: _____ /JM

Copy forwarded to

1. The Director, State Urban Development Agency, Salt Lake City, Kolkata - 6

S/D

Chairman
Jhalda Municipality

ক্রমিক নং SUDA- 98/2018/820

তারিখ 25/07/2018

From: Finance Officer, SUDA

To: District Magistrate, Purulia

MEMORANDUM**Sub: Release of fund to District Magistrate, Purulia for construction of Individual Household Latrine (IHHL) for Purulia & Raghunathpur Municipality under Mission Nirmal Bangla (U)/Swachh Bharat Mission (U)**

Sir,

In response to your office Memo no. 18/02/MA Dated 26.02.2018 an amount of Rs. 53133500 has been released in favour of Purulia Zilla Parishad for construction of 3450 nos of Individual Household Latrine (IHHL) for Purulia Municipality and 3200 nos. of Individual Household Latrine (IHHL) for Raghunathpur Municipality under Mission Nirmal Bangla (U) / Swachh Bharat Mission (U).

Details of Fund disbursement is placed below:

ULB	Targeted No. of IHHL Units	Central Share (@ Rs. 4000/)	Matching State Share (@ Rs. 1333/-)	Additional State Share (@ Rs. 2657 /-)	Total to be Released
Purulia	3450	13800000	4598850	9166650	27565500
Raghunathpur	3200	12800000	4265600	8502400	25568000
Total	6650	26600000	8864450	17969050	53133500

The amount has been released to the A/C No: - 11377306960 of State Bank Of India of Purulia Branch in the name of Purulia Zilla Parishad on 23.07.2018.



Finance Officer, SUDA.

2-

450

9

Page-1

Abstract of Cost Estimate of Individual Household Latrine with GCI Sheet Wall, Roof & Door and Double leach pit of circular ferro-cement/ concrete rings.

Sl. No.	Description of Item	Quantity	Unit	Rate (Rs.)	Amount (Rs.)
1	1st Class Bricks	85.00	Each	8.50	722.50
2	Cement (Reputed brand with ISI mark)	3.00	Bag	370.00	1110.00
3	1/2" Stone Chips	5.00	C.ft.	43.00	215.00
1	Sand (Coarse)	15.00	C.ft.	32.00	480.00
2	Steel (using 8 mm rod) for 2 pit covers	2.50	kg	55.00	137.50
3	Jhama bats (PWD SOR-Wage for Breaking)	3.00	C.ft.	40.00	120.00
4	GCI sheet (of thickness 0.18 mm) for door of height 5'-0" (cutting piece from sheet of full height 10'-0"; 7 pieces in bundle @ Rs. 2,100/-)	1.00	Piece	475.00	475.00
5	GCI sheet (of thickness 0.25 mm) for roof & wall of height 5'-0" & width 2'-8" 9 cutting piece from sheet of height 10'-0"; 7 pieces in bundle @ Rs. 2,450/-)	3.00	Piece	535.00	1605.00
6	PVC pipe (4" dia, 2'-0" long) with 'Y' junction	1.00	Set	200.00	200.00
7	Washer, Nut-bolt, Black anneated wire (for binding GI wire 9) ferro cement rings used), Hinges, Sikols P sheet etc.	LS	LS	LS	100.00
8	Ceramic rural pan / trap with foot rest	1.00	Set	500.00	500.00
9	Double leach pit lining with circular ferro-cement/ concrete rings in each pit	1.00	Set	LS	1000.00
10	Timber batten for door and roof (local heart wood)	LS	LS	LS	500.00
11	Display Board	LS	LS	LS	100.00
12	Transportation cost of all Materials	LS	LS	LS	400.00
13	Skilled labour for Masonary work	4.00	MD	326.00	1304.00
14	Supervisor (to be engaged for every 6 IHHL's vide Memo No. 301 (20)/Comm-P & RD/P/NREGA/LUE-01/06 (part-I) dated 08.10.2013 of P & RDD, Government of West Bengal.	0.20	MD	300.00	60.00
15	Un-skilled labour for masonary work	8.00	MD	245.00	1960.00
				GRAND TOTAL = RS.	10989.00
				SAY = RS.	10989.00
(Rupees Ten Thousand Nine Hundred & Eighty Nine Only)					
N.B.- This estimate is prepared on the basis of PWD (WH) Schedule of Rates for building works (effective from 01st July, 2014) and Local justified marked rate.					

Handwritten signature and date: 07/12/15

Handwritten signature and date: 07/12/15

Small handwritten notes and numbers at the bottom left.

-3-

Encl. 9

449

(99)

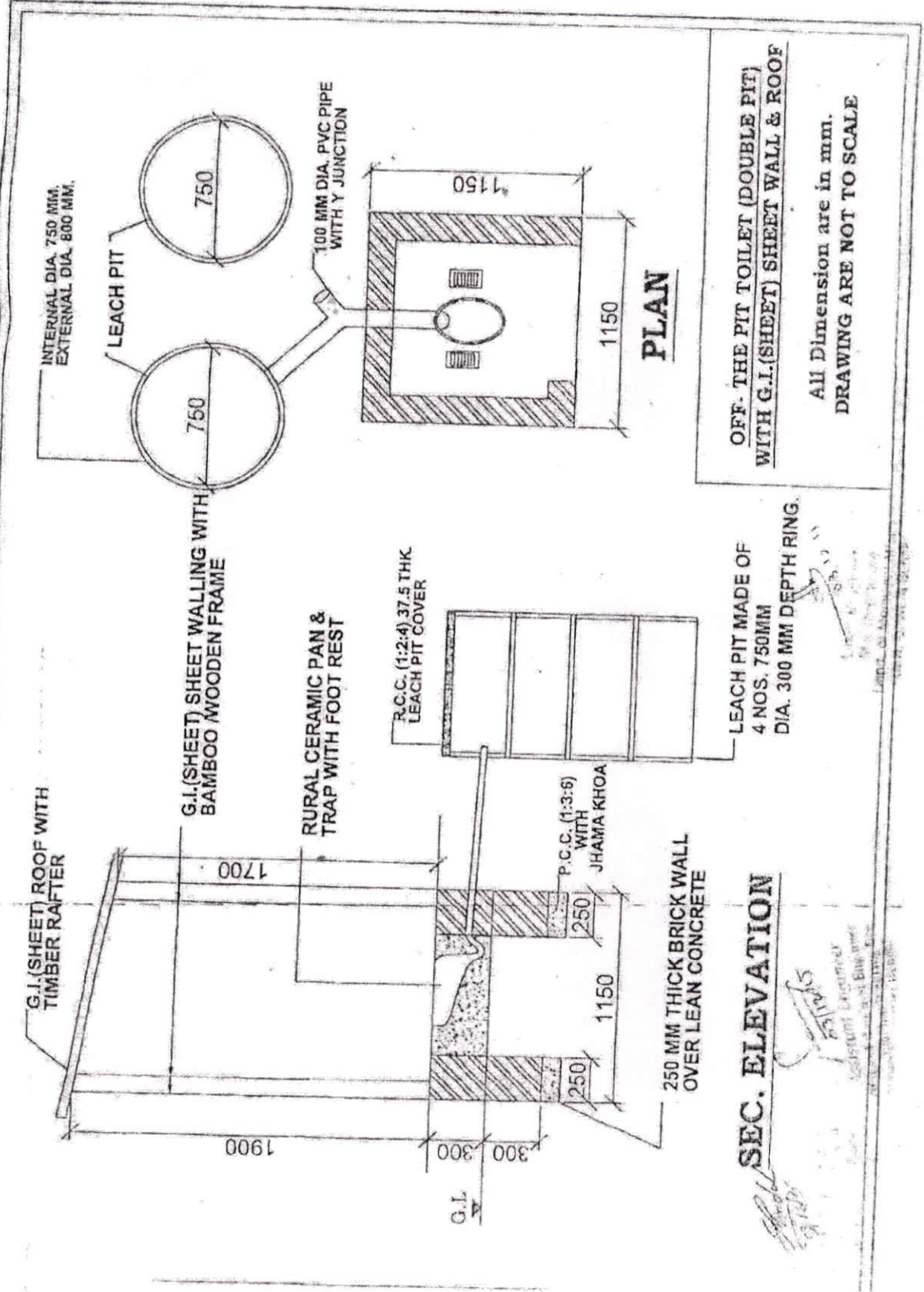

PLAN

OFF. THE PIT TOILET (DOUBLE PIT)
WITH G.I.(SHEET) SHEET WALL & ROOF

All Dimension are in mm.
DRAWING ARE NOT TO SCALE

SEC. ELEVATION

LEACH PIT MADE OF
4 NOS. 750MM
DIA. 300 MM DEPTH RING.

250 MM THICK BRICK WALL
OVER LEAN CONCRETE

P.C.C. (1:3:6)
WITH
JHAMA KHOA

R.C.C. (1:2:4) 37.5 THK
LEACH PIT COVER

RURAL CERAMIC PAN &
TRAP WITH FOOT REST

G.I.(SHEET) SHEET WALLING WITH
BAMBOO WOODEN FRAME

G.I.(SHEET) ROOF WITH
TIMBER RAFTER

250

300

300

1150

250

1700

1900

750

750

1150

1150

G.L.

748

-4-

SUDA-98/2018/820/1(4)

25.07.2018

Copy Forwarded for kind information of:

1. Pr. Secretary, UD & MA Dept, Govt. of West Bengal.
2. Sri B.N.KAR, Addl. Dir. SBM and Addl. Dir. ILGUS.
3. Chief Engineer, M.E. Directorate.
4. Cashier, SUDA.



Finance Officer, SUDA.

সুডা

রাজ্য নগর উন্নয়ন সংস্থা

SUDA

STATE URBAN DEVELOPMENT AGENCY

“ইলগাস ভবন”, এইচ-সি ব্লক, সেক্টর-৩, বিধাননগর, কলকাতা-৭০০ ১০৬, পশ্চিমবঙ্গ

“ILGUS BHAVAN”, H-C Block, Sector - III, Bidhannagar, Kolkata - 700 106, West Bengal

SUDA-98/2018/ 798

23.07.2018

ক্রমিক নং

তারিখ

From : Director, SUDA

To : The Branch Manager,
Axis Bank Ltd.,
Salt Lake, Sector-II Branch,
BJ-110, Sector-II,
Salt Lake City, Kolkata - 700 091.

Sub : Electronic Transfer of Fund debiting this office
Current Account No.916010072244925.

Swachh Bharat Mission (SBM)

Sir,

You are requested to kindly arrange for electronic transfer of funds as per details given below debiting the amount from this office Savings Account No.916010072244925 lying with your branch in respect of Swachh Bharat Mission (SBM).

Sl.	Name of Payee	Amount in Rs.	Bank Details
01.	Purulia Zilla Parishad	5,31,33,500.00	State Bank of India, Purulia Branch, A/C No.11377306960 IFS Code.SBIN0000160

(Rupees Five Crore Thirty One Lakh Thirty Three Thousand Five Hundred only)

(Md Asif Sardar)
Finance Officer
SUDA

(Sutanu Prasad Kar)
Director
SUDA



দূরভাষ : ২৩৫৮ ৬৪০৩ / ৫৭৬৭, ফ্যাক্স : ২৩৫৮ ৫৮০০

Tel : 2358 6403/5767, Fax : 2358 5800, E-mail : wbsudadir@gmail.com

Account Section : 2358 6408



রাজ্য নগর উন্নয়ন সংস্থা



SUDA

STATE URBAN DEVELOPMENT AGENCY

“ইলগাস ভবন”, এইচ-সি ব্লক, সেক্টর-৩, বিধাননগর, কলকাতা-৭০০ ১০৬, পশ্চিমবঙ্গ

“ILGUS BHAVAN”, H-C Block, Sector - III, Bidhannagar, Kolkata - 700 106, West Bengal

446

SUDA-98/2018/

23.07.2018

ক্রমিক নং

তারিখ

From : Director, SUDA

To : The Branch Manager,
Axis Bank Ltd.,
Salt Lake, Sector-II Branch,
BJ-110, Sector-II,
Salt Lake City, Kolkata - 700 091.

**Sub : Electronic Transfer of Fund debiting this office
Current Account No.916010072244925.**

Swachh Bharat Mission (SBM)

Sir,

You are requested to kindly arrange for electronic transfer of funds as per details given below debiting the amount from this office Savings Account No.916010072244925 lying with your branch in respect of Swachh Bharat Mission (SBM).

Sl.	Name of Payee	Amount in Rs.	Bank Details
01.	Purulia Zilla Parishad	5,31,33,500.00	State Bank of India, Purulia Branch, A/C No.11377306960 IFS Code.SBIN0000160

(Rupees Five Crore Thirty One Lakh Thirty Three Thousand Five Hundred only)

(Md Asif Sardar)
Finance Officer
SUDA

(Sutanu Prasad Kar)
Director
SUDA

23-07-18

দূরভাষ : ২৩৫৮ ৬৪০৩ / ৫৭৬৭, ফ্যাক্স : ২৩৫৮ ৫৮০০

Tel : 2358 6403/5767, Fax : 2358 5800, E-mail : wbsudadir@gmail.com

Account Section : 2358 6408

OFFICE OF THE PURULIA ZILLA PARISHAD
PURULIA

44

Memo No. 239 XXII(11)/Gen(2)/MNB/PZP

Date: 20/07/2018

To
The Director,
SUDA,
Kolkata.

Sub: Submission of bank account details of SBM.

Sir,

In response to your mail dtd. 20.07.2018, I am sending herewith the bank account details of SBM, Purulia for your kind information and necessary action.

Bank Name : State Bank of India
Branch : Purulia
IFSC Code : SBIN0000160
Account No. : 11377306960

Yours faithfully,

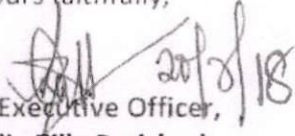
Addl. Executive Officer,
Purulia Zilla Parishad

Government of West Bengal
Office of the District Magistrate, Purulia
Municipal Affairs (DUDA)

To
S. Banerjee

344

1333

23.3.18

3

Memo No _____/MA

Dated _____/2018

To
The Director,
SUDA,
ILGUS Bhawan, Sector-III,
Kolkata-700106

Sir,

I am forwarding 2(two) Proposals submitted by the Chairman, Purulia Municipality under his memo no.PM/NUHM Dated 20/02/2018 and the Chairman, Raghunathpur Municipality under memo no.RM/CIVIL/865 Dated 16/02/2018 which are speak for itself.

I, therefore, request you to kindly sanction the necessary fund for construction of 6650(3450+3200) nos. of Individual Household Latrine and 15 nos. of Community Sanitary Complex in favour of above Municipalities for achievement the plan under Mission Nirmal Bangla.

Encl: As stated above.

Yours faithfully,

sd/2

Add. District Magistrate (G)
Purulia

Memo No 18/02 /MA

Dated 26/02 /2018

Copy forwarded for information to:

1. The Chairman, Purulia Municipality
2. The Chairman, Raghunathpur Municipality

Add. District Magistrate (G)
Purulia

443

2

পুরুলিয়া পৌরসভার কাউন্সিলারগণের কার্যালয়

OFFICE OF THE COUNCILLORS PURULIA MUNICIPALITY

দিনাঙ্ক

Date 20/02/2018

পুরুলিয়া-৭২৩১০১

পত্রাঙ্ক

Memo..... MG PM/NUHM/184

Purulia-723101

To
The District Magistrate
Purulia

SUB- Proposal for Construction of IHHL and CSE under Mission Nirmal Bangla

Respected Sir,

Under the popular scheme Mission Nirmal Bangla we have decided to thrive towards achieving open Defecation Free Municipality . As per the 2011 census we have 8359 House holds who resorts to open defecation in our municipality area and we have decided to cover these House holds through construction of Individual House Holds Latrines (IHHL) .So, for we have received 3450 application from beneficiaries with a request to provide financial support for construction of latrine.

More over in some place of slums and also in public place of municipality area there is dearth of Community Latrines. We have identified 15 such place where Community Sanitary Complex (CSC) may be constructed.

Hence we proposed to construct 3450 Individual House Holds Latrines & 15 community sanitary Complex in Municipality area.

[Signature]
Chairman
Purulia Municipality
CHAIRMAN
PURULIA MUNICIPALITY

of the Dist. Mag.
RECEIVED
20 FEB 2018
S. Chatterjee

442

(03251) 25522

1

OFFICE OF THE COUNCILLORS OF
RAGHUNATHPUR MUNICIPALITY

Email: - raghunathpur.ulb@gmail.com

Bhabesh Chatterjee
Chairman

P.O. - Raghunathpur, Dist-Purulia

Ref-RM/Civil/ 865

Date-16/02/2018

To,
The District Magistrate,
Dist- Purulia

Ref: - RM/Civil/773 dated-11/01/2018

SUB: - Request for provide 3200 Nos. Latrine to meet up the insanitary latrine problem as per local preliminary survey at various places under Raghunathpur Municipality to avoid open human extract (made by natures call).

Sir,

You aware of that Swachh Bharat Abhiyaan is running full phase in all over India along with our District. But I am sorry to say that in case of use of Latrine, people of our Municipal area are not up to the mark. People like to do their daily natures call in the open to sky. It is cause pollution, which is one of the burning problems in our Municipal area. We try to aware people to use Sanitary Latrine, but due to financial inefficiency they are not able to construct Sanitary Latrine.

In this circumstance I request you to provide 3200Nos. Latrine (As per local preliminary survey) in various places within Raghunathpur Municipality to avoid pollution and make it a Swachh Pollution free Municipality.

This is for your kind consideration and onward early action please.

Thanking You,
Yours Faithfully,

Copy to:-

1. S.D.O., Raghunathpur Sub-Division.



B. Chatterjee
16.02.18

B 16.02.18
Chairman
Raghunathpur Municipality
Chairman
Raghunathpur Municipality
Dist - Purulia

সুডা

SUDA

রাজ্য নগর উন্নয়ন সংস্থা

STATE URBAN DEVELOPMENT AGENCY

“ইলগাস ভবন”, এইচ-সি ব্লক, সেক্টর-৩, বিধাননগর, কলকাতা-৭০০ ১০৬, পশ্চিমবঙ্গ
“ILGUS BHAVAN”, H-C Block, Sector - III, Bidhannagar, Kolkata - 700 106, West Bengal

44)

ক্রমিক নং SUDA-22/2015/867

তারিখ 28.08.2018

From: Director SUDA &
State Mission Director, SBM(U)

To
The District Magistrate, North 24 Parganas &
The Executive Officer,
North 24 Parganas Zilla Parishad

Sub: Approval for Construction of Community Toilets in the ULBs of North 24 Parganas District

Madam,

Please refer to your letter No. 87/MNB (NZIP) dated 14.08.2018 for seeking approval for Construction of Community Sanitary Complex in the ULBs of North 24 Parganas with the unutilised Amount lying with you of **Rs. 53,38,37,838.17** including Interest Amount of **Rs. 2,14,71,286.17**.

As the aim of Mission Nirmal Bangla (Urban) is to cover all the households for achieving open defecation free status, you may use the balance fund of IHHL for construction of Community Toilets as per the further demand of the ULBs under North 24 Parganas District. The Financial Assistance should be within the limit of average **Rs. 98,000/-** per Toilet Seat and **Rs. 32,000/-** per Urinal Unit.

After utilizing the requisite amount for the new/additional construction of Community Toilets within the ULBs of North 24 Parganas, the rest amount shall be refunded to SUDA.

Thanking you,

Yours faithfully,

Director SUDA 28/8/18

দূরভাষ : ২৩৫৮ ৬৪০৩ / ৫৭৬৭, ফ্যাক্স : ২৩৫৮ ৫৮০০

Tel : 2358 6403/5767, Fax : 2358 5800, E-mail : wbsudadir@gmail.com

Account Section : 2358 6408

Memo No. 87 / MNB (NZP)

440

Dated 14 /08/2018

To,
The Director
State Urban Development Agency (SUDA), West Bengal
ILGUS Bhaban, Sector- III
Block – HC, Kolkata – 700106

AD (BNK)
24/8/18

Sub: Seeking Permission / Guideline for construction of
Community Sanitary Complex.

Sir,

This is to inform you that at present we have balance amount of Rs. 53,38,37,838.17 including interest (interest amount is Rs. 2,14,71,286.17) for construction of IHHL's and IEC purpose, out of the fund placed from your end for the purpose stated above.

We have achieved ODF District status on 29th September, 2016 including all Urban Local Body.

Now, some of the Urban Local Body of this district placing a request for fund for construction of Community Sanitary Complex (CSC).

You are kindly requested to provide specific guideline whether we can use the balance amount for the construction of Community Sanitary Complex (CSC). Besides, instruction regarding utilization of residual fund is also solicited.

Thanking you.

Yours faithfully,

District Magistrate
North 24 Parganas
&
Executive Officer
North 24 Parganas Zilla Parishad

Memo No. 87/1(2)/ MNB (NZP)

Dated 14 /08/2018

Copy forwarded for information to:

1. C.A to Additional District Magistrate (Dev.), North 24 Parganas - for kind information of Additional District Magistrate (Dev.), North 24 Parganas.
2. C.A to Secretary, North 24 Parganas Zilla Parishad for kind information of Secretary, North 24 Parganas Zilla Parishad.

District Magistrate
North 24 Parganas
&
Executive Officer
North 24 Parganas Zilla Parishad

STATE URBAN DEVELOPMENT AGENCY

“ইলগাস ভবন”, এইচ-সি ব্লক, সেক্টর-৩, বিধাননগর, কলকাতা-৭০০ ১০৬, পশ্চিমবঙ্গ
 “ILGUS BHAVAN”, H-C Block, Sector - III, Bidhannagar, Kolkata - 700 106, West Bengal

ক্রমিক নং SUDA- ২২/২০১৫/ ১৩০

তারিখ ২০/০৪/ ২০১৪.

From: Finance Officer, SUDA

To: District Magistrate, Uttar Dinajpur

MEMORANDUM

Sub: Release of further fund to District Magistrate, Uttar Dinajpur for construction of Public Toilet for Kaliaganj Municipality under Mission Nirmal Bangla (U)/ Swachh Bharat Mission (U)

Sir,

In response of kaliaganj Municipality Vide no. 382/Nirmal Bangla/18 Dated 08.03.2018 an amount of Rs. 20800000 has been released in favour of District Magistrate, Uttar Dinajpur District for construction of 40 nos of Public Toilet for Kaliaganj Municipality under Mission Nirmal Bangla (U)/ Swachh Bharat Mission (U).

ULB	No. of Public Toilet	Total Fund Required @ Rs. 520000/-	GOI Share @ Rs. 208000/-	State Share @ Rs. 69334/-	Additional State Share @ Rs. 242666/-
Kaliaganj	40	20800000	8320000	2773360	9706640

The remaining amount i.e. per Public Toilet Rs.12719/- will be borne by the municipality.

The amount has been released to the A/C no:- 11193903792 of State Bank Of India of Karnojora Branch in the name of District Magistrate, Uttar Dinajpur District on the date 16.04.2018.

Finance Officer, SUDA.

In this connection kindly find enclosed herewith the provisional number of IHHL units to be constructed in the Urban Local Bodies of the District ULB wise as per findings of the comprehensive house to house survey for identification of insanitary latrine/no latrine facilities. However the actual number will be as per field executions. The model plan for the latrine unit as prepared by Municipal Engineering Directorate at an estimated cost of Rs. 10,990/- has been decided to be adopted in the program. A copy of plan and estimate of the model design of the latrine is enclosed herewith. The implementation of the program may be undertaken under the overall co-ordination of the District Magistrates and the respective ULBs. The work may be executed preferably through sanitary mart or such other self-help groups (as was done in the case of Nadia) or through the ULBs or otherwise as may be decided by the respective District Administration.

It is further informed that the progress of construction of IHHL starting from applications by the beneficiaries to completion of the units are required to be uploaded in the Govt. of India's portal under SBM. The uploading may be done by CSC e-Governance Services India Ltd. (a special purpose vehicle company constituted by Dept. of Information Technology, Govt. of India and entrusted to look after the CSC scheme across the country) or by the respective ULBs.

The District Administrations will also be required to identify the households where there is no suitable space for construction of IHHL. On receiving a feedback from the Districts proposals for construction of Community Toilets in close proximity of the identified households will be prepared and submitted to the MA Dept. for reference to Finance Department for the required additional State share. Simultaneously the concerned ULBs will be required to identify suitable lands for construction of Community Toilets.

It has further been decided that the following fund sharing pattern will be adopted in implementation of the program:

GOI share	:	Rs. 4000
Matching State share	:	Rs. 1333
ULB contribution	:	Rs. 2000
Beneficiary's contribution	:	Rs. 1000
Additional State share	:	Rs. 2657
Total		Rs. 10,990

Commitments from the ULBs should be obtained by the District Magistrates regarding payment of ULBs share and beneficiary's share.

437

-3-

The release of fund is also subject to the following conditions:

- 1) The fund should be utilized only for the purpose for which it is released and for no other purpose.
- 2) Works for the released amount should be executed strictly as per scheme Guidelines.
- 3) Monthly report of Physical and Financial progress should be sent to SUDA and MED by the 7th of the following month.
- 4) The amount released herein should be kept in the dedicated Bank Account for SBM maintained by the ULBs.
- 5) A subsidiary Cash Book should be maintained for keeping accounts (deposits and withdrawals) of funds.
- 6) Money receipt in Form 42 may be sent immediately after receipt of the online transfer.
- 7) Appropriate amounts should be sub allotted to the concerned ULBs.



Finance Officer, SUDA.

SUDA-22/2015 / 130/1(4).

20.04.2018

Copy Forwarded for kind information of:

1. Secretary, UD & MA Dept, Govt. of West Bengal.
2. Sri B.N.KAR, Addl. Dir. SBM and Addl. Dir. ILGUS.
3. Chief Engineer, M.E. Directorate.
4. Cashier, SUDA.



Finance Officer, SUDA.

Abstract of Cost Estimate of Individual Household Latrine with GCI Sheet Wall, Roof & Door and Double leach pit of circular ferro-cement/ concrete rings.

S/ No.	Description of Item	Quantity	Unit	Rate (Rs.)	Amount (Rs.)
1	1st Class Bricks	85.00	Each	8.50	722.50
2	Cement (Reputed brand with ISI mark)	3.00	Bag	370.00	1110.00
3	1/2" Stone Chips	5.00	Cft	43.00	215.00
4	Sand (Course)	15.00	Cft	32.00	480.00
5	Steel (using 8 mm. rod) for 2 pit covers	2.50	kg	55.00	137.50
6	Jhama bats (PWD SOR Wage for Breaking)	3.00	C.B.	40.00	120.00
7	GCI sheet (of thickness 0.10 mm) for door of height 5'-0" (cutting piece from sheet of full height 10'-0": 7 pieces in bundle @ Rs. 2,100/-)	1.00	Piece	475.00	475.00
8	GCI sheet (of thickness 0.25 mm) for roof & wall of height 5'-0" & width 2'-0" (cutting piece from sheet of height 10'-0": 7 pieces in bundle @ Rs. 2,450/-)	1.00	Piece	535.00	1605.00
9	PVC pipe (4" dia, 2'-0" long) with 'Y' junction	1.00	Set	200.00	200.00
10	Washer, Nut-bolt, Black annealed wire (for binding G. wire in ferro cement rings used), Hinges, Sikols P sheet etc.	LS	LS	LS	100.00
11	Ceramic rural pan / trap with foot rest	1.00	Set	500.00	500.00
12	Double leach pit using with circular ferro-cement/ concrete rings in each pit	1.00	Set	LS	1000.00
13	Timber batten for door and roof (local heart wood)	LS	LS	LS	500.00
14	D splas Board	LS	LS	LS	100.00
15	Transportation cost of all Materials	LS	LS	LS	400.00
16	Skilled labour for Masonary work	4.00	MD	326.00	1304.00
17	Supervisor (to be engaged for every 6 IHHL's vide Memo No. 301 (20)/Comm-P & RD/P/NREGA/185-01/06 (part-I) dated 08.10.2013 of P & RDD, Government of West Bengal.	0.20	MD	300.00	60.00
18	Un-skilled labour for masonary work	8.00	MD	245.00	1960.00
				GRAND TOTAL = RS.	10989.00
				SAY = RS.	10989.00
(Rupees Ten Thousand Nine Hundred & Eighty Nine Only)					
Note: This estimate is prepared on the basis of PWD (WB) Schedule of rates for building works (effective from 01st July, 2014) and local presumed market rate.					

[Handwritten signature]

[Handwritten signature]

[Handwritten signature]

Eno. 2

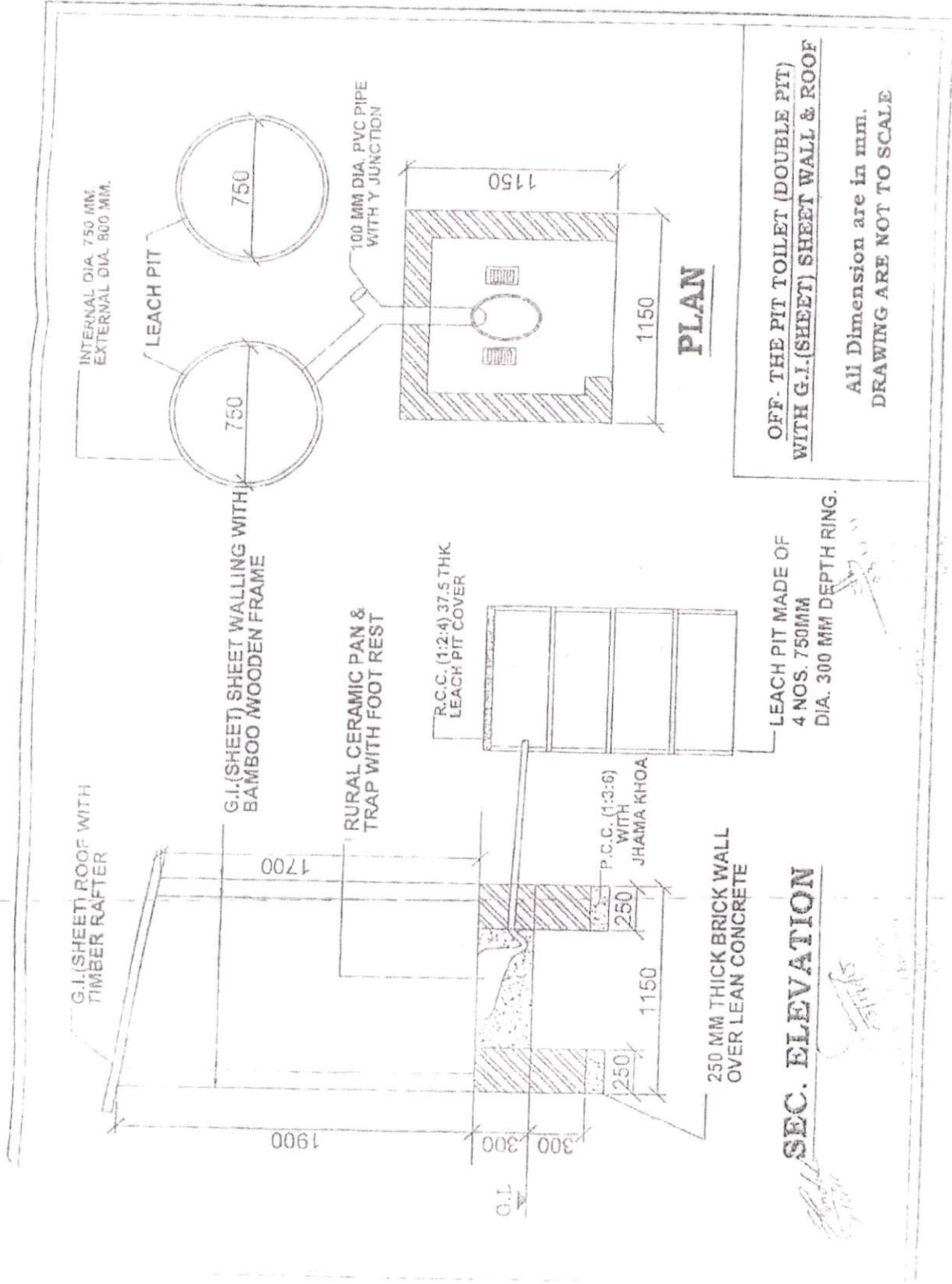

PLAN

**OFF- THE PIT TOILET (DOUBLE PIT)
WITH G.I.(SHEET) SHEET WALL & ROOF**

All Dimension are in mm.
DRAWING ARE NOT TO SCALE

SEC. ELEVATION

LEACH PIT MADE OF
4 NOS. 750MM
DIA. 300 MM DEPTH RING.

250 MM THICK BRICK WALL
OVER LEAN CONCRETE

RURAL CERAMIC PAN &
TRAP WITH FOOT REST

R.C.C. (1:2:4) 37.5 THK
LEACH PIT COVER

P.C.C. (1:3:6)
WITH
JHAMA KHOA

G.I.(SHEET) ROOF WITH
TIMBER RAFTER

G.I.(SHEET) SHEET WALLING WITH
BAMBOO WOODEN FRAME

INTERNAL DIA. 750 MM.
EXTERNAL DIA. 800 MM.

LEACH PIT

750

750

100 MM DIA. PVC PIPE
WITH Y JUNCTION

1150

1150

1700

1900

G.L.

300

300

250

250

1150

SHARMA

SHARMA

STATE URBAN DEVELOPMENT AGENCY

“ইলগাস ভবন”, এইচ-সি ব্লক, সেক্টর-৩, বিধাননগর, কলকাতা-৭০০ ১০৬, পশ্চিমবঙ্গ

“ILGUS BHAVAN”, H-C Block, Sector - III, Bidhannagar, Kolkata - 700 106, West Bengal

SUDA-22/2015/86

16.04.2018

ক্রমিক নং

তারিখ

From : Director, SUDA

To : The Branch Manager,
Axis Bank Ltd.,
Salt Lake, Sector-II Branch,
BJ-110, Sector-II,
Salt Lake City, Kolkata - 700 091.

**Sub : Electronic Transfer of Fund debiting this office
Current Account No.916010072244925.**

Swachh Bharat Mission (SBM)

Sir,

You are requested to kindly arrange for electronic transfer of funds as per details given below debiting the amount from this office Savings Account No.916010072244925 lying with your branch in respect of Swachh Bharat Mission (SBM).

Sl.	Name of Payee	Amount in Rs.	Bank Details
01.	District Magistrate, Uttar Dinajpur District	2,08,00,000.00	State Bank of India, Karnojora Branch, A/C No.11193903792 IFS Code.SBIN0001654
(Rupees Two Crore Eight Lakh only)			

(Md Asif Sardar)
Finance Officer
SUDA

(Sutanu Prasad Kar)
Director
SUDA

দূরভাষ : ২৩৫৮ ৬৪০৩ / ৫৭৬৭, ফ্যাক্স : ২৩৫৮ ৫৮০০

Tel : 2358 6403/5767, Fax : 2358 5800, E-mail : wbsudadir@gmail.com

Account Section : 2358 6408

STATE URBAN DEVELOPMENT AGENCY

“ইলগাস ভবন”, এইচ-সি ব্লক, সেক্টর-৩, বিধাননগর, কলকাতা-৭০০ ১০৬, পশ্চিমবঙ্গ
 “ILGUS BHAVAN”, H-C Block, Sector - III, Bidhannagar, Kolkata - 700 106, West Bengal

SUDA-22/2015/86

16.04.2018

ক্রমিক নং

তারিখ

From : Director, SUDA

To : The Branch Manager,
 Axis Bank Ltd.,
 Salt Lake, Sector-II Branch,
 BJ-110, Sector-II,
 Salt Lake City, Kolkata - 700 091.

**Sub : Electronic Transfer of Fund debiting this office
 Current Account No.916010072244925.**

Swachh Bharat Mission (SBM)

Sir,

You are requested to kindly arrange for electronic transfer of funds as per details given below debiting the amount from this office Savings Account No.916010072244925 lying with your branch in respect of Swachh Bharat Mission (SBM).

Sl.	Name of Payee	Amount in Rs.	Bank Details
01.	District Magistrate, Uttar Dinajpur District	2,08,00,000.00	State Bank of India, Karnojora Branch, A/C No.11193903792 IFS Code.SBIN0001654
(Rupees Two Crore Eight Lakh only)			



(Md Asif Sardar)
 Finance Officer
 SUDA



(Sutanu Prasad Kar)
 Director
 SUDA

16-04-18

সুডা

রাজ্য নগর উন্নয়ন সংস্থা

432

SUDA

STATE URBAN DEVELOPMENT AGENCY

“ইলগাস ভবন”, এইচ-সি ব্লক, সেক্টর-৩, বিধাননগর, কলকাতা-৭০০ ১০৬, পশ্চিমবঙ্গ

“ILGUS BHAVAN”, H-C Block, Sector - III, Bidhannagar, Kolkata - 700 106, West Bengal

SUDA-22/2015/৪৬

16.04.2018

ক্রমিক নং

তারিখ

From : Director, SUDA

To : The Branch Manager,
Axis Bank Ltd.,
Salt Lake, Sector-II Branch,
BJ-110, Sector-II,
Salt Lake City, Kolkata - 700 091.Sub : Electronic Transfer of Fund debiting this office
Current Account No.916010072244925.

Swachh Bharat Mission (SBM)

Sir,

You are requested to kindly arrange for electronic transfer of funds as per details given below debiting the amount from this office Savings Account No.916010072244925 lying with your branch in respect of Swachh Bharat Mission (SBM).

Sl.	Name of Payee	Amount in Rs.	Bank Details
01.	District Magistrate, Uttar Dinajpur District	2,08,00,000.00	State Bank of India, Karnojora Branch, A/C No.11193903792 IFS Code.SBIN0001654
(Rupees Two Crore Eight Lakh only)			

(Md Asif Sardar)
Finance Officer
SUDA

(Sutanu Prasad Kar)
Director
SUDA

16-04-18

দূরভাষ : ২৩৫৮ ৬৪০৩ / ৫৭৬৭, ফ্যাক্স : ২৩৫৮ ৫৮০০

Tel : 2358 6403/5767, Fax : 2358 5800, E-mail : wbsudadir@gmail.com

Account Section : 2358 6408



OFFICE OF THE BOARD OF COUNCILLORS'
KALIYAGANJ MUNICIPALITY
KALIYAGANJ(733129) : : : DIST. UTTAR DINAJPUR

Encl. J. 8/3/18 13/1 (A)

Mobile - 9434743351 (Chairman)
e-mail ID - chairmankm2016@gmail.com (Chairman)

E-Mail Id - kaliyaganjmunicipality@gmail.com
Website : www.kaliyaganjmunicipality.org
Phone - 03523-259165

Ref No : 382/Nirmal Bangla/18

Date : 08.03.2018

To
The Director
State Urban Development Agency
ILGUS Bhavan
H.C. Block, Sector - III
Salt Lake
Kolkata - 106.

Through
The District Magistrate
Uttar Dinajpur
Karnajora, U/Dinajpur

Sub : Prayer for sanction and release of fund for construction of
Public Toilet under Nirmala Bangla/SBM

Ref : This office letter No. 238/Nirmal Bangla/18, dt. 17.02.2018

Sir,

With reference to the above, this is to inform you that being inspired by Hon'ble Chief Minister, Govt. of West Bengal Kaliyaganj Municipality has decided to construct Public Toilet at 40 different locations within Kaliyaganj Municipal area.

In this connection, this also to inform you that we have prepared an estimate for construction of Public Toilet and the unit price has come as Rs. 5,32,719-00 (copy of vetted estimate is enclosed). As such we require fund of Rs. 5,32,719-00 x 40 Nos. = 2,13,08,760-00 for construction of 40 Units of Public Toilets at different locations within Kaliyaganj Municipal area. It is to note that in our previous letter, we had mentioned the scheme as "Community Toilet" but since the nomenclature of the scheme has been changed as "Public Toilet" so, please read the scheme name as Construction of Public Toilet instead of Community Toilet.

Kindly, arrange to sanction and release of fund for construction of Public Toilets under Mission Nirmal Bangla/SBM.

Your kind consideration and necessary action in this regard is solicited.

Encl : As stated

Yours faithfully,

(K.C. Paul)
Chairman

Kaliyaganj Municipality
Chairman
Kaliyaganj Municipality
Kaliyaganj, U/Dinajpur.



OFFICE OF THE BOARD OF COUNCILLORS'
KALIYAGANJ MUNICIPALITY
KALIYAGANJ(733129) : : DIST. UTTAR DINAJPUR

Mobile - 9434743351 (Chairman)
e-mail ID - chairmankm2016@gmail.com (Chairman)

E-Mail Id - kaliyaganjmunicipality@gmail.com
Website : www.kaliyaganjmunicipality.org
Phone - 03523-259165

Ref No: 238 / Nirmal Bangla / 18 Date: 17/2/18

To
The Director
State Urban Development Agency
ILGUS Bhavan
H.C. Block, Sector - III
Salt Lake
Kolkata - 106.

Through
The District Magistrate
Uttar Dinajpur
Karnojora, U/Dinajpur

Sub : Prayer for sanction and release of fund for construction of
Community Toilet under Nirmala Bangla/SBM

Sir,

With reference to the above, this is to inform you that being inspired by Hon'ble Chief Minister, Govt. of West Bengal Kaliyaganj Municipality has decided to construct Community Toilet at 40 different locations within Kaliyaganj Municipal area.

In this connection, this also to inform you that we have prepared an estimate for construction of Community Toilet and the unit price has come as Rs. 5,32,719-00 (copy of vetted estimate is enclosed). As such we require fund of Rs. 5,32,719-00 x 40 Nos. = 2,13,08,760-00 for construction of 40 Units of Community Toilets at different locations within Kaliyaganj Municipal area.

Kindly, arrange to sanction and release of fund for construction of Community Toilets under Mission Nirmal Bangla/SBM.

Your kind consideration and necessary action in this regard is solicited.

Enco : As stated

Yours faithfully,

(K.C. Paul)
Chairman
Kaliyaganj Municipality

Chairman
Kaliyaganj Municipality
Kaliyaganj, U/Dinajpur.



429

PROPOSED ESTIMATE FOR THE PUBLIC TOILET AT DIFFERENT PLACES WITHIN KALIYAGANJ MUNICIPAL AREA.
KALIYAGANJ MUNICIPALITY, UTTAR DINAJPUR, PIN - 733129.

Rates are taken as per PWD schedule [Incorporation of GST Act, 2017 & alladdenda & corrigenda SOR, 01.12.2015] with effect from 01.11.2017

Sl. no.	Description of item	Quantity	Unit	Basic Rate	12% GST	1% Cess	Total Rate	Amount
1	A) Filling in foundation or plinth by silver sand in layers not exceeding 150 mm as directed and consolidating the same by thorough saturation with water, ramming complete including the cost of supply of sand. (payment to be made on measurement of finished quantity) (Page No-02, Item No-04(A)) = (4.375m. X 3.775 m) X 0.45 m	7.43	cum.	487.41	58.49	5.46	551.36	4096.60
2	Ordinary Cement concrete (mix 1:1.5:3) with graded stone chips (20 mm nominal size) excluding shuttering and reinforcement if any, in ground floor as per relevant IS codes. (Page No-26, Item No-10(i)) (i) Pakur Variety Lintel= 0.752 cum (0.125mX0.150m)= [[3.775mX3nos) + (4.625mX2nos) + (1.50mX4nos) + (2.05mX2nos) + 1.725m + 0.90m]X0.125mX0.150m = 0.624 Cum. 2.85mX0.45mX0.10m = 0.128 Cum Roof Beam= 1.0 cum (0.20mX0.20m)= [[3.775mX3nos) + (4.625mX2nos)]X0.20mX0.20m = 1.0 Cum. Roof= 2.08 cum 4.875m X 4.275m X 0.100 m = 2.08 cum	3.83	cum.	6075.07	729.01	68.04	6872.12	26320.22
3	Hire and labour charges for shuttering with centering and necessary staging upto 4 m using approved stout props and thick hard wood planks of approved thickness with required bracing for concrete slabs, beams and columns, lintels curved or straight including fitting, fixing and striking out after completion of works (upto roof of ground floor) (a) 25 mm to 30 mm thick wooden shuttering as per decision & direction of Engineer-in-Charge. Lintel = 9.99 Sqm. [[3.775mX3nos) + (4.625mX2nos) + (1.50mX4nos) + (2.05mX2nos) + 1.725m + 0.90m]X0.15mX2nos = 9.99 Sqm Chhajjah = 1.66 Sqm. (2.85mX0.45m) + (0.10mX3.75m) = 1.66 Sqm Roof Beam = 10.08 Sqm [[3.775mX3nos) + (4.625mX3nos)]X0.20mX2nos = 10.08 Sqm. Roof= 22.67 Sqm. (4.875m X 4.275m) + (18.30mX0.10m) = 22.67 Sqm.	44.4	Sqm.	328.00	39.36	3.67	371.03	16473.73
4	Reinforcement fr reinforced concrete wrks in all sorts structures including distributin bars stirrups binders initial straightening and removal f loose rust (if necessary), cutting t requisite length, hking and bending t rrect shape placing in prper psitin & binding with 16 gauge black annealed wire at every intersectin, complete as per drawing & directin. a) Fr wrk in fundatin, basement & upt rf f grund flr/ upt 4 m. b) steel/mild steel. cum X Assuming 1.0% steel = 3.83 Page No.-43, Item No.-140.a)	0.3	M. T.	57608	6912.96	-576.08	66097	19529.1
5	Brick work with 1st class bricks in cement mortar (1:4) Page No. - 15 Item No.-7 (a) In foundation and plinth 0.875 m X 0.3 m X 25.12 m = 6.59 cum 0.625 m X 0.3 m X 25.12m = 4.71 cum 0.375 m X 0.3 m X 25.12 m = 2.83 cum 0.25m X 0.45m X 25.12 m = 2.83 cum (b) In superstructure, ground floor Step = [(0.75mX0.15m)+(0.50mX0.15m)+(0.25mX0.15m)] X2.85m = 0.64 cum	16.96	cum.	5177.00	621.24	57.98	5856.22	99321.49

645-21 65166-20 12540-85

228

	(0.25mX0.25mX2.35m)X9nos = 1.32 Cum	1.96	cum.	5400	648	60.48	6108.48	11972.62
6	125 mm. thick brick work with 1st class bricks in cement mortar (1:4) in ground floor.							
	(3.875mX2.4m)X2nos = 18.60 Sqm (3.275mX2.4m)X3nos = 23.58 Sqm (1.50mX2.4m)X4nos = 14.40 Sqm (0.90mX2.4m)X1nos = 2.16 Sqm - (2.45mX2.10m)X1nos = -5.14 Sqm - (0.50mX0.45m)X10nos = -2.25 Sqm Total = 51.35 Sqm	51.35	Sqm	674	80.88	7.55	762.43	39150.78
7	Plaster (to wall, floor, ceiling etc.) with sand and cement mortar including rounding off or chamfering corners as directed and raking out joints including throating, nosing and drip course, scaffolding/staging where necessary (Ground floor). [Excluding cost of chipping over concrete surface] Page No.-189 Item No.-1(ii)							
	(ii) With 1:4 cement mortar (a) 20 mm thick plaster(outer side) = (4.625mX2.75m)X2nos = 25.44 Sqm (4.025mX2.75m)X2nos = 22.14 Sqm (4.625m+4.025m)X0.45mX2nos = 7.78 Sqm (1.20mX2.85m) = 3.42 Sqm - (2.45mX2.10m)X1nos = -5.14 Sqm - (0.50mX0.45m)X10nos = -2.25 Sqm Total = 51.39 Sqm	51.39	Sqm.	181	21.72	2.03	204.75	10522.10
8	(b) 15 mm thick plaster(inner side)= (4.375mX2.75m)X2nos = 24.06 Sqm (3.775mX2.75m)X4nos = 41.52 Sqm (1.50mX2.75m)X8nos = 33.00 Sqm (0.90mX2.75m)X2nos = 4.95 Sqm - (2.45mX2.10m)X1nos = -5.14 Sqm - (0.50mX0.45m)X10nos = -2.25 Sqm Total = 96.14 Sqm	158.93	Sqm.	157	18.84	1.76	177.6	28225.97
	(c) 10 mm thick plaster (ceiling)= (4.875mX4.275m) = 20.84 Sqm (4.875m+4.275m)X0.10mX2nos = 1.83 Sqm Total = 22.67 Sqm	22.67	Sqm.	127	15.24	1.42	143.66	3256.77
9	25mm. thick damp proof course with cement concrete with stone chips (1:1.5:3) [with graded stone aggregate 10 mm nominal size] and admixture of water proofing compound as per manufacturer's specification followed by two coat of polymer based paint, (1st coat after 4 to 5 days of concrete laying and 2 nd coat just before brick masonry work) as directed (cost of water proofing compound & polymer based paint to be paid separately). [Chequering not required over concrete or painted surface]. Page No.-47 Item No.-1							
	[(3.775mX3nos) + (4.625mX2nos) + (1.50mX4nos) + (0.90m)X0.125] = 3.43 Sqm	8.25	Sqm	204	24.48	2.28	230.76	1903.77
9	(a) M.S. or W.I. Ornamental grill of approved design joints continuously welded with M.S, W.I. Flats and bars of windows, railing etc. fitted and fixed with necessary screws and lugs in ground floor. Page No. - 104, Item No. - 13,a,i							
	(i) Grill weighing above 10 Kg./sq.mtr and up to 16 Kg./sq.mtr. (0.50 m X 0.45 m)X10 nos = 2.25 Sqm. (1.2m X 2.1 m) +(1.0mX2.10m) = 4.62 Sqm. Total = 6.87 Sqm.	0.82	Qntl	7371	884.52	82.55	8338.07	6837.22

427
18

10	<p>Supplying, Fitting & Fixing 30 mm thick Factory made solid Panel PVC Door Shutter consisting of outer frame made out of M.S. tubes of 19 gauge thickness and size 19 mmx19 mm for styles, top and bottom rails, M.S. frame shall have cost of steel primers of approved make and manufacture, M.S. frame covered with 5 mm th. heat moulded PVC "C" channel of size 30 mm th, 70 mm width out of which 50 mm shall be flat and 20 mm shall be tapered in 45 degree angle on either sides forming styles; and 5 mm th. 95 mm wide PVC sheet out of which 75 mm shall be flat and 20 mm tapered in 45 degree on the inner side to form top & bottom rail and 115 mm wide PVC sheet out of which 75mm shall be flat and 20 mm shall be tapered on both sides to form lock rail. Top, bottom and lock rails shall be provided either side of the panel with 10 mm (5 mmx2) th., 20 mm wide cross PVC sheet as gap insert for top rail and bottom rail. Paneling of 5 mm th. both side PVC sheet to be fitted in the M.S. frame welded/sealed to the styles & rails with 7 mm (5 mm+2 mm) th x15 mm wide PVC sheet beading on inner side and joined together with solvent cement adhesive. An additional 5 mm th. PVC strip of 20 mm which is to be stuck on the interior side of the "C" channel using PVC solvent adhesive etc. complete excluding all necessary hardwares as per direction of Engineer-in-Charge. In ground floor.</p>							
	[0.75 m X 2.1 m) X 6 nos. = 9.45 Sqm.	9.45	Sqm	1943	233.16	21.76	2197.92	20770.34
11	<p>(a) Priming one coat on steel or other metal surface with synthetic oil bound primer of approved quality including smoothening surfaces by sand papering etc. Page No. - 200, Item No. - 01</p>							
	V & W = 6.87 Sqm	6.87	Sqm	29	3.48	0.32	32.8	225.34
12	<p>Colour washing with any shade with Stainers, as required including cleaning and smoothening surface thoroughly: Page No. - 194, Item No. -4.</p> <p>(i) Internal surface (All floors)</p> <p>(b) Two coats (on new works only).</p> <p>(i) Other than yellow, pink.</p> <p>Inner Side =</p> <p>(4.375mX0.65m)X2nos = 5.69 Sqm (3.775mX0.65m)X2nos = 4.91 Sqm (3.775mX2.75m)X2nos = 20.76 Sqm (1.50mX0.65m)X8nos = 7.80 Sqm (0.90mX0.65m)X2nos = 1.17 Sqm - (0.50mX0.45m)X10nos = -2.25 Sqm Total = 38.08</p> <p>ceiling = 22.67</p>	60.75	Sqm	20.46	2.45	0.23	23.14	1406.02 1406.02
	(ii) External surface (Ground floor) <p>(b) Two coats (on new works only).</p> <p>(i) Other than yellow, pink.</p> <p>Outer side = 46.90 Sqm.</p>	46.9	Sqm	21.35	2.56	0.24	24.15	1132.64
13	<p>Supplying, fitting & fixing 1st quality Ceramic tiles in walls and floors to match with the existing work & 4 nos. of key stones (10mm) fixed with araldite at the back of each tile & finishing the joints with white cement mixed with colouring oxide if required to match the colour of tiles including roughening of concrete surface, if necessary or by synthetic adhesive & grout materials etc. Page No. - 64, Item No. - 35, B, a(i)</p> <p>(B) Wall</p> <p>(a) Area of each tile upto 0.09 Sq.m</p> <p>(i) Coloured decorative</p> <p>(4.375mX2.1m)X2nos = 18.37 Sqm (3.775mX2.1m)X2nos = 15.85 Sqm (1.50mX2.1m)X8nos = 25.20 Sqm (0.90mX2.1m)X2nos = 3.78 Sqm - (2.45mX2.10m) = - 5.14 Sqm - (0.50mX0.45m)X10nos = -2.25 Sqm Total = 55.81 Sqm</p>	55.81	Sqm	743	89.4	8.34	842.74	47033.32

426 @

<p>14 Construction of septic tank of different capacities as per approved drawing with 1st class brick work in cement mortar (1:4) including two 560 mm dia. R.C.C. manhole cover (heavy type) of approved make supplied, fitted and fixed in the 100mm thick R.C.C. (1:1.5:3) top slab with necessary fittings, 20mm thick cement plaster (4 : 1) with neat cement finish to the internal surfaces and 15 mm thick cement plaster (4 : 1) to outside wall upto 200 mm below G.L floor finished with 25 mm thick grey artificial stone over 100 mm thick R.C.C.(1:1.5:3) bottom slab including supplying, fitting and fixing all necessary specials, fittings, S.W. tees, C.I. foot rest etc. including excavation earth in all sorts of soil, shoring, bailing out and pumping out water as necessary, ramming, dressing the bed and refilling the sides of the tanks with earth, removing spoils, filling up the chamber with clear water, removing foreign materials from the chamber and including constructing attached inspection pit as per approved drawing and connecting all necessary pipes, joints etc. with internal plaster work and artificial stone flooring is to be done with admixture of water proofing compound @ 0.5% by weight of cement with all costs of labour and materials. Note:- (i) Finished level of Septic Tank should be 400 mm from Ground Level. (ii) Height of 50 mm. Ventilation pipe & Mosquito proof mesh, should be followed as per IS:2470, Part - I. Payment will be made separately on the basis of actual height based on relevant</p>	<p style="text-align: center;">103185.00 12302.2 116723.0</p>						
<p>(v) For 100 users</p>							
<p>B) With Bazree (N.B Variety) (Other than SAIL/TATA/RINL)</p>	1	Each	104907	12588.84	1174.96	118670.8	118670.8
<p>15 Construction of circular soak well 2.5 metre deep in all types of sandy soils with dry brick work upto 1.6 metre from the bottom having 150 mm intermediate cement brick work (1:4) band all round and cement brick work (1:4) upto 0.90 metre from top with 20mm thick cement plastering (1:4) to inside face upto the depth of cement brick work, 15mm thick cement plaster (1:4) on outer face from top of the well upto G.L. and 6 mm thick cement plaster (1:4) on top of the R.C.C. cover slab including filling bottom 1.00 metre of inside of the well with brick metal (50 mm to 63 mm size) including R.C.C. cover slab of 100 mm thick with cement conc (1:1.5:3) with stone chips with necessary reinforcement and shuttering including one 560 mm dia. R.C.C. manhole cover (heavy type) of approved make supplied, fitted and fixed in the cover slab with necessary fittings, making necessary arrangements for pipe connections, excavation of well including shoring, dewatering and removing the excess earth from the premises as per direction complete in all respect with all costs of labour and materials. With 250 mm thick dry brick work and 250 mm thick cement brick work (1:6) and 1.00m inside dia</p>	<p style="text-align: center;">1155.67 116722.87</p> <p style="text-align: center;">1340.68 171.80 17351.5 17351.50</p>						
Estimated Cost							Rs. 4,74,426.29
Add 10.00 % for Sanitary & Plumbing work							Rs. 47,442.63
							Rs. 5,21,868.92
Total Cess							Rs. 2,249.19
Excluding Cess							Rs. 5,19,619.73
Add Contingency @ 3.00 %							Rs. 15,588.59
							Total Rs. 5,37,457.51
							Say Rs. 5,37,457.00

472272.73
47227.27
519500.00
2296.81
517203.19
15516.10
5,32,719.29
5,32,719.00

Rupees (Five Lac Thirty Seven Thousand Four Hundred Fifty Seven) only.

Five Lac Thirty two Thousand Seven Hundred Ninety only

16/02/18
Sub-Assistant Engineer
Kaliyaganj Municipality
Kaliyaganj, Uttar Dinajpur

Chairman
Kaliyaganj Municipality
Kaliyaganj, U/Dinajpur

15/02/18
Junior Engineer
Dinajpur Division
M. E. Directorate
Deptt. of U. D. M. A.
Govt. of West Bengal

16/2/18
Assistant Engineer
Dinajpur Division
M. E. Directorate
Deptt. of U. D. M. A.
Govt. of West Bengal

VETTED

16/2/18
Executive Engineer
Dinajpur Division
M. E. Directorate
Deptt. of U. D. M. A.
Govt. of West Bengal

A25 (6)

COMMUNITY TOILET

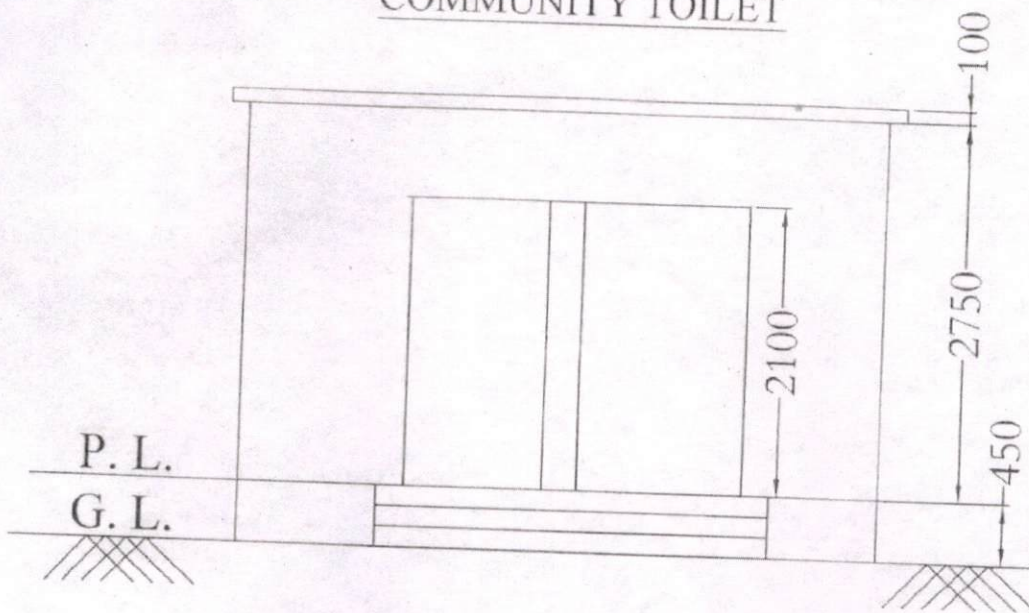

FRONT ELEVATION

SCALE - 1:100

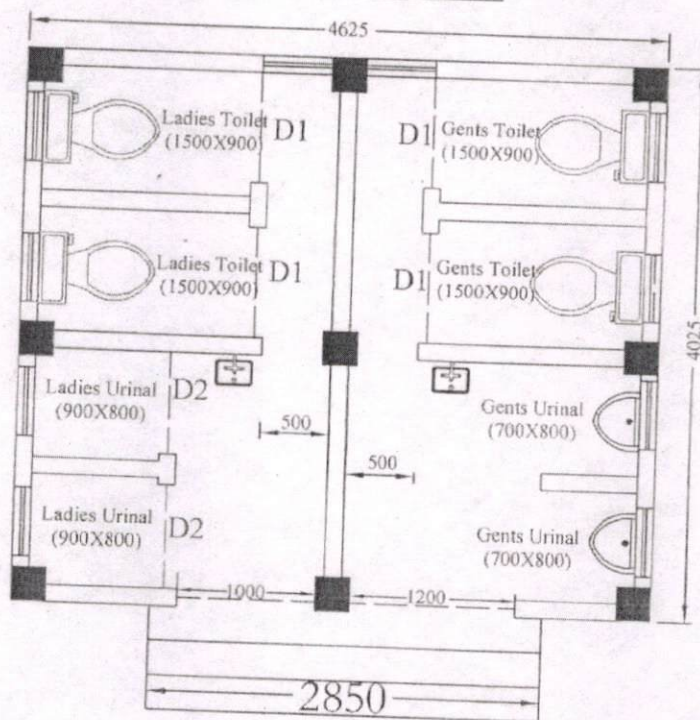

PLAN

SCALE - 1:100

DRAWN BY :-

APPROVED BY :-

- 1. All dimensions are in 'MM'.
- 2. D1 = 800 X 2100
- 3. D2 = 750 X 2100

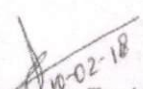
 10-02-18
 Sub-Assistant Engineer
 Kaliyaganj Municipality
 Kaliyaganj, Uttar Dinajpu

STATE URBAN DEVELOPMENT AGENCY

“ইলগাস ভবন”, এইচ-সি ব্লক, সেক্টর-৩, বিধাননগর, কলকাতা-৭০০ ১০৬, পশ্চিমবঙ্গ

“ILGUS BHAVAN”, H-C Block, Sector - III, Bidhannagar, Kolkata - 700 106, West Bengal

৭২৭

ক্রমিক নং SUDA- ২২/২০১৫/ ১০৫৫

তারিখ ০৫.১২.২০১৭-

From: Finance Officer, SUDA

To: District Magistrate, Malda

MEMORANDUM

Sub: Release of fund to District Magistrate, Malda for construction of 15375 nos of IHHL units and 272 nos of Community Toilets under Mission Nirmal Bangla (U)/ Swachh Bharat Mission (U)

Sir,

In response to your office Memo no. 290/MZP-17/MNB-1/151 Dated 28.10.2017 an amount of Rs. 149502250 has been released in favour of District Magistrate, Malda for construction of 15375 nos of IHHL Units and 272 nos of Community Toilet under Mission Nirmal Bangla (U)/ Swachh Bharat Mission (U).

Name of Municipality	IHHL required	Fund required for IHHL @ Rs. 7990/-	No of Community Toilet Required	No of Community Toilet Seat Required	Fund Required for CT @ Rs. 98000/-	Total Fund Required (in Rs)
English Bazar	7315	58446850	43	172	16856000	75302850
Old Malda	8060	64399400	25	100	9800000	74199400
	15375	122846250	68	272	26656000	149502250

The amounts released represent the central and matching state shares as well as the Additional state shares. The District Administration is requested to place appropriate funds at the disposal of the ULBs to enable them to continue the pace of construction of IHHL & CT.

Particulars	Central Share	Matching State Share	Addt. State Share	Total (Rs. In lakh)	Name of Payee	Bank Details
15375 No. of IHHL Units	615.00	204.95	408.51	1228.46	MZP-TSC (ST)	IDBI Bank Ltd, Malda Branch, A/C No:- 0448104000028769 IFS Code:- IBKL0000448
272 No. of Community Toilet	106.63	35.54	124.39	266.56		

Yours faithfully,



Finance Officer, SUDA.

Encl: As stated

দূরভাষ : ২৩৫৮ ৬৪০৩ / ৫৭৬৭, ফ্যাক্স : ২৩৫৮ ৫৮০০

Tel : 2358 6403/5767, Fax : 2358 5800, E-mail : wbsudadir@gmail.com

Account Section : 2358 6408

In this connection kindly find enclosed herewith the provisional number of IHHL units to be constructed in the Urban Local Bodies of the District ULB wise as per findings of the comprehensive house to house survey for identification of insanitary latrine/no latrine facilities. However the actual number will be as per field executions. The model plan for the latrine unit as prepared by Municipal Engineering Directorate at an estimated cost of Rs. 10,990/- has been decided to be adopted in the program. A copy of plan and estimate of the model design of the latrine is enclosed herewith. The implementation of the program may be undertaken under the overall co-ordination of the District Magistrates and the respective ULBs. The work may be executed preferably through sanitary mart or such other self-help groups (as was done in the case of Nadia) or through the ULBs or otherwise as may be decided by the respective District Administration.

It is further informed that the progress of construction of IHHL starting from applications by the beneficiaries to completion of the units are required to be uploaded in the Govt. of India's portal under SBM. The uploading may be done by CSC e-Governance Services India Ltd. (a special purpose vehicle company constituted by Dept. of Information Technology, Govt. of India and entrusted to look after the CSC scheme across the country) or by the respective ULBs.

The District Administrations will also be required to identify the households where there is no suitable space for construction of IHHL. On receiving a feedback from the Districts proposals for construction of Community Toilets in close proximity of the identified households will be prepared and submitted to the MA Dept. for reference to Finance Department for the required additional State share. Simultaneously the concerned ULBs will be required to identify suitable lands for construction of Community Toilets.

It has further been decided that the following fund sharing pattern will be adopted in implementation of the program:

GOI share	:	Rs. 4000
Matching State share	:	Rs. 1333
ULB contribution	:	Rs. 2000
Beneficiary's contribution	:	Rs. 1000
Additional State share	:	Rs. 2657
Total		Rs. 10,990

Commitments from the ULBs should be obtained by the District Magistrates regarding payment of ULBs share and beneficiary's share.

Handwritten signature

422

-3-

The release of fund is also subject to the following conditions:

- 1) The fund should be utilized only for the purpose for which it is released and for no other purpose.
- 2) Works for the released amount should be executed strictly as per scheme Guidelines.
- 3) Monthly report of Physical and Financial progress should be sent to SUDA and MED by the 7th of the following month.
- 4) The amount released herein should be kept in the dedicated Bank Account for SBM maintained by the ULBs.
- 5) A subsidiary Cash Book should be maintained for keeping accounts (deposits and withdrawals) of funds.
- 6) Money receipt in Form 42 may be sent immediately after receipt of the online transfer.
- 7) Appropriate amounts should be sub allotted to the concerned ULBs.

Finance Officer, SUDA.

SUDA-22/2015 / 1055/1 (4)

05.12.2017

Copy Forwarded for kind information of:

1. Secretary, UD & MA Dept, Govt. of West Bengal.
2. Sri B.N.KAR, Addl. Dir. SBM and Addl. Dir. ILGUS.
3. Chief Engineer, M.E. Directorate.
4. Cashier, SUDA.

Finance Officer, SUDA.

Abstract of Cost Estimate of Individual Household Latrine with GCI Sheet Wall, Roof & Door and Double leach pit of circular ferro-cement/ concrete rings.

Sl. No.	Description of Item	Quantity	Unit	Rate (Rs.)	Amount (Rs.)
1	1st Class Bricks	85.00	Each	8.50	722.50
2	Cement (Reputed brand with ISI mark)	3.00	Bag	370.00	1110.00
3	1/2" Stone Chips	5.00	C.ft.	43.00	215.00
1	Sand (Coarse)	15.00	C.ft.	32.00	480.00
2	Steel (using 8 mm rod) for 2 pit covers	2.50	kg	55.00	137.50
3	Jhama bats (PWD SOR-Wage for Breaking)	3.00	C.ft.	40.00	120.00
4	GCI sheet (of thickness 0.18 mm) for door of height 5'-0" (cutting piece from sheet of full height 10'-0"; 7 pieces in bundle @ Rs. 2,100/-)	1.00	Piece	475.00	475.00
5	GCI sheet (of thickness 0.25 mm) for roof & wall of height 5'-0" & width 2'-8" 9cutting piece from sheet of height 10'-0"; 7 pieces in bundle @Rs. 2,450/-)	3.00	Piece	535.00	1605.00
6	PVC pipe (4" dia, 2'-0" long) with 'Y' junction	1.00	Set	200.00	200.00
7	Washer, Nut-bolt, Black anneated wire (for binding GI wire 9if ferro cement rings used), Hinges, Sikols P sheet etc.	LS	LS	LS	100.00
8	Ceramic rural pan / trap with foot rest	1.00	Set	500.00	500.00
9	Double leach pit lining with circular ferro-cement/ concrete rings in each pit	1.00	Set	LS	1000.00
10	Timber batten for door and roof(local heart wood)	LS	LS	LS	500.00
11	Display Board	LS	LS	LS	100.00
12	Transportation cost of all Materials	LS	LS	LS	400.00
13	Skilled labour for Masonary work	4.00	MD	326.00	1304.00
14	Supervisor (to be engaged for every 6 IHHL's vide Memo No. 301 (20)/Comm-P & RD/P/NREGA/18E-01/06 (part-I) dated 08.10.2013 of P & RDD, Government of West Bengal.	0.20	MD	300.00	60.00
15	Un-skilled labour for masonry work	8.00	MD	245.00	1960.00

GRAND TOTAL = RS. 10989.00

SAY = RS. 10989.00

(Rupees Ten Thousand Nine Hundred & Eighty Nine Only)

N.B.-This estimate is prepared on the basis of PWD (WB) Schedule of Rates for building works (effective from 01st July, 2014) and Local justified marked rate:

Shakil
27/12/15
M. E. Dept. of W. B.
P. O. Box No. 27, Ranchi, Jh.

Sanjay
20/12/15

Shri
20/12/15

Enc. 1

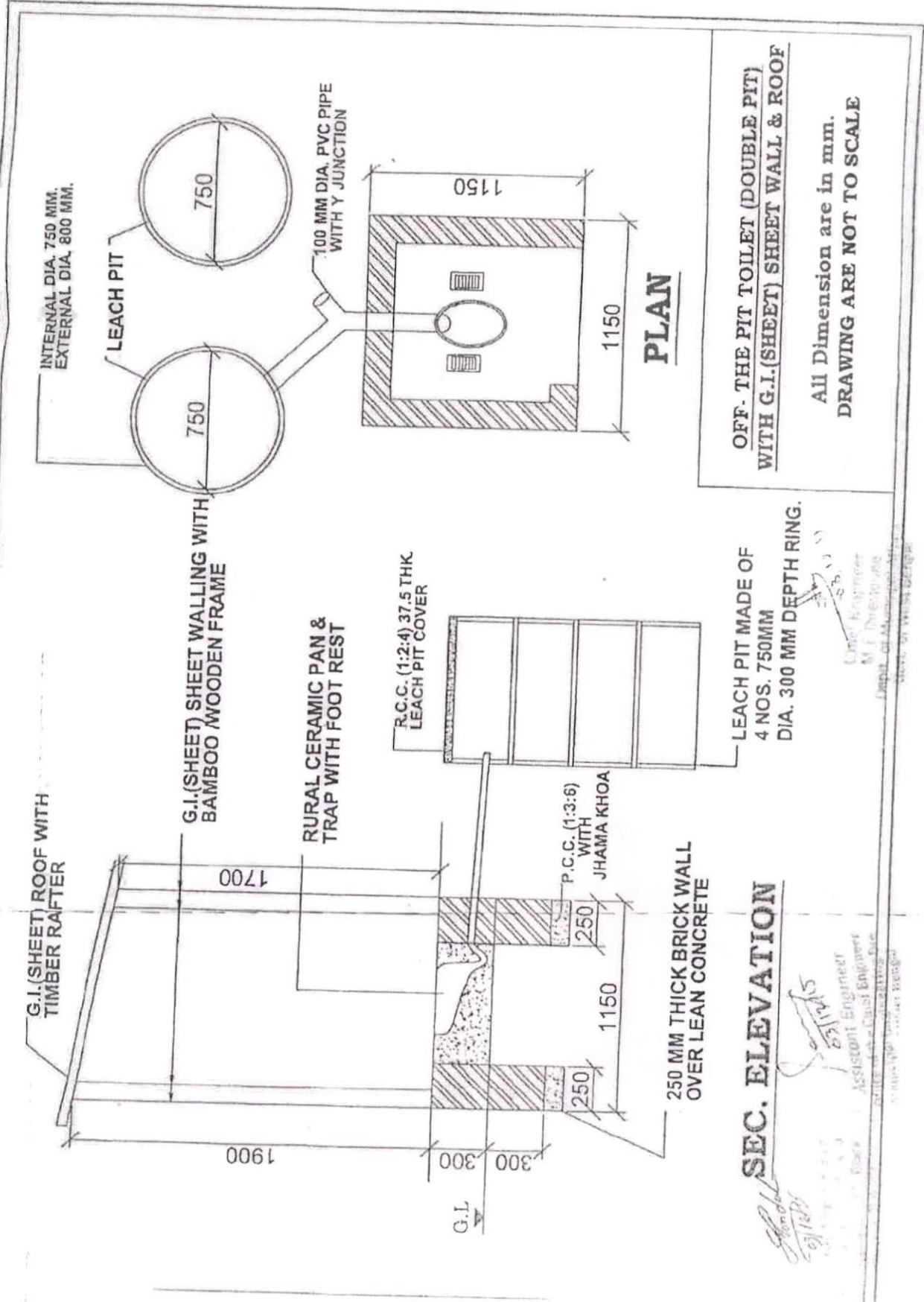

PLAN

OFF- THE PIT TOILET (DOUBLE PIT)
WITH G.I.(SHEET) SHEET WALL & ROOF

All Dimension are in mm.
DRAWING ARE NOT TO SCALE

SEC. ELEVATION

LEACH PIT MADE OF
4 NOS. 750MM
DIA. 300 MM DEPTH RING.

Chief Engineer
M. J. Thakur
Dept. of Municipal Affairs
Muzaffarpur

Assistant Engineer
Muzaffarpur
Muzaffarpur

03/12/15



রাজ্য নগর উন্নয়ন সংস্থা

419

SUDA

STATE URBAN DEVELOPMENT AGENCY

“ইলগাস ভবন”, এইচ-সি ব্লক, সেক্টর-৩, বিধাননগর, কলকাতা-৭০০ ১০৬, পশ্চিমবঙ্গ
“ILGUS BHAVAN”, H-C Block, Sector - III, Bidhannagar, Kolkata - 700 106, West Bengal

ক্রমিক নং SUDA-22/2015/ 1035

30.11.2017

তারিখ

From : Additional Director & Financial Adviser, SUDA

To : The Branch Manager,
Axis Bank Ltd.,
Salt Lake, Sector-II Branch,
BJ-110, Sector-II,
Salt Lake City, Kolkata - 700 091.

Sub : Electronic Transfer of Fund debiting this office
Current Account No.916010072244925.

IHHL - Swachh Bharat Mission (SBM)

Sir,

You are requested to kindly arrange for electronic transfer of funds as per details given below debiting the amount from this office Savings Account No.916010072244925 lying with your branch in respect of Swachh Bharat Mission (SBM).

Sl.	Name of Payee	Amount in Rs.	Bank Details
01.	MZP - TSC (ST)	12,28,46,250.00	IDBI Bank Ltd., Malda Branch, A/C No.0448104000028769 IFS Code.IBKL0000448

(Rupees Twelve Crore Twenty Eight Lakh Forty Six Thousand Two Hundred Fifty only)

(Md Asif Sardar)
Finance Officer
SUDA



(Amalendu Sekhar Naskar)
Addl. Director & F.A.
SUDA

দূরভাষ : ২৩৫৮ ৬৪০৩ / ৫৭৬৭, ফ্যাক্স : ২৩৫৮ ৫৮০০

Tel : 2358 6403/5767, Fax : 2358 5800, E-mail : wbsudadir@gmail.com

Account Section : 2358 6408



রাজ্য নগর উন্নয়ন সংস্থা

STATE URBAN DEVELOPMENT AGENCY

“ইলগাস ভবন”, এইচ-সি ব্লক, সেক্টর-৩, বিধাননগর, কলকাতা-৭০০ ১০৬, পশ্চিমবঙ্গ

“ILGUS BHAVAN”, H-C Block, Sector - III, Bidhannagar, Kolkata - 700 106, West Bengal

SUDA-22/2015/1034

30.11.2017

ক্রমিক নং

তারিখ

From : Additional Director & Financial Adviser, SUDA

To : The Branch Manager,
Axis Bank Ltd.,
Salt Lake, Sector-II Branch,
BJ-110, Sector-II,
Salt Lake City, Kolkata - 700 091.

**Sub : Electronic Transfer of Fund debiting this office
Current Account No.916010072244925.**

CT - Swachh Bharat Mission (SBM)

Sir,

You are requested to kindly arrange for electronic transfer of funds as per details given below debiting the amount from this office Savings Account No.916010072244925 lying with your branch in respect of Swachh Bharat Mission (SBM).

Sl.	Name of Payee	Amount in Rs.	Bank Details
01.	MZP – TSC (ST)	2,66,56,000.00	IDBI Bank Ltd., Malda Branch, A/C No.0448104000028769 IFS Code.IBKL0000448
(Rupees Two Crore Sixty Six Lakh Fifty Six Thousand only)			

(Md Asif Sardar)
Finance Officer
SUDA



(Amalendu Sekhar Naskar)
Addl. Director & F.A.
SUDA

30/11/17
30-11-17

দূরভাষ : ২৩৫৮ ৬৪০৩ / ৫৭৬৭, ফ্যাক্স : ২৩৫৮ ৫৮০০

Tel : 2358 6403/5767, Fax : 2358 5800, E-mail : wbsudadir@gmail.com

Account Section : 2358 6408

সুডা

রাজ্য নগর উন্নয়ন সংস্থা

SUDA

STATE URBAN DEVELOPMENT AGENCY

“ইলগাস ভবন”, এইচ-সি ব্লক, সেক্টর-৩, বিধাননগর, কলকাতা-৭০০ ১০৬, পশ্চিমবঙ্গ

“ILGUS BHAVAN”, H-C Block, Sector - III, Bidhannagar, Kolkata - 700 106, West Bengal

SUDA-22/2015/1034

30.11.2017

ক্রমিক নং

তারিখ

From : Additional Director & Financial Adviser, SUDA

To : The Branch Manager,
Axis Bank Ltd.,
Salt Lake, Sector-II Branch,
BJ-110, Sector-II,
Salt Lake City, Kolkata - 700 091.

**Sub : Electronic Transfer of Fund debiting this office
Current Account No.916010072244925.**

CT - Swachh Bharat Mission (SBM)

Sir,

You are requested to kindly arrange for electronic transfer of funds as per details given below debiting the amount from this office Savings Account No.916010072244925 lying with your branch in respect of Swachh Bharat Mission (SBM).

Sl.	Name of Payee	Amount in Rs.	Bank Details
01.	MZP – TSC (ST)	2,66,56,000.00	IDBI Bank Ltd., Malda Branch, A/C No.0448104000028769 IFS Code.IBKL0000448
(Rupees Two Crore Sixty Six Lakh Fifty Six Thousand only)			

(Md Asif Sardar)
Finance Officer
SUDA

(Amalendu Sekhar Naskar)
Addl. Director & F.A.
SUDA

দূরভাষ : ২৩৫৮ ৬৪০৩ / ৫৭৬৭, ফ্যাক্স : ২৩৫৮ ৫৮০০

Tel : 2358 6403/5767, Fax : 2358 5800, E-mail : wbsudadir@gmail.com

Account Section : 2358 6408

o/c

416

সুডা

রাজ্য নগর উন্নয়ন সংস্থা

SUDA

STATE URBAN DEVELOPMENT AGENCY

“ইলগাস ভবন”, এইচ-সি ব্লক, সেক্টর-৩, বিধাননগর, কলকাতা-৭০০ ১০৬, পশ্চিমবঙ্গ

“ILGUS BHAVAN”, H-C Block, Sector - III, Bidhannagar, Kolkata - 700 106, West Bengal

30.11.2017

ক্রমিক নং SUDA-22/2015/ 1035

তারিখ

From : Additional Director & Financial Adviser, SUDA

To : The Branch Manager,
Axis Bank Ltd.,
Salt Lake, Sector-II Branch,
BJ-110, Sector-II,
Salt Lake City, Kolkata - 700 091.Sub : Electronic Transfer of Fund debiting this office
Current Account No.916010072244925.

IHHL - Swachh Bharat Mission (SBM)

Sir,

You are requested to kindly arrange for electronic transfer of funds as per details given below debiting the amount from this office Savings Account No.916010072244925 lying with your branch in respect of Swachh Bharat Mission (SBM).

Sl.	Name of Payee	Amount in Rs.	Bank Details
01.	MZP - TSC (ST)	12,28,46,250.00	IDBI Bank Ltd., Malda Branch, A/C No.0448104000028769 IFS Code.IBKL0000448
(Rupees Twelve Crore Twenty Eight Lakh Forty Six Thousand Two Hundred Fifty only)			

(Md Asif Sardar)
Finance Officer
SUDA

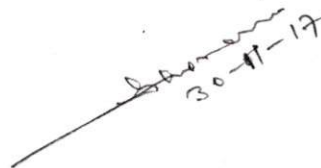
(Amalendu Sekhar Naskar)
Addl. Director & F.A.
SUDA

দূরভাষ : ২৩৫৮ ৬৪০৩ / ৫৭৬৭, ফ্যাক্স : ২৩৫৮ ৫৮০০

Tel : 2358 6403/5767, Fax : 2358 5800, E-mail : wbsudadir@gmail.com

Account Section : 2358 6408