

SHRIRAMPORE MUNICIPALITY

SATYA CHARAN SAS TRI STREET

C. E. S. C. COMPOUND

SATYA CHARAN SAS TRI STREET

WELLINGTON JUTE MILL

HOOGLHY RIVER

HOOGLHY RIVER

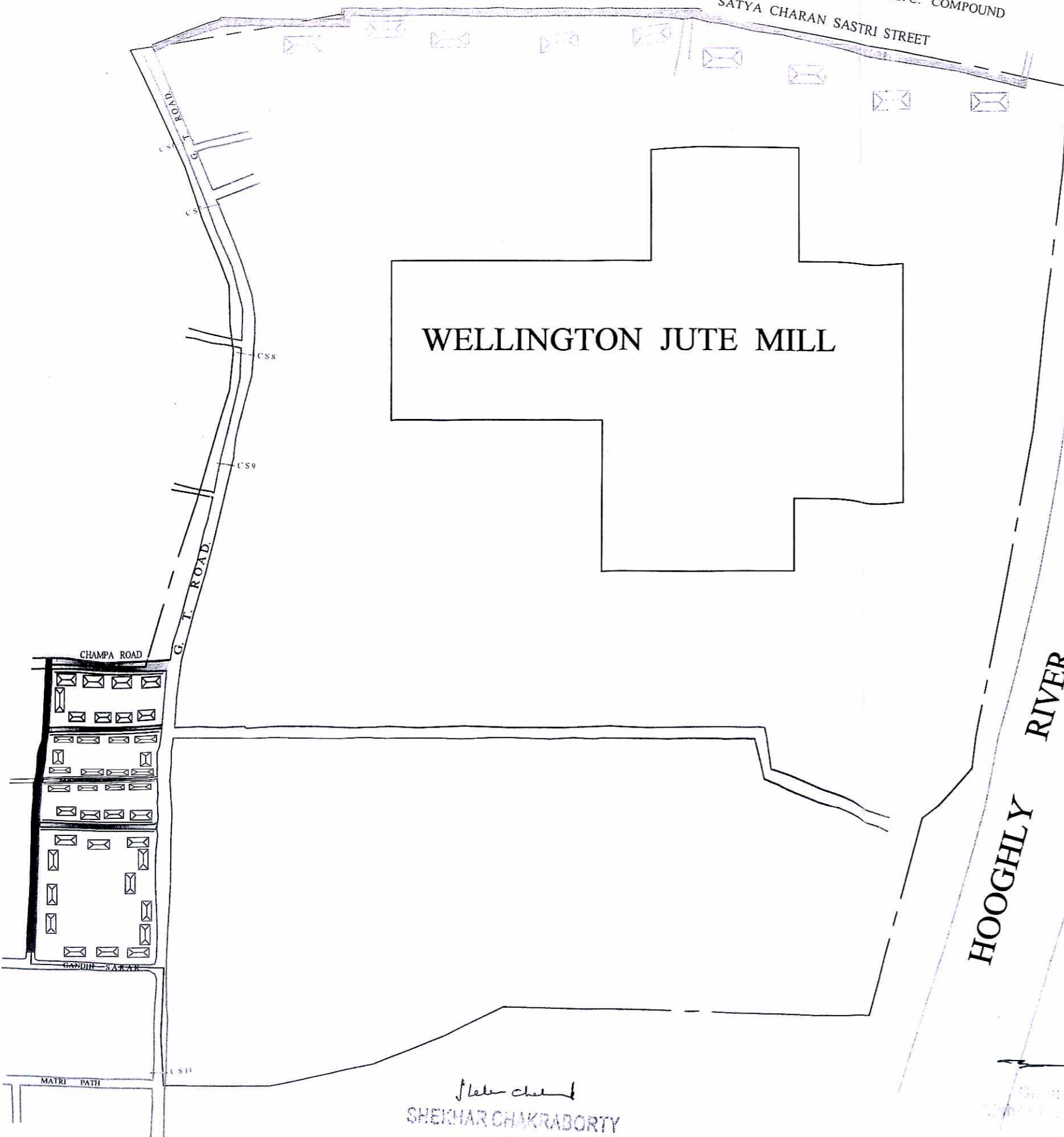

RISHRA BUSTEE 1 (SC-001)

LEGEND

SL. NO.	PARTICULARS	SYMBOLS	
		EXISTING	PROPOSED
1	SLUM BOUNDARY		
2	BLACK TOP ROAD		
3	CONCRETE ROAD		
4	DRAIN		
5	SEMI PUCCA & KUTCHA HOUSES		

Shekhar Chakraborty
SHEKHAR CHAKRABORTY
S.A.E.

RISHRA MUNICIPALITY



SHRIRAMPORE

MUNICIPALITY

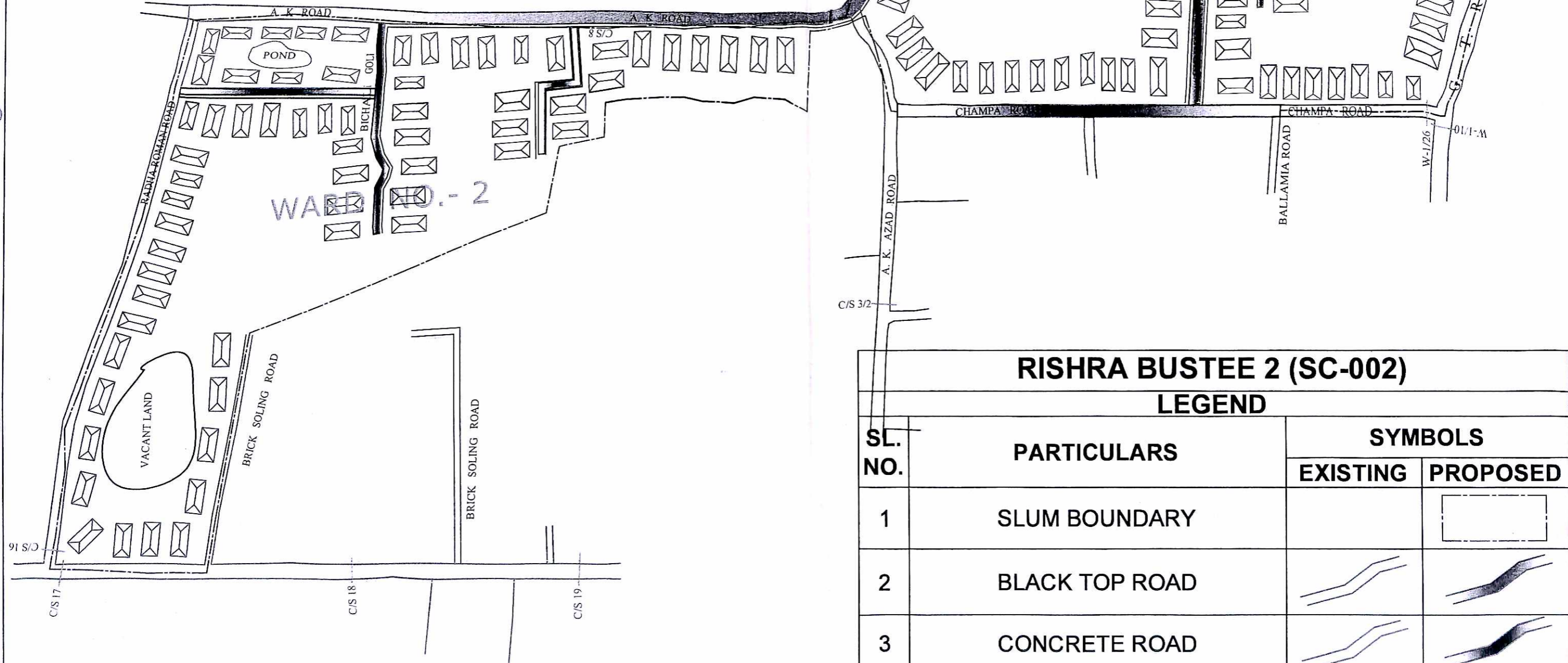

RISHRA BUSTEE 2 (SC-002)

LEGEND

SL. NO.	PARTICULARS	SYMBOLS	
		EXISTING	PROPOSED
1	SLUM BOUNDARY		
2	BLACK TOP ROAD		
3	CONCRETE ROAD		
4	DRAIN		
5	SEMI PUCCA & KUTCHA HOUSES		

Shekhar Chakraborty
SHEKHAR CHAKRABORTY
S.A.E
 RISHRA MUNICIPALITY

Chakraborty
 Rishra Municipality

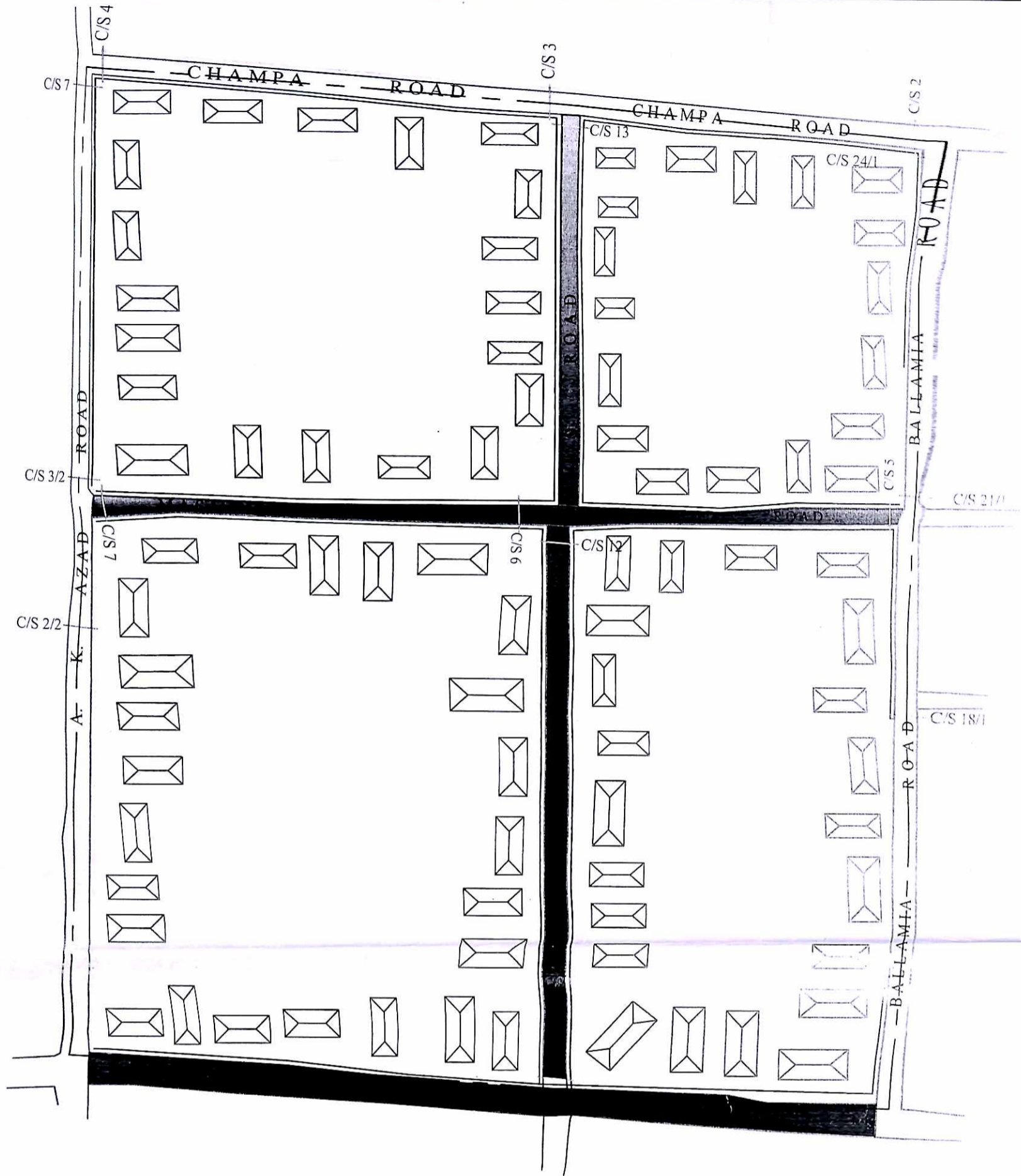

RISHRA BUSTEE 3 (SC-003)

LEGEND

SL. NO.	PARTICULARS	SYMBOLS	
		EXISTING	PROPOSED
1	SLUM BOUNDARY		
2	BLACK TOP ROAD		
3	CONCRETE ROAD		
4	DRAIN		
5	SEMI PUCCA & KUTCHA HOUSES		