

Pre-primary School	
Anganwadi under ICDS	Within distance less than 1 km
Municipal Pre-school	NA
Private Pre-school	NA
Primary School	
Municipal	NA
State Government	Within distance less than 0.5 km
Private	NA
High School	
Municipal	NA
Private	NA
State Government	Within distance less than 0.5 km
Adult Education Centre	NA
Health Facilities	NA
Urban Health Post	NA
Primary Health Centre	NA
Government Hospital	Within distance less than 10 km
Maternity Centre	Within distance less than 1 km
Private Clinic	NA
Registered Medical Practitioner (RMP)	NA
Ayurvedic Doctor/Vaidya	NA
Social Development/Welfare	NA
Community Hall	NA

Livelihood/Production Centre	NA
Vocational Training/Training cum Production Centre	NA
Street Children Rehabilitation Centre	NA
Night Shelter	NA
Old Age Home	NA
Self Help Groups/DWCUA Groups in Slum	NA
No. of Neighbourhood Groups (NHGs) in slum	NA
Slum-dwellers Association	NA
Youth Association	1
Women's Association/Mahila Samities	NA

19. JANATA ROAD [S.C. 039], WARD NO. 8

Education & Social Infrastructure	
Pre-primary School	
Anganwadi under ICDS	Within distance less than 1 km
Municipal Pre-school	NA
Private Pre-school	NA
Primary School	
Municipal	NA
State Government	Within distance less than 0.5 km
Private	NA
High School	
Municipal	NA

Private	NA
State Government	Within distance less than 0.5 km.
Adult Education Centre	NA
Health Facilities	NA
Urban Health Post	NA
Primary Health Centre	NA
Government Hospital	Within distance less than 10 km
Maternity Centre	Within distance less than 1 km
Private Clinic	NA
Registered Medical Practitioner (RMP)	NA
Ayurvedic Doctor/Vaidya	NA
Social Development/Welfare	NA
Community Hall	NA
Livelihood/Production Centre	NA
Vocational Training/Training cum Production Centre	NA
Street Children Rehabilitation Centre	NA
Night Shelter	NA
Old Age Home	NA
Self Help Groups/DWCUA Groups in Slum	NA
No. of Neighbourhood Groups (NHGs) in slum	NA
Slum-dwellers Association	NA
Youth Association	1
Women's Association/Mahila Samities	NA

20. CHASIPARA-2 [S.C. 007], WARD NO. 9

Education & Social Infrastructure	
Pre-primary School	
Anganwadi under ICDS	Within distance less than 1 km
Municipal Pre-school	NA
Private Pre-school	NA
Primary School	
Municipal	NA
State Government	Within distance less than 0.5 km
Private	NA
High School	
Municipal	NA
Private	NA
State Government	Within distance less than 0.5 km
Adult Education Centre	NA
Health Facilities	NA
Urban Health Post	NA
Primary Health Centre	NA
Government Hospital	Within distance less than 10 km
Maternity Centre	Within distance less than 2 km
Private Clinic	NA
Registered Medical Practitioner (RMP)	NA

Ayurvedic Doctor/Vaidya	NA
Social Development/Welfare	NA
Community Hall	NA
Livelihood/Production Centre	NA
Vocational Training/Training cum Production Centre	NA
Street Children Rehabilitation Centre	NA
Night Shelter	NA
Old Age Home	NA
Self Help Groups/DWCUA Groups in Slum	NA
No. of Neighbourhood Groups (NHGs) in slum	NA
Slum-dwellers Association	NA
Youth Association	1
Women's Association/Mahila Samithis	NA

21. SOUTH MASUNDA [S.C. 027], WARD NO. 10

Education & Social Infrastructure	
Pre-primary School	
Anganwadi under ICDS	Within distance less than 1 km
Municipal Pre-school	NA
Private Pre-school	NA
Primary School	
Municipal	NA
State Government	Within distance less than 0.5 km

Private	NA
High School	
Municipal	NA
Private	NA
State Government	Within distance less than 0.5 km
Adult Education Centre	NA
Health Facilities	NA
Urban Health Post	NA
Primary Health Centre	NA
Government Hospital	Within distance less than 10 km
Maternity Centre	Within distance less than 1 km
Private Clinic	NA
Registered Medical Practitioner (RMP)	NA
Ayurvedic Doctor/Vaidya	NA
Social Development/Welfare	NA
Community Hall	NA
Livelihood/Production Centre	NA
Vocational Training/Training cum Production Centre	NA
Street Children Rehabilitation Centre	NA
Night Shelter	NA
Old Age Home	NA
Self Help Groups/DWCUA Groups in Slum	NA
No. of Neighbourhood Groups (NHGs) in slum	NA

Slum-dwellers Association	NA
Youth Association	No
Women's Association/Mahila Samities	NA

22. SOUTH MASUNDA [S.C. 027], WARD NO. 10

Education & Social Infrastructure	
Pre-primary School	
Anganwadi under ICDS	Within distance less than 1 km
Municipal Pre-school	NA
Private Pre-school	NA
Primary School	
Municipal	NA
State Government	Within distance less than 0.5 km
Private	NA
High School	
Municipal	NA
Private	NA
State Government	Within distance less than 0.5 km
Adult Education Centre	NA
Health Facilities	NA
Urban Health Post	NA
Primary Health Centre	NA
Government Hospital	Within distance less than 10 km

Maternity Centre	Within distance less than 1 km
Private Clinic	NA
Registered Medical Practitioner (RMP)	NA
Ayurvedic Doctor/Vaidya	NA
Social Development/Welfare	NA
Community Hall	NA
Livelihood/Production Centre	NA
Vocational Training/Training cum Production Centre	NA
Street Children Rehabilitation Centre	NA
Night Shelter	NA
Old Age Home	NA
Self Help Groups/DWCUA Groups in Slum	NA
No. of Neighbourhood Groups (NHGs) in slum	NA
Slum-dwellers Association	NA
Youth Association	1
Women's Association/Mahila Samities	NA

23. LOWLAND BUSTEE-2 [S.C. 024], WARD NO. 11

Education & Social Infrastructure	
Pre-primary School	
Anganwadi under ICDS	Within distance less than 1 km
Municipal Pre-school	NA
Private Pre-school	NA

Primary School	
Municipal	NA
State Government	Within distance less than 0.5 km
Private	NA
High School	
Municipal	NA
Private	NA
State Government	Within distance less than 0.5 km
Adult Education Centre	NA
Health Facilities	NA
Urban Health Post	NA
Primary Health Centre	NA
Government Hospital	Within distance less than 10 km
Maternity Centre	Within distance less than 1 km
Private Clinic	NA
Registered Medical Practitioner (RMP)	NA
Ayurvedic Doctor/Vaidya	NA
Social Development/Welfare	NA
Community Hall	NA
Livelihood/Production Centre	NA
Vocational Training/Training cum Production Centre	NA
Street Children Rehabilitation Centre	NA
Night Shelter	NA

Old Age Home	NA
Self Help Groups/DWCUA Groups in Slum	NA
No. of Neighbourhood Groups (NHGs) in slum	NA
Slum-dwellers Association	NA
Youth Association	1
Women's Association/Mahila Samithis	NA

24. SABJIBAGAN [S.C. 019], WARD NO. 13

Education & Social Infrastructure	
Pre-primary School	
Anganwadi under ICDS	Within distance less than 1 km
Municipal Pre-school	NA
Private Pre-school	NA
Primary School	
Municipal	NA
State Government	Within distance less than 0.5 km
Private	NA
High School	
Municipal	NA
Private	NA
State Government	Within distance less than 0.5 km
Adult Education Centre	NA
Health Facilities	NA

Urban Health Post	NA
Primary Health Centre	NA
Government Hospital	Within distance less than 10 km
Maternity Centre	Within distance less than 1 km
Private Clinic	NA
Registered Medical Practitioner (RMP)	NA
Ayurvedic Doctor/Vaidya	NA
Social Development/Welfare	NA
Community Hall	NA
Livelihood/Production Centre	NA
Vocational Training/Training cum Production Centre	NA
Street Children Rehabilitation Centre	NA
Night Shelter	NA
Old Age Home	NA
Self Help Groups/DWCUA Groups in Slum	NA
No. of Neighbourhood Groups (NHGs) in slum	NA
Slum-dwellers Association	NA
Youth Association	No
Women's Association/Mahila Samities	NA

25. AUROBINDA BUSTEE [S.C. 040], WARD NO. 14

Education & Social Infrastructure	
Pre-primary School	
Anganwadi under ICDS	Within distance less than 1 km
Municipal Pre-school	NA
Private Pre-school	NA
Primary School	
Municipal	NA
State Government	Within distance less than 0.5 km
Private	NA
High School	
Municipal	NA
Private	NA
State Government	Within distance less than 0.5 km
Adult Education Centre	NA
Health Facilities	NA
Urban Health Post	NA
Primary Health Centre	NA
Government Hospital	Within distance less than 10 km
Maternity Centre	Within distance less than 2 km
Private Clinic	NA
Registered Medical Practitioner (RMP)	NA
Ayurvedic Doctor/Vaidya	NA

Social Development/Welfare	NA
Community Hall	NA
Livelihood/Production Centre	NA
Vocational Training/Training cum Production Centre	NA
Street Children Rehabilitation Centre	NA
Night Shelter	NA
Old Age Home	NA
Self Help Groups/DWCUA Groups in Slum	NA
No. of Neighbourhood Groups (NHGs) in slum	NA
Slum-dwellers Association	NA
Youth Association	1
Women's Association/Mahila Samities	NA

26. SABJIBAGAN NO. 2 [S.C. 022], WARD NO. 14

Education & Social Infrastructure	
Pre-primary School	
Anganwadi under ICDS	Within distance less than 1 km
Municipal Pre-school	NA
Private Pre-school	NA
Primary School	
Municipal	NA
State Government	Within distance less than 0.5 km
Private	NA

High School	
Municipal	NA
Private	NA
State Government	Within distance less than 0.5 km
Adult Education Centre	NA
Health Facilities	NA
Urban Health Post	NA
Primary Health Centre	NA
Government Hospital	Within distance less than 10 km
Maternity Centre	Within distance less than 2 km
Private Clinic	NA
Registered Medical Practitioner (RMP)	NA
Ayurvedic Doctor/Vaidya	NA
Social Development/Welfare	NA
Community Hall	NA
Livelihood/Production Centre	NA
Vocational Training/Training cum Production Centre	NA
Street Children Rehabilitation Centre	NA
Night Shelter	NA
Old Age Home	NA
Self Help Groups/DWCUA Groups in Slum	NA
No. of Neighbourhood Groups (NHGs) in slum	NA
Slum-dwellers Association	NA

Youth Association	No
Women's Association/Mahila Samithis	NA

27. SABJIBAGAN [S. C. 018], WARD NO. 16

Education & Social Infrastructure

Pre-primary School	
Anganwadi under ICDS	Within distance less than 1 km
Municipal Pre-school	NA
Private Pre-school	NA
Primary School	
Municipal	NA
State Government	Within distance less than 0.5 km
Private	NA
High School	
Municipal	NA
Private	NA
State Government	Within distance less than 0.5 km
Adult Education Centre	NA
Health Facilities	NA
Urban Health Post	NA
Primary Health Centre	NA
Government Hospital	Within distance less than 10 km
Maternity Centre	NA
Private Clinic	NA

New Barrackpore Municipality-Housing for All -DPR (2015-16)

Registered Medical Practitioner (RMP)	NA
Ayurvedic Doctor/Vaidya	NA
Social Development/Welfare	NA
Community Hall	NA
Livelihood/Production Centre	NA
Vocational Training/Training cum Production Centre	NA
Street Children Rehabilitation Centre	NA
Night Shelter	NA
Old Age Home	NA
Self Help Groups/DWCUA Groups in Slum	NA
No. of Neighbourhood Groups (NHGs) in slum	NA
Slum-dwellers Association	NA
Youth Association	1
Women's Association/Mahila Samithis	NA

11. SABJIBASAN [S. C. 020], WARD NO. 17

Education & Social Infrastructure

Pre-primary School	
Anganwadi under ICDS	Within distance less than 1 km
Municipal Pre-school	NA
Private Pre-school	NA
Primary School	
Municipal	NA
State Government	Within distance less than 0.5 km

Private	NA
High School	
Municipal	NA
Private	NA
State Government	Within distance less than 0.5 km
Adult Education Centre	NA
Health Facilities	NA
Urban Health Post	NA
Primary Health Centre	NA
Government Hospital	Within distance less than 10 km
Maternity Centre	Within distance less than 2 km
Private Clinic	NA
Registered Medical Practitioner (RMP)	NA
Ayurvedic Doctor/Vaidya	NA
Social Development/Welfare	NA
Community Hall	NA
Livelihood/Production Centre	NA
Vocational Training/Training cum Production Centre	NA
Street Children Rehabilitation Centre	NA
Night Shelter	NA
Old Age Home	NA
Self Help Groups/DWCUA Groups in Slum	NA
No. of Neighbourhood Groups (NHGs) in slum	NA

Slum-dwellers Association	NA
Youth Association	1
Women's Association/Mahila Samithis	NA

28. LICHUBAGAN [S. C. 017], WARD NO. 17

Education & Social Infrastructure	
Pre-primary School	
Anganwadi under ICDS	Within distance less than 1 km
Municipal Pre-school	NA
Private Pre-school	NA
Primary School	
Municipal	NA
State Government	Within distance less than 0.5 km
Private	NA
High School	
Municipal	NA
Private	NA
State Government	Within distance less than 0.5 km
Adult Education Centre	NA
Health Facilities	NA
Urban Health Post	NA
Primary Health Centre	NA
Government Hospital	Within distance less than 10 km
Maternity Centre	NA

Private Clinic	NA
Registered Medical Practitioner (RMP)	NA
Ayurvedic Doctor/Vaidya	NA
Social Development/Welfare	NA
Community Hall	NA
Livelihood/Production Centre	NA
Vocational Training/Training cum Production Centre	NA
Street Children Rehabilitation Centre	NA
Night Shelter	NA
Old Age Home	NA
Self Help Groups/DWCUA Groups in Slum	NA
No. of Neighbourhood Groups (NHGs) in slum	NA
Slum-dwellers Association	NA
Youth Association	1
Women's Association/Mahila Samities	NA

29: TALPUKURPARA [S. C. 021], WARD NO. 18

Education & Social Infrastructure	
Pre-primary School	
Anganwadi under ICDS	Within distance less than 1 km
Municipal Pre-school	NA
Private Pre-school	NA
Primary School	
Municipal	NA

New Barrackpore Municipality-Housing for All -DPR (2015-16)

State Government	Within distance less than 0.5 km
Private	NA
High School	
Municipal	NA
Private	NA
State Government	Within distance less than 0.5 km
Adult Education Centre	NA
Health Facilities	NA
Urban Health Post	NA
Primary Health Centre	NA
Government Hospital	Within distance less than 10 km
Maternity Centre	Within distance less than 2 km
Private Clinic	NA
Registered Medical Practitioner (RMP)	NA
Ayurvedic Doctor/Vaidya	NA
Social Development/Welfare	NA
Community Hall	NA
Livelihood/Production Centre	NA
Vocational Training/Training cum Production Centre	NA
Street Children Rehabilitation Centre	NA
Night Shelter	NA
Old Age Home	NA
Self Help Groups/DWCUA Groups in Slum	NA

S. S. S. S. S.

New Barrackpore Municipality-Housing for All -DPR (2015-16)

L. S. S. S. S.

M. S. S. S. S.

G. S. S. S. S.

No. of Neighbourhood Groups (NHGs) in slum	NA
Slum-dwellers Association	NA
Youth Association	1
Women's Association/Mahila Samithis	NA

30. BANSBAGAN NO. 2 [S.C. 016], WARD NO. 19

Education & Social Infrastructure	
Pre-primary School	
Anganwadi under ICDS	Within distance less than 1 km
Municipal Pre-school	NA
Private Pre-school	NA
Primary School	
Municipal	NA
State Government	Within distance less than 0.5 km
Private	NA
High School	
Municipal	NA
Private	NA
State Government	Within distance less than 0.5 km
Adult Education Centre	NA
Health Facilities	NA
Urban Health Post	NA
Primary Health Centre	NA

Government Hospital	Within distance less than 10 km
Maternity Centre	NA
Private Clinic	NA
Registered Medical Practitioner (RMP)	NA
Ayurvedic Doctor/Vaidya	NA
Social Development/Welfare	NA
Community Hall	NA
Livelihood/Production Centre	NA
Vocational Training/Training cum Production Centre	NA
Street Children Rehabilitation Centre	NA
Night Shelter	NA
Old Age Home	NA
Self Help Groups/DWCUA Groups in Slum	NA
No. of Neighbourhood Groups (NHGs) in slum	NA
Slum-dwellers Association	NA
Youth Association	1
Women's Association/Mahila Samithis	NA

31. CHASIPARA NO.1 [S.C. 010], WARD NO. 20

Education & Social Infrastructure	
Pre-primary School	
Anganwadi under ICDS	Within distance less than 1 km
Municipal Pre-school	NA
Private Pre-school	NA

New Barrackpore Municipality-Housing for All -DPR (2015-16)

Primary School	
Municipal	NA
State Government	Within distance less than 0.5 km
Private	NA
High School	
Municipal	NA
Private	NA
State Government	Within distance less than 0.5 km
Adult Education Centre	NA
Health Facilities	NA
Urban Health Post	NA
Primary Health Centre	NA
Government Hospital	Within distance less than 10 km
Maternity Centre	Within distance less than 2 km
Private Clinic	NA
Registered Medical Practitioner (RMP)	NA
Ayurvedic Doctor/Vaidya	NA
Social Development/Welfare	NA
Community Hall	NA
Livelihood/Production Centre	NA
Vocational Training/Training cum Production Centre	NA
Street Children Rehabilitation Centre	NA
Night Shelter	NA

Old Age Home	NA
Self Help Groups/DWCUA Groups in Slum	NA
No. of Neighbourhood Groups (NHGs) in slum	NA
Slum-dwellers Association	NA
Youth Association	1
Women's Association/Mahila Samithis	NA

32. CHASIPARA NO.3 [S.C. 011], WARD NO. 20

Education & Social Infrastructure	
Pre-primary School	
Anganwadi under ICDS	Within distance less than 1 km
Municipal Pre-school	NA
Private Pre-school	NA
Primary School	
Municipal	NA
State Government	Within distance less than 0.5 km
Private	NA
High School	
Municipal	NA
Private	NA
State Government	Within distance less than 0.5 km
Adult Education Centre	NA
Health Facilities	NA
Urban Health Post	NA

Primary Health Centre	NA
Government Hospital	Within distance less than 10 km
Maternity Centre	Within distance less than 2 km
Private Clinic	NA
Registered Medical Practitioner (RMP)	NA
Ayurvedic Doctor/Vaidya	NA
Social Development/Welfare	NA
Community Hall	NA
Livelihood/Production Centre	NA
Vocational Training/Training cum Production Centre	NA
Street Children Rehabilitation Centre	NA
Night Shelter	NA
Old Age Home	NA
Self Help Groups/DWCUA Groups in Slum	NA
No. of Neighbourhood Groups (NHGs) in slum	NA
Slum-dwellers Association	NA
Youth Association	1
Women's Association/Mahila Samithis	NA

Fig 133. FATESHA BUSTEE-2 [S.C. 013], WARD NO. 20

Education & Social Infrastructure	
Pre-primary School	
Anganwadi under ICDS	Within distance less than 1 km
Municipal Pre-school	NA

New Barrackpore Municipality-Housing for All -DPR (2015-16)

Private Pre-school	NA
Primary School	
Municipal	NA
State Government	Within distance less than 0.5 km
Private	NA
High School	
Municipal	NA
Private	NA
State Government	Within distance less than 0.5 km
Adult Education Centre	NA
Health Facilities	NA
Urban Health Post	NA
Primary Health Centre	NA
Government Hospital	Within distance less than 10 km
Maternity Centre	Within distance less than 5 km
Private Clinic	NA
Registered Medical Practitioner (RMP)	NA
Ayurvedic Doctor/Vaidya	NA
Social Development/Welfare	NA
Community Hall	NA
Livelihood/Production Centre	NA
Vocational Training/Training cum Production Centre	NA
Street Children Rehabilitation Centre	NA

New Barrackpore Municipality-Housing for All -DPR (2015-16)

Night Shelter	NA
Old Age Home	NA
Self Help Groups/DWCUA Groups in Slum	NA
No. of Neighbourhood Groups (NHGs) in slum	NA
Slum-dwellers Association	NA
Youth Association	1
Women's Association/Mahila Samithis	NA

34. FATESHA BUSTEE-2 [S.C. 013], WARD NO. 20

Education & Social Infrastructure	
Pre-primary School	
Anganwadi under ICDS	Within distance less than 1 km
Municipal Pre-school	NA
Private Pre-school	NA
Primary School	
Municipal	NA
State Government	Within distance less than 0.5 km
Private	NA
High School	
Municipal	NA
Private	NA
State Government	Within distance less than 0.5 km
Adult Education Centre	NA
Health Facilities	NA

Urban Health Post	NA
Primary Health Centre	NA
Government Hospital	Within distance less than 10 km
Maternity Centre	Within distance less than 2 km
Private Clinic	NA
Registered Medical Practitioner (RMP)	NA
Ayurvedic Doctor/Vaidya	NA
Social Development/Welfare	NA
Community Hall	NA
Livelihood/Production Centre	NA
Vocational Training/Training cum Production Centre	NA
Street Children Rehabilitation Centre	NA
Night Shelter	NA
Old Age Home	NA
Self Help Groups/DWCUA Groups in Slum	NA
No. of Neighbourhood Groups (NHGs) in slum	NA
Slum-dwellers Association	NA
Youth Association	1
Women's Association/Mahila Samithis	NA

35. MADHYAPARA [S.C. 014] WARD NO. 20

Education & Social Infrastructure	
Pre-primary School	

New Barrackpore Municipality-Housing for All -DPR (2015-16)

Anganwadi under ICDS	2
Municipal Pre-school	No
Private Pre-school	No
Municipal Primary School	No
State Government	1
Private Primary School	No
Municipal	No
Private	No
State Government	1
Adult Education Centre	No
Health Facilities	No
Urban Health Post	1
Primary Health Centre	No
Government Hospital	No
Maternity Centre	Within distance less than 2 km
Private Clinic	No
Registered Medical Practitioner (RMP)	No
Ayurvedic Doctor/Vaidya	No
Social Development/Welfare	No
Community Hall	No
Livelihood/Production Centre	No

Go. no. 2

New Barrackpore Municipality-Housing for All -DPR (2015-16)

Pri. A.C.

Reg. no.

Ay. no.

Vocational Training/Training cum Production Centre	No
Street Children Rehabilitation Centre	No
Night Shelter	No
Old Age Home	No
Self Help Groups/DWCUA Groups in Slum	2
No. of Neighbourhood Groups (NHGs) in slum	2
Slum-dwellers Association	No
Youth Association	No
Women's Association/Mahila Samithis	No

36. . BANSBAGAN No. 2 [S.C. 015] WARD NO. 20

Education & Social Infrastructure	
Pre-primary School	
Anganwadi under ICDS	1
Municipal Pre-school	No
Private Pre-school	No
Primary School	
Municipal	No
State Government	Within distance less than 0.5 km
Private	No
High School	
Municipal	No
Private	No
State Government	Within distance less than 0.5 km
Adult Education Centre	No
Health Facilities	No
Urban Health Post	1
Primary Health Centre	No
Government Hospital	Within distance less than 10 km
Maternity Centre	Within distance less than 2 km
Private Clinic	No
Registered Medical Practitioner (RMP)	No

New Barrackpore Municipality-Housing for All -DPR (2015-16)

Ayurvedic Doctor/Vaidya	No
Social Development/Welfare	No
Community Hall	Within distance less than 0.5 km
Livelihood/Production Centre	1
Vocational Training/Training cum Production Centre	No
Street Children Rehabilitation Centre	No
Night Shelter	No
Old Age Home	No
Self Help Groups/DWCUA Groups in Slum	1
No. of Neighbourhood Groups (NHGs) in slum	1
Slum-dwellers Association	No
Youth Association	1
Women's Association/Mahila Samithis	No

Work flow of PMAY – HFA (U) for 2017-18

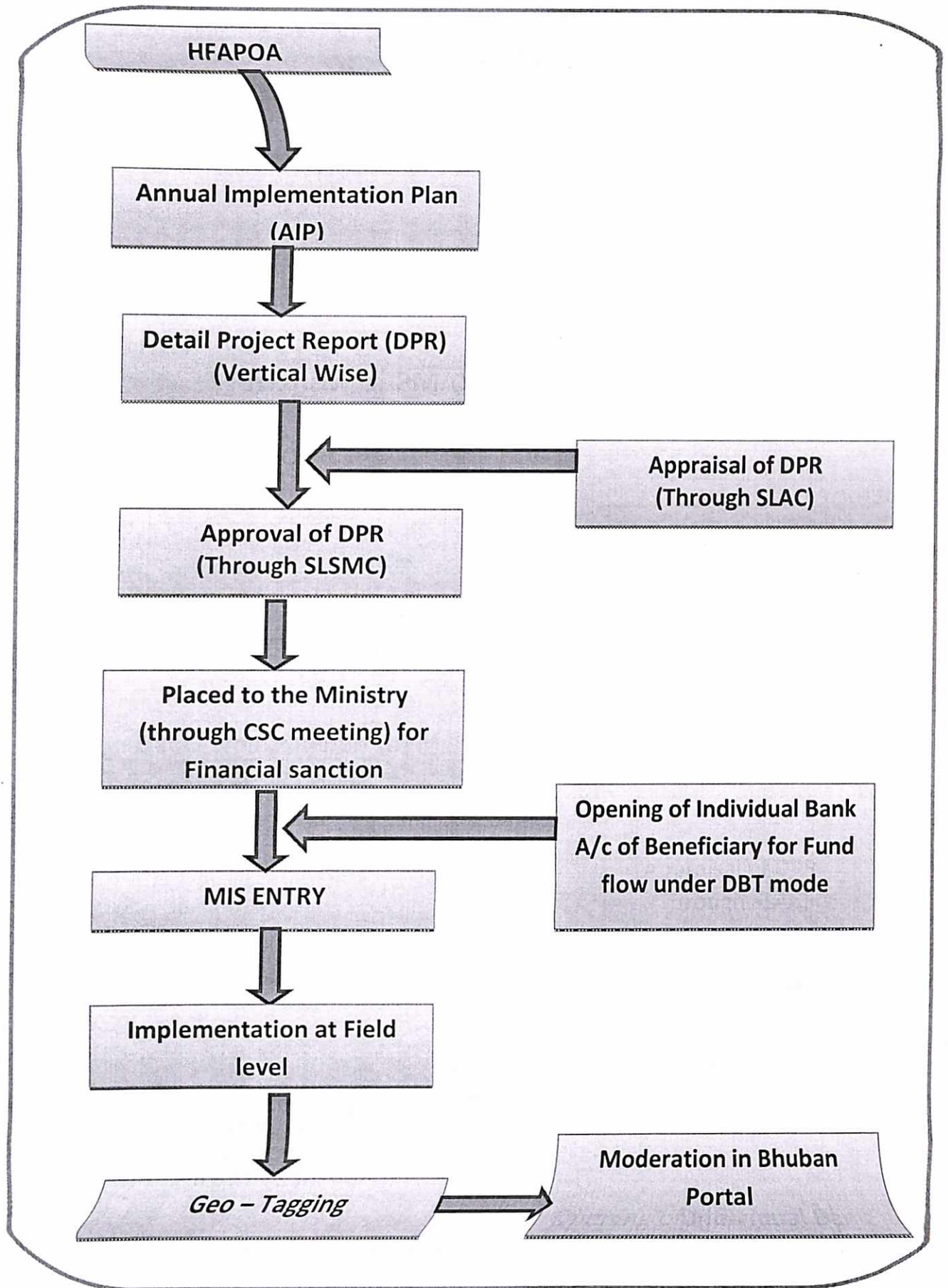

Annexure 7C

(Para 14.5 of the Guidelines)

Format for Project under Beneficiary Led Construction Or Enhancement

1	Name of the State:	:	West Bengal						
2	Name of the District:	:	North 24 Parganas						
3	Name of the City:	:	New Barrackpore						
	Project Name:	:	HFA-NEW BARRACKPORE 2017-18						
5	Project Code:	:	19801709034N0						
6	State Level Nodal Agency:	:	State Urban Development Agency (SUDA)						
7	Implementing Agency/ ULB	:	New Barrackpore Municipality						
	Date of Approval by State Level Sanctioning and Monitoring Committee (SLSMC)	:							
9	No. of location covered in project: No of Slum Area Covered & No of Non Slum Area Covered	:	Name of Location	No. of beneficiaries	Whether Slum / Non-Slum	If Slum, then Slum type	If slum, whether it gets completely rehabilitated		
		:	New Barrackpore Municipal Area	465	Covering both Slum & Non-Slum area	Notified	No		
	Project Cost (Rs. In Lakhs)	:	1882.32						
11	No. of beneficiaries covered in the project	:	GEN	SC	ST	OBC	Total	Minority	Person with Disability
		:	290	139	2	34	465	Nil	Nil
12	Whether beneficiary have been selected as PMAY Guidelines?	:	Yes						
13	No. of Houses constructed / acquired. Please specify ownership (Any of these)	:	Joint	Female	Male	Transgender			
		:	310	155		Nil			
14	No. of beneficiaries covered in the project	:	Male	Female	Transgender				
		:	279	186	Nil				
	Whether it has been ensured that selected beneficiaries have rightful ownership of the land ?	:	Yes						
16	Whether building plan for all houses have been Approved?	:	Yes						

17	i. GoI grant required (Rs. 1.5 lakh per eligible beneficiary) (Rs. in Lakhs) :	697.5
	ii. State grant, (Rs. in Lakhs) :	983.01
	iii. ULB grant (Rs. in Lakhs) :	85.56
	iv. Beneficiary Share (Rs. in Lakhs) :	116.25
	v. Total (Rs. in Lakhs) :	1882.32
18	Whether technical specification / design for housing have been ensured as per Indian Standards / NBC/ State Norms? :	Yes
19	Whether it has been ensured that balance cost of construction is tied up with State Grant, ULB Grant & Beneficiary Share ? :	Yes
	Whether trunk and line infrastructure is existing or being provisioned ? :	
	i. Water Supply :	Yes
	ii. Sewerage :	No
	iii. Road :	Yes
	iv. Storm Water Drain :	Yes
	v. External Electrification :	Yes
	vi. Solid Waste Management :	Yes
	vii. Any Other :	No
	viii. In case, any infrastructure has not been proposed, reason thereof. :	Sewerage scheme has not been proposed due to desired level of supply of water as CPHEEO norm has not been achieved.
20	Whether disaster (earthquake, flood, cyclone, landslide etc.) resistant features have been adopted in concept, design and implementation of the project ? :	Yes
21	Whether Demand Survey Completed for entire city ? :	Yes
22	Whether City-wide integrated project have been formulated ? If not reasons thereof ? :	Yes
	Whether validation with SECC data for housing condition conducted ? :	Yes
	Whether Direct Benefit Transfer (DBT) of fund to individual bank account of beneficiary ensured in the project ? :	Yes

25	Whether there is provision in DPR for tracking/monitoring the progress of individual houses through geo-tagged photographs ?	Yes
26	Whether any innovation/cost effective / Green technology adopted in the project?	Yes
27	Comments of SLAC after techno economic appraisal of DPR	Project covers the most needy beneficiaries
28	Project brief including any other information ULB/State would like to furnish	The project covers all wards
	Project Submission Date to SLSMC	

is hereby confirmed that State/UT and ULB have checked all the beneficiaries as per guidelines of HFA. It is also submitted that no beneficiary has been selected for more than one benefit under the Mission including Credit Linked Subsidy Scheme (CLSS) component of the Mission.



Signature of the
Mayor/ Chairperson/Municipal Commissioner

TRIPTI MAJUMDER
CHAIRPERSON
New Barrackpore Municipality

Signature
Chief Engineer
M.E Dte,GoWB

Signature

(Director,SUDA)

Signature

(Secretary,UD & MA Department,GoWB)

AIP Tables**Annexure 6**

(Para 8.6 & Para 14.4 of the Guidelines)

Summary Sheet for Annual Implementation Plan (AIP) for the Year 2017-18

District:	North 24 Parganas					
Name of the ULB:	New Barrackpore					
Admissible Component	Target for the Year 2015-16	Achievement for the Year 2015-16	Target for the Year 2016-17	Achievement for the Year 2016-17	Target for the Year 2017-18	Remaining Target as per HFAPoA
A. Beneficiary Led Construction						
• New Houses	208	208	797	797	465	1712
• Enhancement	Nil	Nil	Nil	Nil	Nil	Nil
• Sub Total (A)	208	208	797	797	465	1712
B. In-situ Slum Rehabilitation with participation of Private Sector						
• Number of Slums	Nil	Nil	Nil	Nil	Nil	Nil
• Number of Households (B)	Nil	Nil	Nil	Nil	Nil	Nil
C. Affordable Housing in Partnership (EWS Category) (C)	Nil	Nil	Nil	Nil	Nil	Nil
D. Credit Linked Subsidy						
• EWS Households	Nil	Nil	Nil	Nil	Nil	Nil
• LIG Households	Nil	Nil	Nil	Nil	Nil	Nil
• Sub Total (D)	Nil	Nil	Nil	Nil	Nil	Nil
E. TOTAL (A+B+C+D)	208	208	797	797	465	1712

TRIPTI MAJUMDER
CHAIRPERSON
New Barrackpore Municipality

IV. Affordable Housing for Weaker Section through Credit Linked Subsidy							
Year *	No. of Slums	Affordable Housing through Credit Linked Subsidy					
		No. of Beneficiaries availed Loan		Resource Mobilisation (Rs in Crores)		Estimated Interest Subsidy Availed	
		EWS	LIG	EWS	LIG	EWS	LIG
2015-16	New Housing	Nil	Nil	Nil	Nil	Nil	Nil
	Enhancement (Existing House)	Nil	Nil	Nil	Nil	Nil	Nil
2016-17	New Housing	Nil	Nil	Nil	Nil	Nil	Nil
	Enhancement (Existing House)	Nil	Nil	Nil	Nil	Nil	Nil
2017-18	New Housing	Nil	Nil	Nil	Nil	Nil	Nil
	Enhancement (Existing House)	Nil	Nil	Nil	Nil	Nil	Nil
2018-19	New Housing						
	Enhancement (Existing House)						
2019-20	New Housing						
	Enhancement (Existing House)						
2020-21	New Housing						
	Enhancement (Existing House)						
2021-22	New Housing						
	Enhancement (Existing House)						
Total		Nil	Nil	Nil	Nil	Nil	Nil



Signature of the
Mayor/ Chairperson/
Municipal Commissioner

TRIPTI MAJUMDER
CHAIRPERSON
New Barrack, Municipality

Signature
(Director, SUDA)

2. WATER SUPPLY										
Internal Pipe Line		465		1572.00	7.31	7.31	0.00	3.65	3.65	0.00
3 STORM WATER DRAINS										
Total Infrastructure Cost Sub Total (B)					171.12	171.12	0.00	85.56	85.56	0.00
GRAND TOTAL (A+B)					1866.12	1866.12	697.50	983.01	85.56	116.25

Inkalpa Tarafdar

Signature of the ULB level
Competent Technical
Officer

Name & Designation:

Fax No:

Telephone No:

E-mail:

Signature

Director(SUDA)

Name & Designation:

Sri Sutanu Prasad
Kar, IAS, Director, SUDA
033-23585767

Fax No:

Telephone No:

033-23585767

E-mail:

wbsudadir@gmail.com

Signature of the State level
Competent Technical
Officer

Name & Designation: Chief
Engineer, MeDte, GoWB
Bikash Bhavan, South Block, 1st
Floor, Salt lake, Kol-91

Fax No:

033-23375474

Telephone No:

033-23371331

E-mail:

ce_medte@yahoo.
com

Tmm

Signature of the Mayor/
Chairperson/ Municipal
Commissioner

TRIPTI MAJUMDER
CHAIRPERSON
New Barrackpore Municipality

Name & Designation:

Fax No:

Telephone No:

E-mail:

FOUNDATION DETAILS

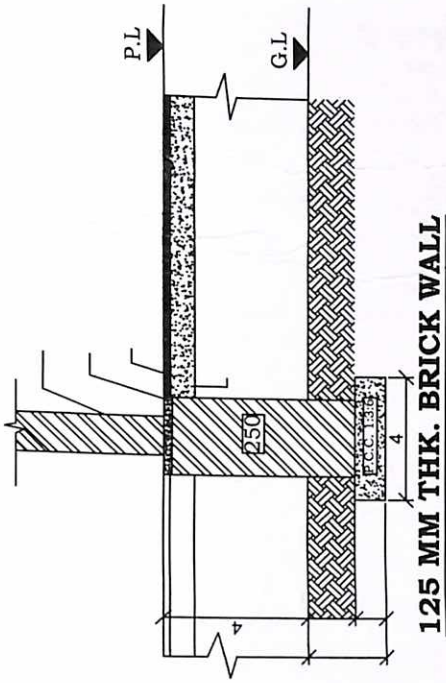

125 MM THK. BRICK WALL

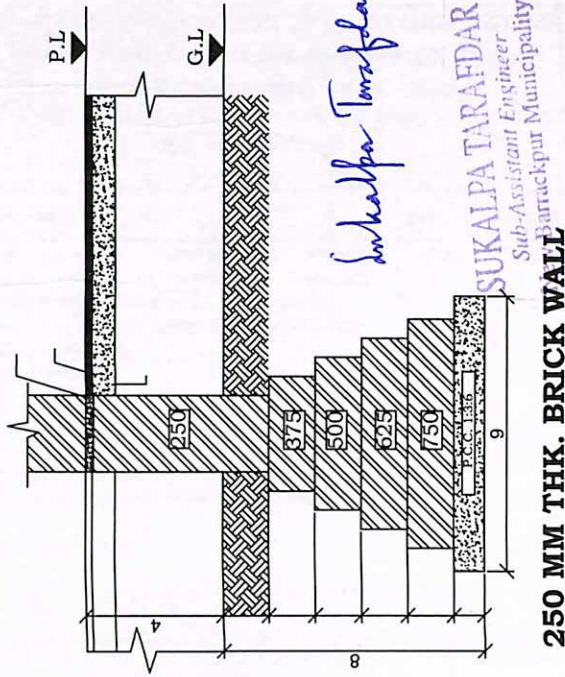

250 MM THK. BRICK WALL

Sukalpa Tarafdar

SUKALPA TARAFDAR
Sub-Assistant Engineer
Barrackpore Municipality

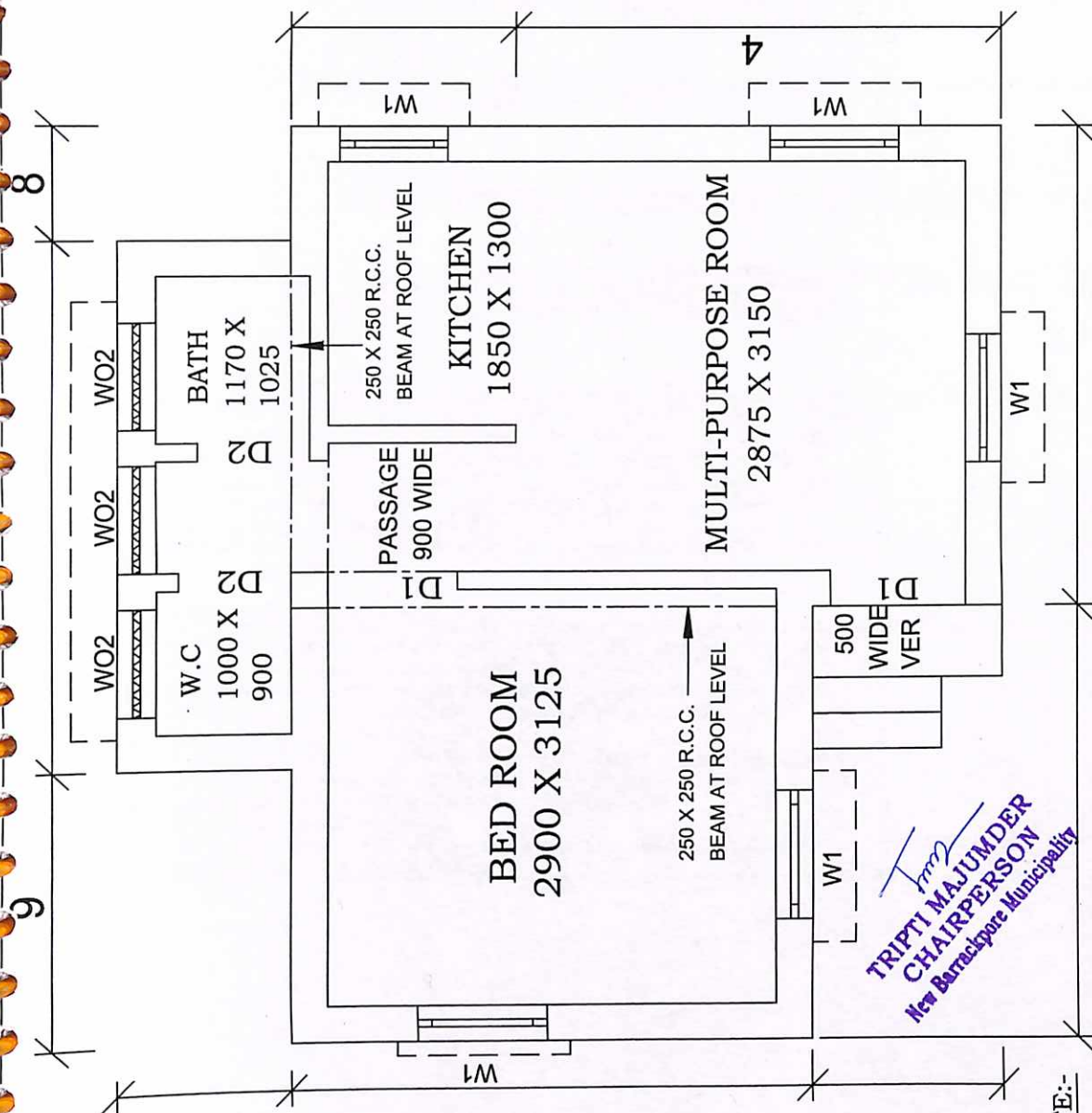

DOORS & WINDOWS SCHEDULE	
MARKING	DIMENSION
W1	900 X 900
W2	750 X 900
W02	750 X 750
D1	900 X 2100
D2	750 X 2100

FLOOR AREA - 25.77 SQM.
BUILT UP AREA - 32.58 SQM.

NOTE:-

1. ALL WINDOW OPENINGS (W1&W2) WILL BE PROVIDED WITH Z-BATTEN SHUTTERS.
2. ALL DOORS (D1&D2) -25TH Z-BATTEN SHUTTERS, SINGLE LEAF.
3. W02 - OPENING PROVIDED WITH R.C.C. JALLI.
4. PLINTH HEIGHT - 450 TH.
5. CEILING HEIGHT - 2750 TH.
6. MAIN WALL - 250 TH.
7. PARTITION WALL - 125 TH.
8. ROOF SLAB, BEAM, LINTEL, ETC. WITH REINFORCED CEMENT CONCRETE M20 GRADE.
9. FLOOR OF VERANDA, WC, BATH, & KITCHEN ROOM TO BE KEPT 15 MM BELOW THE FLOOR LEVEL OF ROOM & PASSAGE.
10. 100 MM TH. PIECE LINTEL OVER OPENING HAVE BEEN PROVIDED.
11. ALL DIMENSION ARE IN MM.

Tripti Majumder
TRIPTI MAJUMDER
CHAIRPERSON
New Barrackpore Municipality

PRADHAN MANTRI AWAS YOJANA
HOUSING FOR ALL (URBAN)
OFFICE OF THE CHIEF ENGINEER
MUNICIPAL ENGINEERING DIRECTORATE
GOVT. OF WEST BENGAL

DWG. NO. _____ SCALE :- 1:50 & 1:25

DETAILED ESTIMATE FOR THE CONSTRUCTION OF SINGLE UNIT DWELLING HOUSE

Pradhan Mantri Awas Yojana Housing For All (Urban)

Total Covered Area- 32.58 sq.m (With Electrical Works)

Reference of Schedule of Rates : PWD (W.B.), Schedule of Rates Building & Sanitary w.e.f-01.07.2014 & Corrigenda

Floor Area 25.77 sqm

SL No.	Description of Works	Quantity	Unit	Rate (Rs.)	Amount (Rs.)
1	Earthwork in excavation in foundation trenches or drains, in all sorts of soil (including mixed soil but excluding laterite or sandstone) Including removing spreading or stacking the spoils within a lead of 75 m as directed including trimming the sides of trenches, levelling, dressing and ramming the bottom, bailing out water etc. as required complete. a) Depth of excavation not exceeding 1500mm . SOR, PWD, P-1, I -2 a	13.000	%cu.m	12047.00	1566.11
2	Earth work in filling in foundation trenches or plinth with good earth in layers not exceeding 150 mm. including watering and ramming etc. layer by layer complete.(Payment to be made on the basis of measurement of finished quantity of work) a) With earth obtained from excavation of foundation. SOR, PWD, P-1, T/3 a	11.120	%cu.m	7831.00	870.81
3	Supplying Laying Polithin Sheets etc. SOR, PWD, P-45, T - 13	22.000	sqm	25.00	550.00
4	Cement concrete with graded Stone ballast (40 mm.) excluding shuttering.a) In ground floor and foundation.6 : 3 : 1 proportion Pakur variety SOR, PWD, Page 24 ; Item -10 a	3.500	cu.m.	5823.00	20380.50
5	25 mm. thick damp proof with cement concrete (4:2:1) (with graded stone aggregate 10 mm. Normal size) and painting the top surface with a coat of bitumen using 1.7 kg. per sq.m. including heating the bitumen and cost and carriage of all materials complete. SOR, PWD, P-45, T-12	6.810	sqm,	297.00	2022.57
6	Brick work with 1st class bricks in cement mortar (6:1) a) In foundation and plinth. b) In super structure SOR, PWD, P-29, T -22(a), (b)	10.430 15.240	cum cum	5719.00 5943.00	59649.17 90571.32
7	125mm thick brick work with 1st. class bricks in cement mortar (4:1). a) In ground floor SOR, PWD, P-73, I -29	23.220	sq.m.	783.00	18181.26
8	Ordinary Cement concrete (mix 1:1.5:3) with graded stone chips (20 mm nominal size) excluding shuttering and reinforcement if any, in ground floor as per relevant IS codes. (i) Pakur Variety SOR, PWD, P-14, T -7(i)	3.940	cu.m.	6851.66	26995.54
9	Reinforcements for reinforced concrete work in all sorts of structures including distribution bars, stirrups, binders etc. including supply of rods, initial straightening and removal of loose rust (if necessary), cutting to requisite length, hooking and bending to correct shape, placing in proper position and binding with 16G black annealed wire at every inter-section, complete as per drawing and direction. (a) For works in foundation, basement and upto roof of ground floor / upto 4m. (i) Tor steel/Mild steel. SOR, PWD, P-27, T -15(i)	0.309	MT	60705.93	18775.74
10	Hire and labour charges for shuttering with centreing and necessary staging upto 4 m. using approved stout props and thick hard wood planks of approved thickness with required bracing for concrete slabs, beams, columns, lintels curved or straight including fitting, fixing and striking out after completion of works. (upto roof of ground floor). (When the height of a particular floor is more than 4 m. the equivalent floor ht. shall be taken as 4 m. and extra for works beyond the initial 4 m. ht. shall be allowed under 12(e) for every 4 m. or part thereof.) SOR. PWD. P-66. T -12(a) 25 mm. to 30 mm. thick wooden shuttering as per decision & direction of Engineer-in-charge. Ground Floor	37.063	M ²	360.00	13342.68

SL No.	Description of Works	Quantity	Unit	Rate (Rs.)	Amount (Rs.)
11	Plaster (to wall, floor, ceiling etc.) with sand and cement mortar including rounding off or chamfering corners as directed and raking out joints or roughening of concrete surface, including throating, nosing and drip course where necessary . In ground floor. A) With 6:1 cement mortar. a) Inside wall 20 mm thick plaster SOR, PWD, P-151, T -2 (i)(b) b) Out side Wall, 15mm th. SOR, PWD, P-151, I -2 (i)(c) B)10mm th ceiling plaster (4:1) SOR, PWD, P-151, I -2 (i)(c)	116.940	sq.m.	181.00	21166.14
		111.950	sq.m.	156.00	17464.20
		23.330	sq.m.	140.00	3266.20
12	Neat cement punning about 1.5mm thick in wall, dado, window, sills, floor, drain etc. SOR, PWD, P-152, I -8	26.700	sq.m.	38.00	1014.60
13	Artificial stone in floor,dado, staircase etc. with cement concrete (4:2:1) with stone chips laid in panels as directed with topping made with ordinary or white cement (as necessary) and marble dust in proportion (2:1) including smooth finishing and rounding off corners and including application of cement slurry before flooring works, using cement @ 1.75 kg./sq.m. all complete including all materials and labour. In ground floor. 3 mm. thick topping (High polishing grinding on this item is not permitted) with ordinary cement. 20mm thick SOR, PWD, P-40, I -3 (i)	26.490	sq.m.	265.00	7019.85
14	Supplying, fitting & fixing MS clamp for fixing door and window frame made of flat bent bar, end bifurcated, fixed in cement concrete with stone chips (4:2:1)a fitted and fixed omplete as per direction. 40mm x 6mm x 125 mm length. (Cost of cement concrete will be paid separately) SOR, PWD, P-90, I -18 (c)	34	each	22.00	748.00
15	Wood work in door and window frame fitted and fixed complete including a protective coat of painting at the contact surface of the frame other Local wood SOR, PWD, P-85, T -1(i)	0.213	cu.m.	46171.00	9834.42
16	Panel Shutter of door & Window (each Panal Consisting Of single Plan without Join) 25 mm thick shutter with 12 mm thick Panal of size 30 to 45 cm. Other Local wood SOR, PWD, P-105, I -84 (iv)c	8.520	sq.m.	1567.00	13350.84
17	Iron butt hinges of approved quality fitted and fixed with steel screws, with ISI mark. a)75mm x 47mm x 1.70mm SOR, PWD, P-91, T -20(iv)	32.000	each	34.00	1088.00
18	Iron Socket Bolt of approved quality fitted and fixed complete. i) 150 mm long x 10 mm dia SOR, PWD P-93, I -25,c	11.000	each	71.00	781.00
19	White washing including cleaning and smoothening surface thoroughly (5 parts of stone lime and 1 part of shell lime should be used in the finishing coat). Two Coats SOR, PWD, P-155, I -3 (b)	124.960	%sq.m.	1887.00	2358.00
20	Colour washing with ella with a coat of white wash priming including cleaning and smoothening surface thoroughly external surface One Coat SOR, PWD, P-155, I - 4(ii)(a)	100.560	%sq.m.	1514.00	1522.48
21	Priming one coat on timber, plastered or on steel or other metal surface with synthetic enamel/oil bound primer of approved quality including smoothening surfaces by sand papering etc. 1) On timber surface SOR, PWD, P - 162, I - 7(a) 2) On Steel Surface SOR, PWD, P - 162, I - 7(b)	21.690	sq.m.	41.00	889.29
		2.700	sq.m.	31.00	83.70
22	Painting with best quality synthetic enamel paint of approved make and brand including smoothening surface by sand papering etc. including using of approved putty etc. on the surface, if necessary : With suner gloss (hi-gloss)-With anv shade excent white. a) On timber or plastered surface Two Coats b) On Steel surface Two Coats SOR, PWD, P - 162, - 8A(ail),(bil)	21.690	sq.m.	89.00	1930.41
		2.700	sq.m.	86.00	232.20

SL No.	Description of Works	Quantity	Unit	Rate (Rs.)	Amount (Rs.)
23	Iron hasp bolt of approved quality fitted and fixed complete (oxidised) with 16 mm dia with center bolt and round fitting. 300 mm long SOR, PWD, P-93, I - 27c	2.000	each	193.00	386.00
24	Precast piered concrete jally work as per design and manufacture's specification including moulding etc. with stone chips and necessary reinforcement shuttering complete including fitting, fixing in position in all floors. (a) 37.5 mm th. panels Cement & steel required for this item will not be issued by deptt. SOR, PWD, P-32, I - 38 (b)	1.690	sq.m.	351.00	593.19
25	Supplying, fitting and fixing UPVC down pipes A type and fittings conforming to IS 13592-1992 with necessary clamps nails including making holes in walls, etc. and cutting trenches in any soil, through masonry concrete structure etc. if necessary and mending good damages including jointing with jointing materials (Spun yarn, valamoid / bitumen / M. seal etc.) complete. P-173, I-21 A (ii), C(ii), D(ii) SOR, PWD, P173, I - 21 A (ii), C(ii), D(ii) i) UPVC Pipe 110 mm dia ii) UPVC Bend 87.5 degree 110 mm dia iii) UPVC Shoe 110 mm	3.000 2.000 1.000	Mtr. each each	291.00 162.00 128.00	873.00 324.00 128.00
26	M.S. or W.I. Ornamental grill of approved design joints continuously welded with M.S, W.I. Flats and bars of windows, railing etc. fitted and fixed with necessary screws and lugs in ground floor. Grill weighing 10 kg/sq m to 16 kg/m2 SOR, PWD, P - 76, I - 10 (i) (2.70sqm @ 10.5kg per sqm = 28.35 kg)	0.284	Qntl	8247.00	2342.15
27	Shallow water closet Indian pattern(I.P.W.C.) of approved make in white vitreous chinaware supplied, fitted and fixed in position (excluding cost of concrete for fixing). 450 mm long SOR, PWD, (Sanitary) P - 65, I - 1 (iii)	1.000	each	1062.00	1062.00
28	Foot rest for water closet of size 275 mm X 125 mm with Artificial stone(4:2:1) with 6 mm stone chips and chequered including adding colour as necessary. SOR, PWD, (Sanitary) P - 66, I - 9	1.000	Pair	70.00	70.00
29	Supplying, fitting and fixing cast iron 'P' or 'S' trap conforming to I.S. 3989 / 1970 and 1729 / 1964 including lead caulked joints and painting two coats to the exposed surface. S Trap 100 mm SOR, PWD, (Sanitary) P - 54, I - 14(B-iii)	1.000	each	923.00	923.00
30	Supplying, fitting fixing CI Round Gratings 150mm dia SOR, PWD, (Sanitary) P - 55, I - 18(ii)	1.000	Each	100.00	100.00
	Construction of 2 circular leach pit of inside diameter 1000 mm. & a depth of 1000 mm. With a layer of 250 mm. Thick brick work with cement mortar (6:1) & honeycombed brick wall (4:1) at every alternate layer upto a height of 925 mm. From bottom and then 125 mm. thick brick wall (4:1) for a height of 300 mm. and covered with 75m. RCC slab (4:2:1) with 8mm tor steel @ 150 mm. centre to centre both ways including plastering and neat cement punning on top of the slab and making hooking arrangement on slab for lifting of the slab if require as well as jointing the connection with the inspection pit (450 x 450) covered with 50mm thick RCC slab (4:2:1) with stone chips and necessary reinforcement and connected with 100 mm dia PVC pipe laid over rammed earth and then covered the pipe properly with powder earth including supplying fitting fixing fibre glass pan P-tap & polythene pipe as per requirement to connect with the inspection pit complete with all respect as per direction of EIC.(ANNEXURE-II)	1	Item	7544.00	7544.00
	TOTAL AMOUNT		Rs.		350000.36
	Say		Rs.		350000.00
	Add for Electrical Works (ANNEXURE-I)		Rs.		17858.00
	TOTAL AMOUNT		Rs.		367858.00
(Rupees Three lakh Sixty seven thousand Eight hundred & Fifty eight only)					

Sukalpa Tarafdar
SUKALPA TARAFDAR
 Sub-Assistant Engineer
 New Barrackpur Municipality

Tripti Majumder
TRIPTI MAJUMDER
 CHAIRPERSON
 New Barrackpore Municipality

ESTIMATE FOR ELECTRICAL WORKS FOR ONE DWELLING UNIT UNDER RAY

(ANNEXURE-I)

Sl.No	SOR	Item of works	Unit	Rate	Quantity	Amount
1	PWD/Vol-I (Aug 2008) A/1(b)/E-9	Supplying & fitting polythene pipe complete with fittings as necessary. Under celing /beam/bound with 22SWG GI wire inclusive S & Drawing 1x18 SWG GI wire as fish wire inside the pipe & fittings and providing 55 mm dia disc of MS sheet (20SWG) having colour paint at one face first ended at the load point end of the polythene pipe with fish wire (synchronizing with roof/beam casting work of building construction) 19 mm dia 3 mm thick polythene pipe	RM	39.00	25.00	975.00
2	PWD/Vol-I (Aug 2008) A/1(m)/E-17	Powerckt wiring supplying and drawing 1 ; 1KV grade single core stranded FR PVC insulated & unseathed single core stranded Copper wire (Finolex make) 2 x 2.5 sqmm (PH & N) +1x1.5 sqmm (ECC) per laid polythene pipe and by the prelaid GI fish wire & making necessary connections as required.	RM	76.00	50.00	3800.00
3	PWD/Vol-I (Aug 2008) A/1/2 (a- i)/E-17	Concealed Distribution wiring in in 2x1.5 sqmm single core standard *FR* insulated and unseathed cop per wire Finolex make & 1x1.5 sq mm single core stranded PVC cinsulated and unseathed cop per (Finolex make) wire used as ECC in 19 mm bore 3 mm thk. polythene pipe complete with all accessries embedded in wall smooth run to light / fan/call bell point with pino key type switchb (6 Amps) (Anchor make) fixed on sheet metal (16 SWG) Switch Board with bakelite/ perspex (wall maching colour) Top cover (3 mm thick) flushed in wall including mending all good damages to original finish Average per point 6.00 mt.	points	828.00	10.00	8280.00
4	PWD/Vol-I (Aug 2008) A/4 (a- i)/E-18	Deistribution concealed wiring with 2x1.5 sq mm (PH & N) single core stranded FR PVC insulated & unseathed single core sttranded 1.1 KV grade Copper Wire (finolex) & 1x1.5 sq mm (ECC) single core stranded (PH & N) 1.1 KV grade cu wire (finolex) & 1 x 1.5 sq mm single core stranded PVC insulted & unseathed cu wire (finolex) used as ECC in 19 mm bore, 3 mm thick polythene pipe complete with all accessories embedded in wall 250 volt 5 amp 3 pin plug point including S & F 250 Volt 5 amp 3 pin flush type plug socket & piano key type swich (Anchor make) on existing switch board as mentioned sl. no.3	points	76.00	2.00	152.00

Sl.No	SOR	Item of works	Unit	Rate	Quantity	Amount
5	PWD/Vol-I (Aug 2008) E-17, A 1-e	Supplying & drawing 1.1 KV grade single core stranded FR PVC insulated & unseathed single core stranded cu Wire 3x2.5 sq mm (finolex make) in the prelaid polythene pipe & by the prelaid GI fishwire & making necessary connection as required (CESC supply to consumer DP near to CESC & inside the room another DP near CESC & inside the room another DP of dwelling units)	RM	86.00	15.00	1290.00
Sl.No.	SOR	Item of works	Unit	Rate	Quantity	Amount
6	KMC 2008-09)A/(1/e) p/(h)	Supplying Delivery & instalation on wall of 30/32 amp DP MCBof Havel's make with enclosed box along with all its necessary 1 connection complete.(Anchor)	nos	808.00	2	1616.00
7	PWD/Vol-I (Aug 2008) 2(a) G-1	Earthing in soft soil with 50 mm dia GI pipe (TATA make Medium) 3.64 mm th. X 3.04 Mtr long and 1 x 4 SWG GI (hot dip) wire (4 m long) 13 mmdia x 80 mm long GI bolts, double nuts, double washer including S & F 15 mm dia GI protection (1 mtr long) to be filled with bitumen partlyunder the ground level & partly above GL driven to an average depth of 3.65 m below the GL & restoring surface duly rammed.	each	1715.00	1	1715.00
8	PWD/Vol-I (Aug 2008) 5(a-iv) G-3	Connecting the equipment to earth BUSbar inclusive S&F 10 SWG (Hot Dip) GI wire on wall /floor with a staples buried inside wall /floor as required & making connection to equipments with bolt, nut, washer, cable lugs etc. as required & mending good damages.	M	6.00	5	30.00
				TOTAL		17858.00
Rupees Thirteen Thousand Eight Hundred Seventy Eight Only						17858.00

Detailed Estimate for Single Dwelling unit
 Floor area 25.36 sqm Built up area 32.18 sqm

	C/L of main outer wall			125 mm Partitionwall		Varandah C/L	
	4.65			3.375		1.275	
	0.8			1.15		0.9	
	1.15			1.15	2.3	2.175	
	3.45			2.187			
	1.15			1.9			
	1.7			1.387	5.474		
	3.375			11.149			
	1.275						
	2.825						
	3.125						
	23.5						
	X wall	1.25					
Sl.no.							
1	Earth work in excavation						
	250 mm wall						
	1	23.5	0.75	0.7	12.34		
		0.875	0.75	0.7	0.46		
		24.375			12.8	m ³	
	125 mm Wall						
		2.625		0.4	0.225	0.24	
	WC	0.4	0.4	0.225	0.04		
	Bath	0.65	0.4	0.225	0.06		
	5.474	0.75		0.225			
		4.724	0.4	0.225	0.43		
	Varanda	1.425	0.4	0.225	0.13		
					0.88		
	Step	0.5	0.9	0.075	0.034		
					13.715	m ³	
2	Soling						
		24.375	0.75		18.281		
		11.45	0.4		4.58		
					22.861		
3	Polythene sheet						
		2.575	3.125		8.047		
		2.875	2.625		7.547		
		2	1.65		3.3		
	passage	0.625	2.375		1.484		
	Bath&WC	2.7	0.9		2.43		
	Varndah	1.025	0.6		0.615		
	step	0.9	0.5		0.45		
					23.873		
4	Jhama concrete						
			18.28	0.075	1.371		
			4.58	0.075	0.344		
			23.93	0.075	1.795		
					3.51		
5	Earth work in filling 1/5 excavation						
			13.715	5	2.743		
			23.48	0.375	8.805		
					11.548	m ³	

6	B.W (6:1) in Foundation of plinth								
		23.5	0.625	14.6875					
		23.5	0.5	11.75					
		23.5	0.375	8.8125					
				35.25	0.15	5.288			
		23.5	0.25		0.525	3.084			
	X wall	0.938	0.625	0.586					
		1	0.5	0.5					
		1.063	0.375	0.399					
				1.485	0.15	0.223			
		1.125	0.25		0.525	0.148			
	125mm	3.125	0.25		0.525	0.41			
	Bath&WC		2 0.9	0.25	0.523	0.235			
	Kit	5.224	0.25		0.525	0.686			
	Vard	1.925	0.25		0.525	0.253			
	Steps		0.5 0.9		0.15	0.068			
			0.25 0.9		0.15	0.034			
						10.427	m ³		
7	DPC	23.5							
		1.125							
		24.625		0.25		6.156			
		3.125							
		1.8							
		5.224							
		10.149		0.125		1.269			
						7.425			
	Less		0.9	0.25	0.225				
			0.9	0.125	0.113				
		3	0.75	0.125	0.281				
						0.619			
						6.806	sqm		
8	BW in super structure (6:1)								
		23.5							
		1.125							
		24.625	2.75	0.25	16.93				
	Parapet	23.8	0.075	0.25	0.446				
						17.376			
	Less opens								
		1 0.9	2.1	1.89					
		4 0.9	0.9	3.24					
		1 0.75	0.9	0.675					
		3 0.75	0.75	1.688					
				7.493	0.25	1.873			
	Lintel								
		1 1.525	1.525						
		4 1.2	4.8						
		1 1.05	1.05						
			7.375	0.25	0.1	0.184			
	Wo2								
		1 3.05	3.05	0.25	0.1	0.076			

					(-)	2.134			
	Net brick work						15.242	m ³	
9	125 th. Brick work (6:1)								
	room		3.125	2.6	8.125				
	kit		2.125	2.75	5.844				
			1.65	2.75	4.5375				
			1.45	2.65	3.8425				
	2		0.9	2.1	3.78				
						26.12875			
	Less opening								
	1 0.9		0.9						
	3 0.75		2.25						
			3.15	2.1	6.615				
	Lintel								
	1 1.3		1.3						
	1 1.025		1.025						
			2.325	0.1	0.2325				
					6.8475				
						19.28125			
	Parapet								
	23.5			0.15		3.525			
						22.806			
	passege	0.75		0.55		0.4125			
						23.219	sqm		
10	Conc M-20								
	Roof slab								
	32.15	1.1475	31.003		0.1	3.1			
	Beam		3.625	0.25	0.15	0.136			
			2.575	0.25	0.1	0.064			
	Lintel						3.301		
	D1	1	1.525	1.525					
	W1	4	1.2	4.8					
	W2	1	1.05	1.05					
	WO2	1	3.05	3.05					
				10.425	0.25	0.1	0.261		
	D1	1	1.39	1.39					
	D2	1	1.025	1.025					
	D2	2		1.4 2.8					
	O2	1	0.875	0.875					
	D2	2		6.09	0.125	0.1	0.076		
	Chaja								
	W1	4	1.2	4.8					
	W2	1	1.03	1.03					
	D1	1	1.275	1.275					
	W02	1	3.05	3.05					
				10.155	0.3	0.075	0.228		
							3.866	m ³	
11	Reinforcement								
		3.866	0.80%	1	7850	0.243	MT		

12	Shuttering							
	31	23.5	1.125					
			24.63	0.25				
	31			6.156	24.844			
	Side beam	2	3.125	0.15	0.9375			
		2	2.325	0.1	0.465			
	side slab	1	25.3	0.1	2.53			
	Lintel	1		0.9	0.225			
		1	1.525	0.1	0.153			
		1	1.275	0.35	0.446			
		1	0.3	0.05	0.015			
						29.615	sqm	
	4W1	4	0.9	0.25	0.9			
		4	1.2		0.1	0.48		
		4	1.2	0.35	1.68			
	2	4	0.3	0.05	0.12			
	1W2	1	0.75	0.25	0.188			
		1	1.05		0.1	0.105		
		1	1.05	0.35	0.368			
	2	1	0.3	0.05	0.03			
	WO2	3	0.75	0.25	0.563			
	1	1	3.05		0.1	0.305		
		1	3.05	0.35	1.068			
	2	1	0.3	0.05	0.03			
	Lintel 125 Wall							
	D1	1	0.9	0.125	0.113			
		2	1.3	0.1	0.26			
	D2	2	0.75	0.125	0.188			
	2	2	1.15	0.1	0.46			
	D2	2	0.75	0.125	0.188			
		2	1.9	0.1	0.38			
						7.423		
						37.038	sqm	
13	Plaster (6:1)							
	Out side 15 mmth.							
			2.85	1.125	0.45			
		25.3			4.425	111.953	sqm	
	Inside 20 mm th.							
	2	2.7	3.125	2.75	32.038			
	2	2.875	2.625	2.75	30.25			
	2	2	1.65	2.75	20.075			
	2	2.075		2.75	11.413			
	Above lintel							
	1	0.75		0.65	0.488			
	Bath							
	2	0.9		2.75	4.95			
	WC							
	1	2.95		2.75	8.113			
	1	2.25		2.75	6.188			
	4	2.2		0.9	7.92			
	T. 125 wall							

	2	0.9		0.125	0.225				
						121.658			
	Open out side less								
	3	0.75		2.1	4.725				
					(-)	4.725			
						116.933	sqm		
	Ceiling Plaster				24.47				
	Less				1.14				
						23.33	Sqm		
14	Neat cement punning								
	Out side	Plinth							
		25.3	0.45			11.385	Sqm	11.385	
	Inside		2.7	3.125					
			2	5.825	0.1	1.165	Sqm		
			2.875	2.625					
			2	5.5	0.1	1.1	Sqm		
	Kithen		2	1.65					
			2	3.65	0.45	3.285	Sqm		
			1	1.65	0.45	0.743	Sqm		
			2	2.075	0.1	0.415	Sqm		
	Varanda			1.775	0.1	0.178	Sqm		
	step WC	1		3	0.45	1.35	Sqm		
	Bath			3.5	2	7	Sqm		
				0.75	0.1	0.075	Sqm		
	In side punning						15.31	15.31	
	Total							26.695	Sqm
15	Art. Stone flooring								
	Floor area					25.37	sqm		
	Step	2	0.9	0.25		0.45			
	W1	4	0.9	0.1		0.36			
	W2	1	0.75	0.1		0.075			
	W3	3	0.75	0.1		0.225			
							26.48	Sqm	
16	Ms Clamp for door & window								
	D1+D2	4		6		24			
	W1+W2	5		2		10			
							34 nos.		
17	Wood work in Door & window frame								
	D1	2	5.1	10.2					
	D2	2	4.95	9.9					
	W1	4	3.6	14.4					
	W2	1	3.3	3.3					
				37.8	0.075	0.075	0.213	m ³	
18	Z batten shutter								
	D1	2	0.775	2.025		3.139			
	D2	2	0.625	2.025		2.531			
	W1	4	0.775	0.775		2.403			
	W2	1	0.775	0.625		0.484			
							8.557	sqm	
19	Iron Butt Hinges								

	D1+D2					12		
	W1	4	4			16		
	W2	1	4			4		
							32 nos.	
20	Iron socket bolt							
	Door			6				
	Window			5				
							11 nos.	
21	White wash							
	Inside+Ceiling Plaster- inside punning							
		116.933	23.33	15.31		124.953	sqm	
22	Colour wash							
	Out side Plaster- out side punning							
		111.953	11.385			100.568	sqm	
23	Priming on timber sutface							
	2	2	0.9	2.1		7.56		
	2	2	0.75	2.1		6.3		
	4	2	0.9	0.9		6.48		
	1	2	0.75	0.9		1.35		
						21.69	sqm	
24	Painting best quality on wooden surface							
	same sl.no. 23					21.69	sqm	
25	MS ornamental gril...10Kg-16 Kg							
	W1	4	0.75	0.75	2.25			
	W2	1	0.75	0.6	0.45			
					2.7			
					@12Kg/sqm	32.4	Kg	
26	Priming on Steel sutface					2.7	sqm	
27	Painting best quality on steel surface					2.7	sqm	
	same sl.no. 24							
28	R.C.C. Shelf							
		1.75	0.5			0.875	sqm	
29	Roof treatment with cow dang							
				32.18				
	Deduct	1.14	(varanda)	1.14				
	Cornice	25	0.125	3.125				
				27.915		27.915	sqm	

**Cost Estimate for 2 Nos Leach Pit for single unit Dwelling Unit
P.W.D Schedule of Rates effect from 1st July 2014**

(ANNEXURE-II)

SI No	Description of Items	Quantity	Unit	Rate	Amount
1	Earth work in excavation of foundation trenches or drains in all sorts of soil (including mixed soil but excluding or stacking the spoils within a lead of 75 m. as directed. The item includes necessary trimming the sides of trenches leveling dressing and ramming the bttom boiling out water aqs required complete . Depth of exavation not existing 1500mm P.No-1, I-2(a)	2.500	%Cu.M	12047.00	301.18
2	Cement concrete with graded jhama Khoa ballast (30 mm size) excluding shuttering. In ground floor and foundation (a) 6:3:1 proportion.	0.050	Cu.M	5803.06	290.15
3	Brick work with 1st class bricks in cement mortar (6 :1). a) In foundation & Plinth P.no-29, I-21(a)	0.010	Cu.M	5719.00	57.19
4	125 mm. thick brick work with 1st class bricks in cement mortar (4 : 1) G.Floor	3.000	SqM	714.00	2,142.00
5	Controlled Cement concrete with well graded stone chips (20 - mm nominal size) excluding shuttering and reinforcement with complete design of concrete as per I : 456 and relevant special publications submission of job mix formula after preliminary mlx design after testing of concrete cubes as per direction of Engineer-in charge Consumption of cement will not be less than 300 Kg of cement -with Super plasticiser per cubic meter of controlled concrete but actual consumption will be determined on- the basis of preliminary test and job mix formula. -I n ground floor and foundation. [Using concrete mixture] M 20 Grade P.no-12, I-6(a)	0.145	Cu.M	6871.54	996.37
6	Reinforcemnet for reinforced concrete work in all sorts of structures incl. Distribution bars, stirrups, binder etc. incl. supply of rods, initial straightening & removal of loose rust (if necessary), cutting to requisite length, hooking etc P.no-27, I-15(a)(i)	0.010	M.T	68508.00	685.08
7	Supplying, fitting and fixing UPVC down pipes A type and fittings conforming to IS 13592-1992 with necessary clamps nails including making holes in walls, etc. and cutting trenches in any soil, through masonry concrete structure etc. if necessary and mending good damages including jointing with jointing materials (Spun yarn, valamoid / bitumen / M. seal etc.) complete.				
	i) UPVC Pipe 110 mm dia P.no-173, I-	4.000	Mtr	291.00	1,164.00
	ii) UPVC Bend 87.5 degree 110 mm dia P.no-174, I-21(B)C(ii)	2.000	Each	162.00	324.00
8	Jaffri brick work 125 mm. thick with 1st class bricks in cement mortar (4:1) including 12 mm. thick cement plaster (4:1) in all faces in ground floor .P.no-32, I-35	2.000	SqM	792.00	1,584.00
Cost of 2 no leach pit					7,543.97
Total=					7,544.00

Rate Analysis
Brick Work 4:1 in foundation & plinth

Step - 1	Schedule Rate	Rs	6068.00(A)
Step - 2	Deduct cost of cement=(Quanty of cement)x(Issue rate of cement vide item no-1 column-4 Table 1-1 of Annexure-1 0.055x8100	Rs	672.30(B)
Step - 3	Add cost of cement supplied by cost contractor including 10% proffite = 1.1x(Quanty of cement)x(Basik price of cement vide item no -1 column- 5 table-1-1 of annexure -1 1.1x.055x7364	Rs	672.33 (C.)
	Note:- Quantity of cement shall be same as step-2 Final Rate of item = Rs A - Rs B + Rs C = Rs D	Rs	6068.03 (D)

Rate Analysis
Ordinary Mix Concrete 1:1.5:3

Step - 1	Schedule Rate	Rs	6802.63 (A)
Step - 2	Deduct cost of cement=(Quanty of cement)x(Issue rate of cement vide item no-1 column-4 Table 1-1 of Annexure-1 0.286x8100	Rs	2316.6 (B)
Step - 3	Add cost of cement supplied by cost contractor including 10% proffite = 1.1x(Quanty of cement)x(Basik price of cement vide item no -1 column- 5 table-1-1 of annexure -1 1.1x.286x7364	Rs	2316.71 (C.)
	Note:- Quantity of cement shall be same as step-2 Final Rate of item = Rs A - Rs B + Rs C = Rs D	Rs	6802.74 (D)

Rate Analysis
P.C.C 1:3:6 With Jhama Khoa

Step - 1	Schedule Rate	Rs	5803.00 (A)
Step - 2	Deduct cost of cement=(Quanty of cement)x(Issue rate of cement vide item no-1 column-4 Table 1-1 of Annexure-1 0.16x8100	Rs	1296.00(B)
Step - 3	Add cost of cement supplied by cost contractor including 10% proffite = 1.1x(Quanty of cement)x(Basik price of cement vide item no -1 column- 5 table-1-1 of annexure -1 1.1x.16x7364	Rs	1296.06 (C.)
	Note:- Quantity of cement shall be same as step-2 Final Rate of item = Rs A - Rs B + Rs C = Rs D	Rs	5803.06 (D)

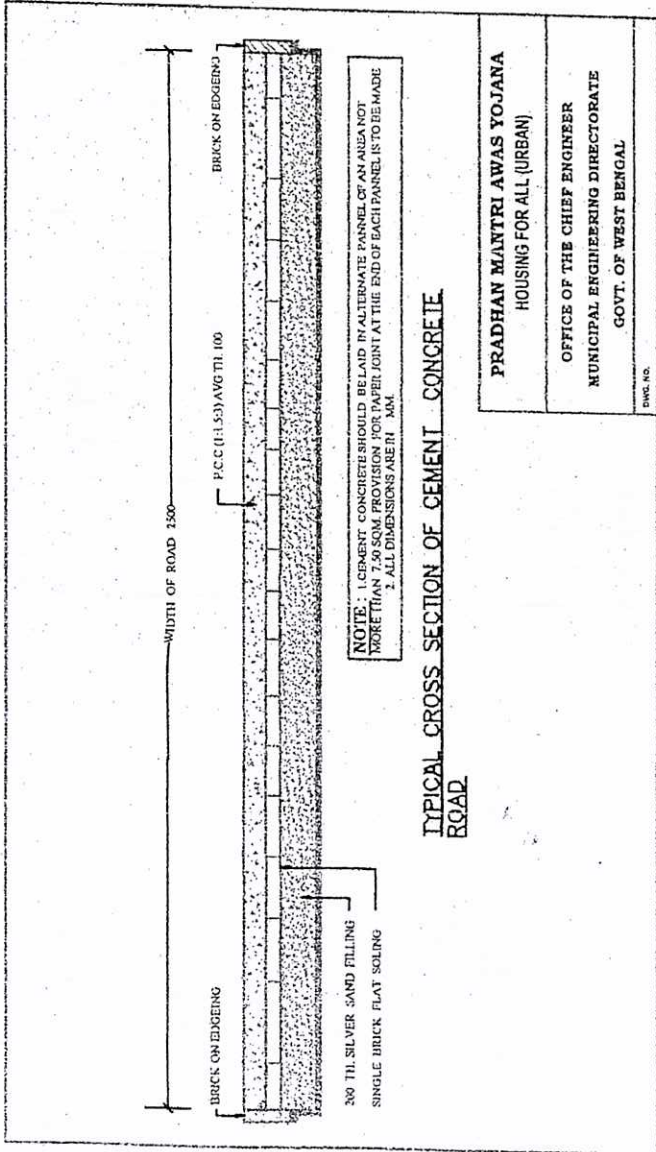

Tmm
TRIPTI MAJUMDER
 CHAIRPERSON
 New Barrackpore Municipality

Tmm
TRIPTI MAJUMDER
 CHAIRPERSON
 New Barrackpore Municipality

Annexure - II

Format - A

(Format for Rate Analysis of Cement Concrete Item)

Item 7. Ordinary Cement concrete (mix 1:1.5:3) with graded stone chips (20 mm nominal size) excluding Consumption of Stone aggregate (Page B-59)

20 mm = 0.573 Cum

10 mm = 0.287 Cum

Distance of site considered =

10 Km

Steps	Quantity	Unit	Rate	Amount
Step - 1 Rate of item as per relevant section of this Schedule A =	1.00	CUM	5389.00	5389.00
Step - 2 Add cost of stone aggregate of different grading as per consumption required for one cum of concrete. (As per table:T-1)				
Station : kalyani				
20mm Nominal Size:	0.573	CUM	1463.00	838.30
10mm Nominal Size:	0.287	CUM	1296.00	371.95
Total B =				1210.25
Step - 3 Add cost of carriage of stone aggregate as per consumption required for one cum of concrete. (As per table:T-2)				
20mm Nominal Size:	0.573	CUM	178.50	102.28
10mm Nominal Size:	0.287	CUM	178.50	51.23
Total C =				153.51
Step - 4 Add cost for loading and unloading of stone aggregate (As per table:T-3)				
20mm Nominal Size:	0.573	CUM	58.00	33.23
10mm Nominal Size:	0.287	CUM	58.00	16.65
Total D =				49.88
Final Rate of Item = [Rs. A - Rs.B + Rs.C + Rs.D] = Rs.				6802.64

ESTIMATE FOR CONSTRUCTION OF CONCRETE ROAD 2.5 MRTRE WIDE

PWD BUILDING SCHEDULE 2014

SI No	Description of Items	Length	Breadth	Depth	Quantity	Unit	Rate	Amount
1	Earth work in excavation of foundation trenches or drains in all sorts of soil (including mixed soil but excluding or stacking the spoils within a lead of 75 m. as directed. The item includes necessary trimming the sides of trenches leveling dressing and ramming the bottom boiling out water aqs required complete. Depth of exavation not existing 1500mm P.No-1, I-2(a)	1.00	2.5	0.400	1.000	%Cu.M	12047.00	120.47
2	Filling foundation or plinth by silver sand in layer not exceeding 150 mm. as directed and consolidating same by through saturation with water ramming complete. Including the cost of supply of sand. (a) by fine sand P.No-2, I-4(B)	1.00	2.5	0.200	0.500	%Cu.M	110422.00	552.11
3	Single brick flat soling of picked jhama bricks including ramming and dressing bed to proper level and filling joints with powdered earth or local sand P.no-11, I-1	1.00	2.5		2.500	Sq.M	377.00	942.50
4	Ordinary Cement concrete (mix 1:1.5:3) with graded stone chips (20 mm nominal size) excluding shuttering and reinforcement, if any, in ground floor as per relevant IS codes P.no-24, I-10(a)	1.00	2.5	0.125	0.313	Cu.M	6802.74	2,125.86
5	Brick edging 75 mm. wide with picked jhama bricks, laid true to line and level including cutting necessary trench in sopil or in hard metalled surface, laying the bricks and repacking the trench (on both sides of the edging) with spoils and ramming the same throughly, complete as per dirrection. (b) Brick-on-end edging (250 mm) depth. P.No-189, I-3(b)	2.00			2.000	%Mtr	9392.00	187.84
6	Removal of rubbish, earth etc. from the working site and disposal of the same beyond the compound in conformity with the Municipal /Corporation Rules forsuch disposal, loading into truck and cleaning the site in all respect as per direction of Engineer - in -Charge P.no-9, I-13	1.00	2.500	0.400	1.000	Cu.M	168.00	168.00
							Toatl=	4,096.78
							Total=	4,097.00

TRIPTI MAJUMDER
CHAIRPERSON
 New Barrackpore Municipality

Supplying laying of D.I Pipe line (100 mm dia)

SCHEDULE FOLLOWS

A. P.W.D. Schedule of Rates For Building Works, Materials and Labour Effective from 1st July 2014

B. K.M.D.A. Water Supply Schedule of Rates 2004.

Considering 1000 m. length

Sl. No.	Description of Item	Quantity	Rate	Unit	Amount (in Rs.)
1. Page-1 It No- 2(a)	Earth work in Excavation of Foundation trenches or drains, in all sorts of soil (including mixed soil but excluding laterite or sand stone) including removing, spreading or stacking the spoils with a lead of 75 Mtr as directed. The item includes necessary trimming the sides of trenches, leveling dressing and ramming the bottom, bailing out water as required complete. a) Depth of Excavation not exceeding 1,500 mm. (i) $1000 \times 0.50 \times 1.00 = 500.00$	500.00	12,047.00	% M ³	60,235.00
2. Page-1 It No- 3(a)	Earth work in filling in foundation trenches or plinth with good earth. In layers not exceeding 150 mm including watering and ramming etc. layer by layer complete. (Payment to be made on the basis of measurement of finished quantity of work) $[(i) - (3.14 \times 0.1^2) * 1000 = 31.40,$ $500.00 - 31.40 = 468.60 \text{ cum}$ a) with earth obtain from excavation of foundation.	468.60	7,831.00	% M ³	36,696.07
3. Page - 53 It No-1.2.2 (b)	Lowering any type of D.I pipe and specials and laying along trench at any depth as per specification and direction of the Engineer in charge. b) 100 mm Dia	1,000.00	394.00	%M	3,940.00
4. Page No- 56 It No-1.2.5 (b)	Rubber gasket joints to C.I / D.I pipes and laying along trench at any depth as per specification and direction of the Engineer in Charge. b) 100 mm Dia	270.00	20	Each	5,400.00
5. Page No- 57 IT No-1.2.6 (b)	Flange joint to C.I / D.I / M.S pipes and specials including supply of rubber gasket, nuts, bolts washers ect. Of best quality to make the joint water tight at required hydraulic presser all complete as specification & direction of the Engineer in charge. b) 100 mm Dia	29.00	210	Each	6,090.00
6. Page No- 58 It No-1.2.7 (b)	Cutting of C.I / D.I pipes for fitting with pipes and or specials of similar or de similar materials at the time of laying without damaging any part of the required length including taking out of the broken pieces from the trench and restacking the same at the specified location as per direction of the Engineering in charge. b) 100 mm Dia	50.00	33.00	Each	1,650.00

Sl. No.	Description of Item	Quantity	Rate	Unit	Amount (in Rs.)
7. Page No-71 It No- 1.5 (b)	Chamfering the spigot end of C.I / D.I pipes for fittings with the socket of C.I / D.I pipes and or specials in tyton jointed water mains or otherwise using electric grinder as per Engineering in charge. b) 100 mm Dia	30.00	35.00	Each	1,050.00
8. Page No-71 It No- 1.5 (b)	Lowering, fitting and fixing all types of valve in proper position and alignment using chain pulley block or crane (for diameter above 250 mm) by providing temporary support as required, gasket nuts & bolts etc. all complete as per specification and direction of the Engineer in charge. b) 100 mm Dia	11.00	443.00	Each	4,873.00
9. Page No-78 It No- 4.1 (b)	Hydraulically testing of C.I / D.I / AC pipe line in sections under a head of water not less then 60m(6Kg/Cm2 pressure) or above as per specific requirements by filling the main with supply of water including supply of all specials and equipments, like pump set, gauges, end caps, blank flange etc. all complete as per instruction of the Engineer in charge. b) 100mm Dia	1,000.00	8.00	M	8,000.00
10. Page No-80 It No- 5.1 (b)	Disinfections of water main by filling with water containing bleaching powder of sufficient quantity capable of maintaining a residual chlorine concentration of 10mg/1 within the main after a detention period of two hours and complete as per specification and direction of the Engineer in charge. b) 100mm Dia	1,000.00	4.00	M	4,000.00
11. Page No-82 It No-6.1	Dewater by pumps including all heads lifts and making all arrangements of disposal, where continues flow of water from a source other than natural or ground water is encountered in case of emergency maintenance works related to leakage, breakage and making wet connections.	1,290.00	12.00	HP.Hr	15,480.00
12. Page No-105 It No-9.6 (a)(i) & (c)(i)	All types of ductile iron (spun) special (viz Bend, Tee, Taper, Tail piece etc.) size confirming to I.S. Specification No-9523 / 2000 with cement mortar lining (inside and bituminous coating (outside) (25% of payments will be held up till successful hydraulic testing) i) All socketed Tee 80 mm- 300 mm 150x150x100, 6 Nos @ 29.50 Kg/each =177 Kg 100x100x100, 6 Nos @ 21.50 Kg/each =129 Kg	306.00	67.00	Kg	20,502.00
	j) Tail Piece 80 mm- 300 mm 100x100, 18 Nos @ 9.70 Kg/Each =174.60 Kg	174.60	80.00	Kg	13,968.00
13. Page No-108 It No-9.8 (ii)	Single / Double bit SBR gasket suitable for jointing C.I / D.I presser pipes, confirming to I.S. 5382-1985 b) 100 mm Dia	312.00	31.00	Each	9,672.00

Sl. No.	Description of Item	Quantity	Rate	Unit	Amount (in Rs.)	
14. Page No-108. It No-9.8 (ii)	Cast iron double flanged valves generally conforming to I.S. 14846 : 2000 having four faces and spindle nut or gunmetal, inside screw non rising type brass / AISI 410 spindle ; seat tested to 10 Kg / CM2 And body tested to 15 Kg / CM2 Flanges flat faces and drilled to I.S: 1538: 1993 b) 100 mm Dia	10.00	3,209.00	Each	32,090.00	
15. Page No-87 It No-6.26 (b)	Supplying including cost of installation of compression flanged socket tailpiece for connecting flanged fitting to the plain (spigot) end of C.I / D.I pipes. b) 100 mm Dia	18.00	1,028.00	Each	18,504.00	
16. Page No-93 It No-6.33 (b)	Supplying including cost of installation of cast iron mechanical joint Double socket 90° Bend for connecting two plain ends of C.I / D.I pipes, with C.I body and follower gland, zinc coated MS. Fasteners and sealing rubber gasket as per IS: 13382-90 complete. b) 100 mm Dia	4.00	2241	Each	8,964.00	
17. Page No-93 It No-6.33 (b)	Supplying including cost of installation of cast iron mechanical joint Double socket 45° Bend for connecting two plain ends of C.I / D.I pipes, with C.I body and follower gland, zinc coated MS. Fasteners and sealing rubber gasket as per IS: 13382-90 complete. d) 100 mm Dia	4.00	1977	Each	7,908.00	
18. Page No-93 It No-6.34 4(b)	Supplying including cost of installation of cast iron mechanical joint Double socket 22.5° Bend for connecting two plain ends of C.I / D.I pipes, with C.I body and follower gland, zinc coated MS. Fasteners and sealing rubber gasket as per IS: 13382-90 complete. f) 100 mm Dia	3.00	1887	Each	5,661.00	
19. Page No-22 It No-15	Sluice valve chamber with C.I heavy cover with locking arrangement (weight not less than 25 Kg) (size of chamber 450 mm x 600 mm inside up to 900 mm depth) 250mm thick cement brick walls (6:1) 150 mm thick cement concrete (6:3:1) bed with jhama chips 19 mm thick cement plaster (6:1) for inside wall and 12 mm thick cement plaster (6:1) for outer walls including rounding corners b) 100 mm Dia sluice valve chamber	10.00	7,576.00	Each	75,760.00	
20	Supply of D.I Pipe with conformation to relevent IS codes and as per direction of EIC. mm dia	100	1,000.00	867.00	M	867,000.00
21	Removal of rubbish, earth etc. from the working site and disposal of the same beyond the compound in conformity with the Municipapal /Corporation Rules forsuch disposal, loading into truck and cleaning the site in all respect as per direction of Engineer - in - Charge. 1000x0.5x0.5=250 cum	250.00	168.00	cum	42,000.00	
Total Rs.					1,249,443.07	
Say=					1,249,443.00	

Per meter Length=Rs. 1249.00

(Rupees Twelve Hundread Fourty Nine only)

TRIPTI MAJUMDER
CHAIRPERSON
New Barrackpore Municipality

ESTIMATE FOR CONSTRUCTION OF SURFACE DRAIN (300X300)

PWD BUILDING SCHEDULE 2014

Sl No	Description of Items	Length	Breadth	Depth	Quantity	Unit	Rate	Amount
1	Earth work in excavation of foundation trenches or drains in all sorts of soil (including mixed soil but excluding or stacking the spoils within a lead of 75 m. as directed. The item includes necessary trimming the sides of trenches leveling dressing and ramming the bottom boiling out water aqs required complete. Depth of excavation not existing 1500mm P.No-1, I-2(a)	1.00	0.95	0.475	0.451	%Cu.M	12047.00	54
2	Single brick flat soling of picked jhama bricks including ramming and dressing bed to proper level and filling joints with powdered earth or local sand P.no-11, I-1	1.00	0.95		0.950	Sq.M	377.00	358
3	Cement concrete with graded jhama Khoa ballast (30 mm size) excluding shuttering. In ground floor and foundation (a) 6:3:1 proportion.	1.00	0.95	0.100	0.095	Cu.M	5803.06	551
4	Brick work with 1st class bricks in cement mortar (4 :1). a) In foundation & Plinth P.no-29, I-21(a)	1.00	0.25	0.600	0.150	Cu.M	6068.00	910
5	Plaster (to wall, floor, ceiling etc.) with sand and cement mortar including rounding off or chamfering corners as directed and raking out joints or roughening of concrete surface including throating, nosing and drip course where necessary. (Gr.floor). i) With 4:1 cement mortar. a) 20 mm. Thick plaster. P.no-151, I-2(a)	1.00	1.1		1.100	Sq.M	206.00	226.
6	Neat cement punning above 1.5 mm thick in wall, dado, windowsills, floor, drain etc. P.no-152, I-8	1.00	1.100		1.100	Sq.M	38.00	41.
7	Artificial stone in floor dado staircase etc. with cement concrete 1:2:4 with stone chips laid in pannels as directed with topping made with ordinary or white cement (as measured) and marble dust in porportion (2:1) including smooth finishing and round P.no-40, I-3(ii)	1.00	0.300		0.300	Sq.M	303.00	90.
8	Removal of rubbish, earth etc. from the working site and disposal of the same beyond the compound in conformity with the Municipal /Corporation Rules for such disposal, loading into truck and cleaning the site in all respect as per direction of Engineer - in -Charge P.no-9, I-13	1.00	0.800	0.475	0.3800	Cu.M	168.00	63.8
							Total=	2,297.1
							Total=	2,297.01

NEW BARRACKPORE MUNICIPALITY

ESTIMATE FOR CONSTRUCTION OF CLOSED EUCALYPTUS BULLAH PILLING WITH EARTH FILLING WITH CEMENT BAG WALLING & EARTH FILLING FOR PROTECTING ROADS UNDER RAY PROJECT OF NEW BARRACKPORE MUNICIPALITY.

Consider Length = 55 Mtr.

Sl. No	DESCRIPTION OF ITEMS	QUANTITY	UNIT	RATE (in Rs.)	AMOUNT (InRs.)
1 P no-217 81 no-24	Pumping out water from Ponds or Tank. $2 \times (13.75 + 13.75) \times 0.70 = 38.50$	38.50	%Cu.M	1054.00	405.79
2 P no-318 sl no- 18.18(i)	Supplying U_C. Bullah Piles at work including dressing and making one end pointed. For post $368 \times 2.40 = 883.20$ For runner $1 \times 55 = 55.00$ including lap $1 \times 40 = 40.00$ Total = 95.00 mtr	883.20	Mtr	96.00	84787.20
		95.00	Mtr	96.00	9120.00
3 P-318 Sl.No- 18.18(i)	Supply of Bullah (EUC) for tie bar & tie post Tie Bar $38 \times 1.00 = 38.00$ Tie Post $38 \times 1.00 = 38.00$	38.00	Mtr	96.00	3648.00
		38.00	Mtr	96.00	3648.00
4. Page-318 Sl.I-o- 13.17(i)	Labour for driving Eucalyptus bullah piles by monkey in sorts of soil including hoisting and placing piles in position, protecting the pile head with iron ring and cutting and shaping heads before and after driving and including hire and labour for necessary driving appliances and all tackles. 100 mm Diameter $368 \times 1.20 = 441.60$	441.60	Mtr	83.00	36652.80
5 Page-319 Sl.N 0- 18.28	Supplying empty Cement bags in good condition $1 \times 1377 = 1377$	1377.00	%Nos	330.00	4544.10
6 Page-319 Sl.No- 18.29	Filling empty Cement bags with dry earth or sand, stitching the bag (cost of thread included) and carrying and placing them in position and all incidental charges complete but. excluding cost of sand and gunny bags. $1 \times 1377 = 1377$	1377.00	%Nos	350.00	4819.50

7 Page-319 SI.N 0- 13.27	Coal tarring of wooden surfaces including cost of materials (a) Double coat. 1x883.20x2x3.14x0.05=277.32 2x38x2x3.14x0.05=23.86 1x95x2x3.14x0.05=29.83 Total = 331.01	331.01	Sqm	36.00	11916.36
8 Page-322 SI.1'0- 18.41	Labour for fitting and fixing 10cm to 15cm diameter eucalyptus-bullah as ties and runners including necessary nails, bolts and nuts. 1x38=38.00 1x95=95.00 Total = 133.00	133.00	Mtr	20.60	2739.80
9 Page- I(Build.) SI.No-3 (c) (iii)	Earth work in filling in foundation trenches 01' plinth with good earth, in layers not exceeding 150 mm. including watering and ramming etc. layer by layer complete. (Payment to be made on the basis of measurement of finished quantity of work)				
	(i) With carried earth arranged by the contractor within a radius exceeding 3 km. But not exceeding 5 km. including the cost of carried earth. 1x55x0.90x1.20=59.40	59.40	%Cu.M	40300.00	23938.2
10 P.no- 9, I-13	Removal of rubbish, earth etc. from the working site and disposal of the same beyond the compound in conformity with the Municipal/Corporation Rules for such disposal, loading into truck and cleaning the site in all respect as per direction of Engineer-in-Charge 55x1.20x0.600=39.60	39.60	Cu.M	168.00	6652.80
Total for 55 mtr. Length Rs. =					192872.55
Say Rs. =					192873.00
Cost per Mtr. Length =					3507.00

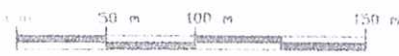
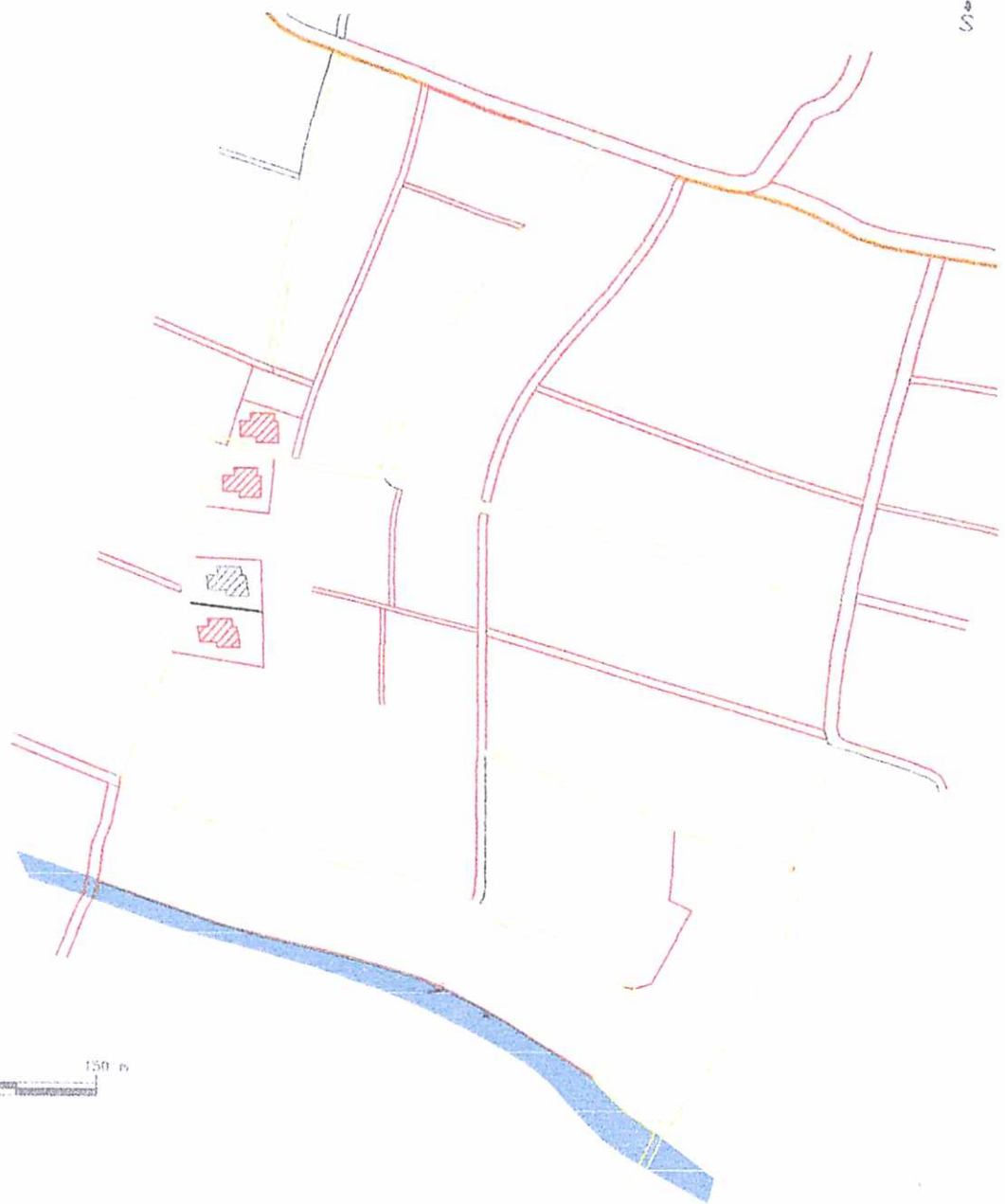

PROPOSED LAND USE

AREA OF SLUM :

POPULATION :

CLIENT :NEW BARRACKPORE MUNICIPALITY

LEGEND

ITEMS	SEMI PUCCA	KUCHHA	
	SYMBOL	SYMBOL	QTY
DWELLINGHOUSE(NOS)			4
BLACK TOPPED ROAD			
CONC. ROAD (PROP.)			
CONC. ROAD (EXIST.)			

Ward No:- 20

Slum Code:- 14

Slum Name:- Madhyapara

UNDER PRADHAN

MANTRI AWAS

YOJONA (PMAY)

PROPOSED LAND USE

AREA OF SLUM :

POPULATION :

CLIENT :NEW BARRACKPORE MUNICIPALITY



LEGEND

ITEMS	SEMI PUCCA	KUCHHA	
	SYMBOL	SYMBOL	QTY
DWELLINGHOUSE(NOS)			3
BLACK TOPPED ROAD			
CONC. ROAD (PROP.)			
CONC. ROAD (EXIST.)			

Ward No:-20

Slum Code:- 13

Slum Name:-FateshaBustee-2

UNDER PRADHAN

MANTRI AWAS YOJONA (PMAY)

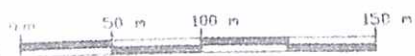
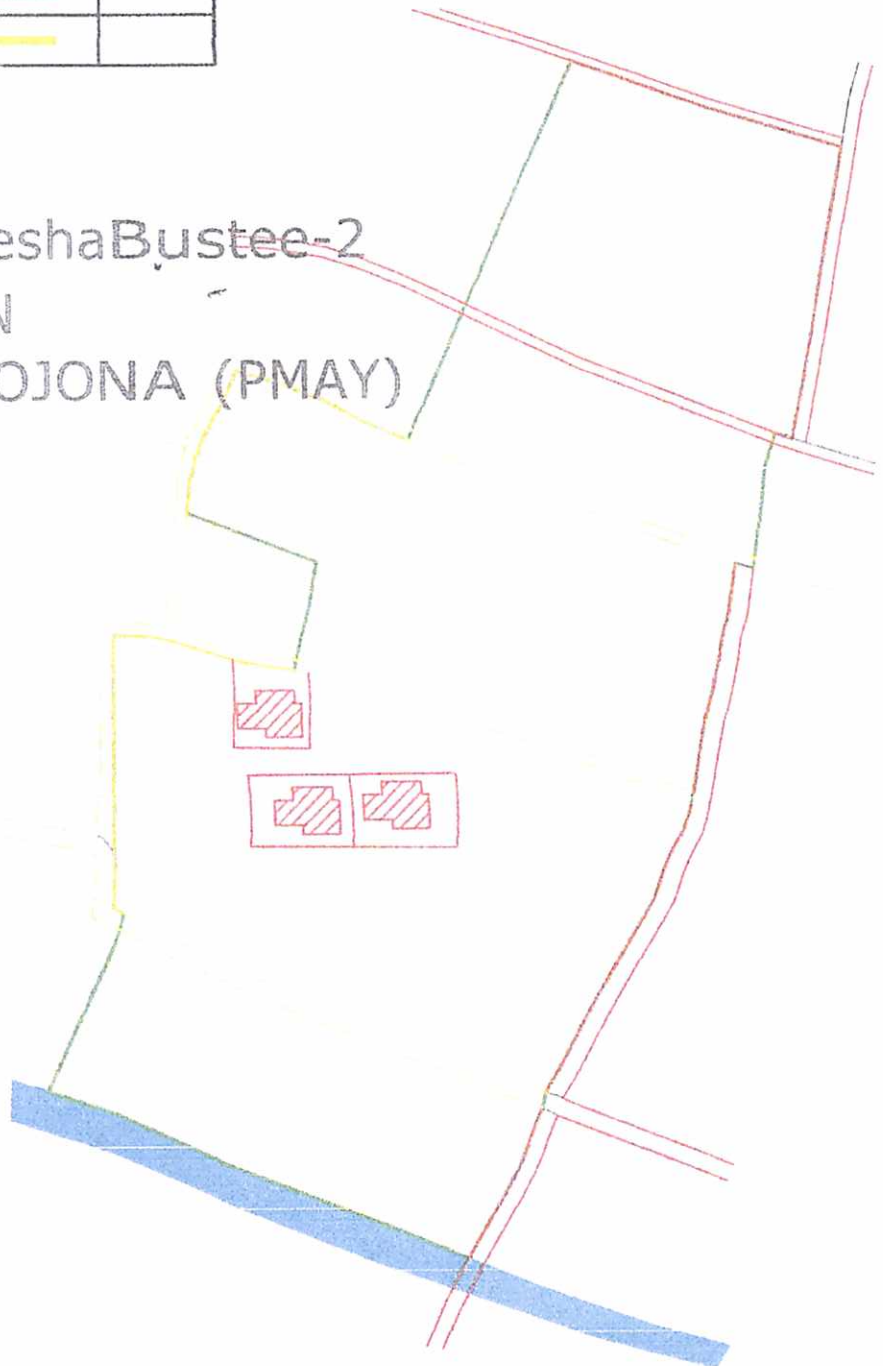

PROPOSED LAND USE

AREA OF SLUM :

POPULATION :

CLIENT : NEW BARRACKPORE MUNICIPALITY

LEGEND

ITEMS	SEMI PUCCA		KUCHHA
	SYMBOL	SYMBOL	
DWELLINGHOUSE(NOS)			3
BLACK TOPPED ROAD			
CONC. ROAD (PROP.)			
CONC. ROAD (EXIST.)			



Ward No:- 20

Slum Code:- 11

Slum Name:- Chasipara No. 3

(PMAY)

UNDER PRADHAN MANTRI AWAS YOJONA

Ward No:- 20

Slum Code:- 10

Slum Name:- Chasipara No. 1
UNDER PRADHAN MANTRI AWAS
YOJONA (PMAY)



PROPOSED LAND USE

AREA OF SLUM :

POPULATION :

CLIENT :NEW BARRACKPORE MUNICIPALITY

LEGEND

ITEMS	SEMI PUCCA		KUCHHA	
	SYMBOL	SYMBOL	SYMBOL	QTY
DWELLINGHOUSE(NOS)				3
BLACK TOPPED ROAD				
CONC. ROAD (PROP.)				
CONC. ROAD (EXIST.)				

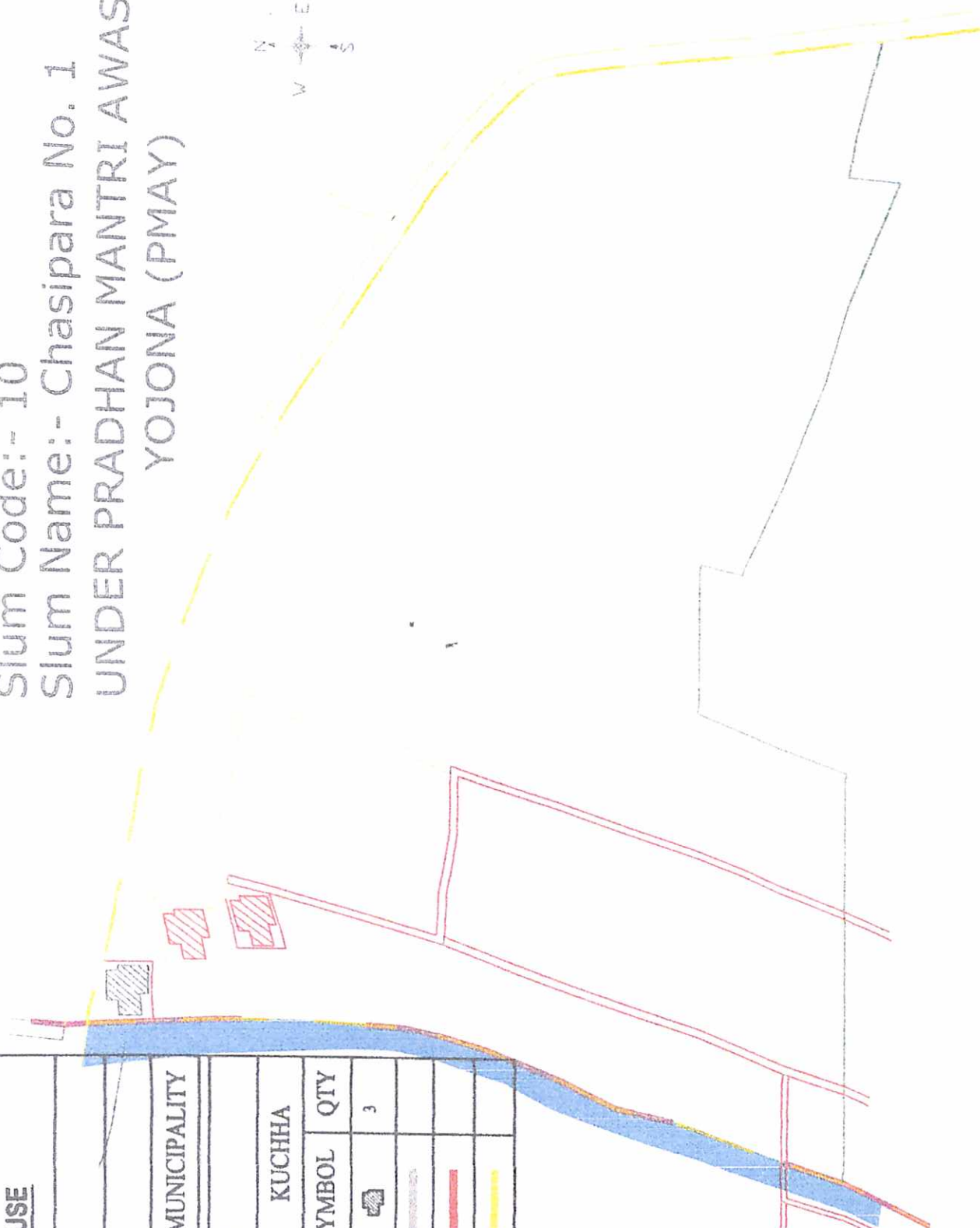

Ward No:- 19

Slum Code:- 16

Slum Name:- Bansbagan No. 2







UNDER PRADHAN MANTRI

AWAS YOJONA (PMAY)

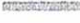

<u>PROPOSED LAND USE</u>			
AREA OF SLUM :			
POPULATION :			
CLIENT :NEW BARRACKPORE MUNICIPALITY			
<u>LEGEND</u>			
ITEMS	SEMI PUCCA	KUCHHA	QTY
	SYMBOL	SYMBOL	
DWELLINGHOUSE(NOS)			3
BLACK TOPPED ROAD			
CONC. ROAD (PROP.)			
CONC. ROAD (EXIST.)			

Ward No:- 18
 Slum Code:- 21
 Slum Name:- Talpukurpara
 UNDER PRADHAN MANTRI
 AWAS YOJONA (PMAY)

PROPOSED LAND USE			
AREA OF SLUM :			
POPULATION :			
CLIENT :NEW BARRACKPORE MUNICIPALITY			
LEGEND			
ITEMS	SEMI PUCCA	KUCHHA	
	SYMBOL	SYMBOL	QTY
DWELLINGHOUSE(NOS)			4
BLACK TOPPED ROAD			
CONC. ROAD (PROP.)			
CONC. ROAD (EXIST.)			

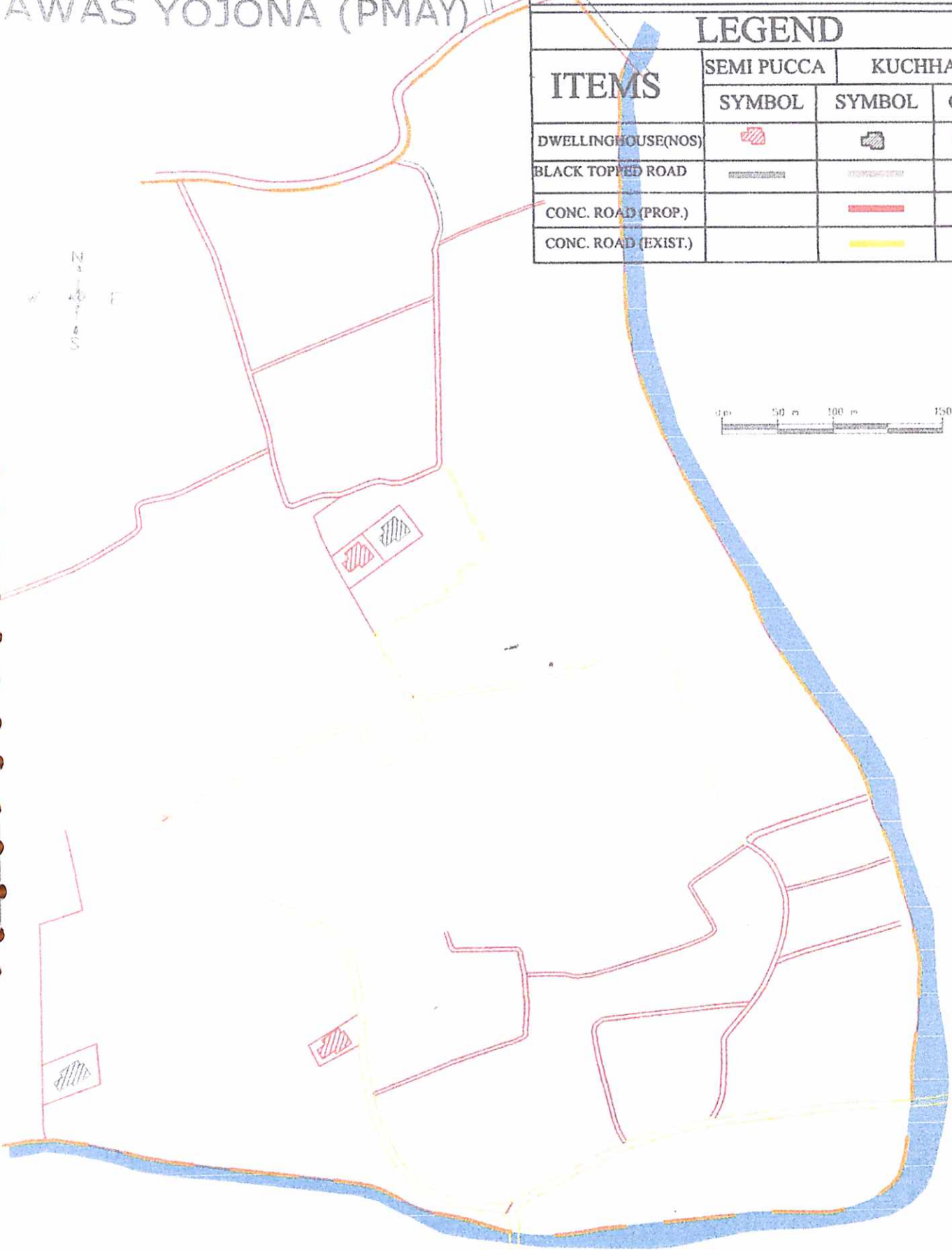

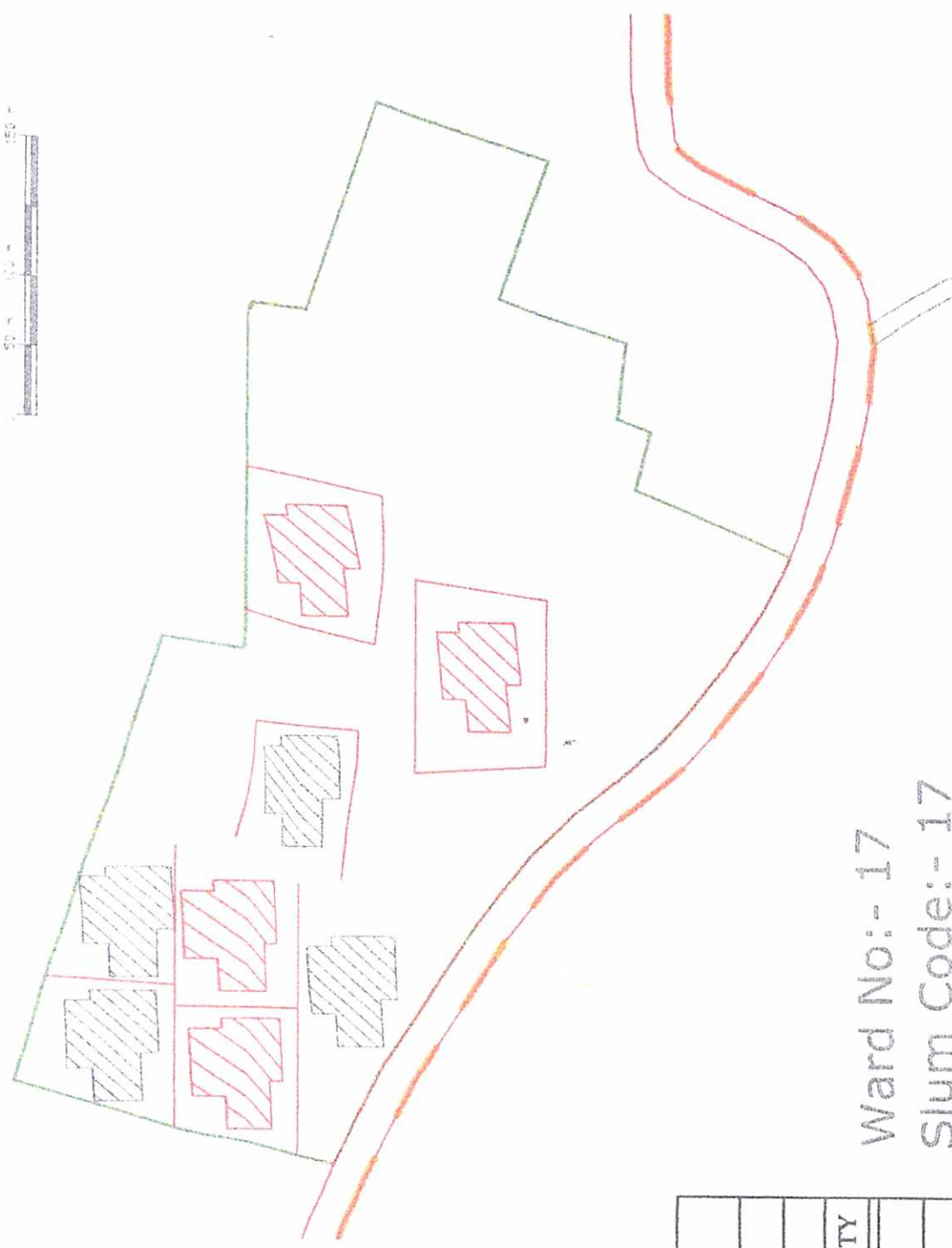
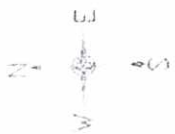

Ward No:- 17
 Slum Code:- 17
 Slum Name:- Lichubagan Bustee
 UNDER PRADHAN MANTRI AWAS YOJONA (PMAY)

PROPOSED LAND USE			
AREA OF SLUM :			
POPULATION :			
CLIENT :NEW BARRACKPORE MUNICIPALITY			
LEGEND			
ITEMS	SEMI PUCCA	KUCHHA	QTY
	SYMBOL	SYMBOL	
DWELLINGHOUSE(NOS)			8
BLACK TOPPED ROAD			
CONC. ROAD (PROP.)			
CONC. ROAD (EXIST.)			